

FEB 24 1998

SECTION

LAND CORNER RECORDATION CERTIFICATE
Filing Requirement of Act 74, Mich. P.A. 1970

9-
FILED

For corners in

<u>LIVINGSTON</u> (County)	Located in: TYRONE TWP.	Corner Code #/
1. Public Land Survey	T <u>4N</u> R <u>6E</u>	<u>M-8</u>
	T _____ R _____	_____
	T _____ R _____	_____
	T _____ R _____	_____
2. Property Controlling in Section	S _____ T _____ R _____	_____
	S _____ T _____ R _____	_____
3. Miscellaneous Property in Sec.	S _____ T _____ R _____	_____
	S _____ T _____ R _____	_____

1997 OCT -7 A 10: 56

NANCY HAVILAND
REGISTER OF DEEDS
LIVINGSTON COUNTY, MI.
48843

L.S.C.#715m

Register of Deeds Stamp & File Number

- 4. Lot No. _____, Recorded Plat _____
- 5. Private Claims _____

	A	B	C	D	E	F	G	H	I	J	K	L	M
2	6	5	4	3	2	1							
3													
4	7	8	9	10	11	12							
5													
6	18	17	16	15	14	13							
7													
8	19	20	21	22	23	24							
9													
10	30	29	28	27	26	25							
11													
12	31	32	33	34	35	36							
13													

I, BRYAN L. BOSS, in a field survey on SEPTEMBER 19, 19 97
do hereby certify that under requirements of P.A. 74, Michigan P.A. of 1970, the corner points mentioned in lines 1 and 2 above were in conformance with regulations and rules therefore as required in the current manual of survey instructions of the United States Department of the Interior, Bureau of Land Management or by a decree of a Court of Law and/or that the corner points mentioned in lines 3, 4 and 5 above were in conformance with the rules of the Michigan Board of Land Surveyors or by a Decree of a Court of Law; established, re-established, monumented, re-monumented, recovered, found as expressed below:

NOTE: Not more than 4 corners, all in the same town and range, may be recorded on this certificate.

A. Description of original monument and accessories and/or subsequent restoration:

BLACK OAK 8" N 22 E 7 LINKS
WHITE OAK 6" S 19 W 7 LINKS

B. Description of corner evidence found and/or method applied in restoring or reestablishing corner:

FOUND DAMAGED CAPPED IRON 8 FEET ± WEST OF CENTERLINE TIPSICO LAKE ROAD. (GRAVEL)

PA. 345 1890, APPROVED BY LIVINGSTON COUNTY
PEER GROUP ON 6-8-97 CO. REP JED

C. Description of monument for corner and accessories established to perpetuate localing the position of the corner:

SET 1 1/4" X 30" IRON PIPE ONE FOOT BELOW GRAVEL SURFACE WITH
1 1/4" X 6" BREAKAWAY & BRASS CAP STAMPED "LIVINGSTON COUNTY
MONUMENTATION CORNER".
N 80 E 25.31' NAIL & TAG NORTH SIDE 32" OAK
S 35 E 41.41' NAIL & TAG SOUTHWEST SIDE 36" OAK
N 85 W 32.02' CENTER OF STEEL FENCE POST
N 80 W 16.01' NAIL & TAG NORT SIDE 10" ELM

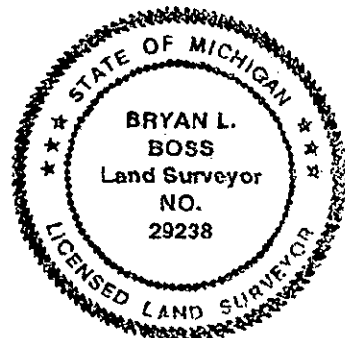

Signed by [Signature]
Surveyor's Michigan License No. 29238

Date Sept. 22, 1997

SUMMARY

M-8

(REV. June 11, 1997)

East 1/4 Corner, Section 24, Tyrone Township, Livingston County, Michigan.

Corner set by Alex Holmes in 1815. No witnesses found in old county records for Section 24. However the G.L.O. Map records 109.9 foot jog at M-8 and A-8.

On November 26, 1930, Maurice Baldwin set iron pipe midway between fences when he found nothing at the West 1/4 corner, Section 19, Rose Township. There was no reference to Township jog.. On July 8, 1977, Richard L. Smith again set 1/2 inch iron bar with cap at the West 1/4 corner, Section 19, Rose Township and again makes no reference to the East 1/4 Corner, Section 24, Tyrone Township. In 1979, Grant Ward, and in 1987, Delta Land Surveying, both witness West 1/4 corner, Section 19, Rose Township, and do not reference Township jog (witnesses for A-8 agree).

On August 1, 1988, Giffels-Webster set iron rod and cap #26459 at East 1/4 corner of Section 24, see page 15 this dossier. The township jog was recorded at 118.94 feet by this survey. On December 27, 1996 and May 5, 1997, Boss Engineering made clean sweep 1½ - 3 feet ± North of A-8 and 3 feet ± South of M-8 for additional corners. None found.

WITNESSES

On September 23, 1993, James H. Miller of Sheridan Surveying Company found and witnessed same corner. Boss verified Dec. 1996.

M-8 is 8 feet ± West of centerline Tipsico Lake Road and will make it difficult for G.P.S.

RECOMMENDATIONS

We disagree with the method used by Giffels-Webster to set M-8.(see pg. 15, this dossier).

We recommend setting M-8, E 1/4 Cor, Sec. 24, Tyrone Twp. at midpoint between M-7/M-9 S 02-38-41 W 5322.12 feet (2661.06/2661.06).

Jog with A-8 Rose will be S 02-28-41 W, 120.36 and S 87-20 E, 2.23 from Boss proposed M-8. Existing (G/W) Found M-8 will be South 1.38 and East 2.12 from Boss proposed M-8.

The Boss proposal was tentatively approved by Peer Group 5/21/97 subject to sending a registered letter to Sheridan Surveying.

June 4, 1997 Peer Group Meeting Sheridan was in attendance and Peer Group decision was to table the corner for further review by the Remonumentation Contractor. It seemed that the Peer Group would like Boss to reconsider and recommend the existing point set by Giffels/Webster.

Accepted Corner as found.

File: Summ-8

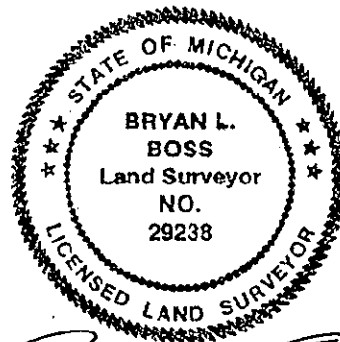

Bryan L. Boss