

FEB 24 1998

**SECTION**

**LAND CORNER RECORDATION CERTIFICATE**  
Filing Requirement of Act 74, Mich. P.A. 1970

9-  
**FILED**

For corners in

<u>LIVINGSTON</u> (County)	Located In: TYRONE TWP.	Corner Code #/1 M-9
1. Public Land Survey	T <u>4N</u> R <u>6E</u>	<u>M-9</u>
	T _____ R _____	_____
	T _____ R _____	_____
	T _____ R _____	_____
2. Property Controlling in Section	S _____ T _____ R _____	_____
	S _____ T _____ R _____	_____
3. Miscellaneous Property in Sec.	S _____ T _____ R _____	_____
	S _____ T _____ R _____	_____

1997 OCT -7 A 10: 56

NANCY HAVILAND  
REGISTER OF DEEDS  
LIVINGSTON COUNTY, MI.  
48843

L.S.C.#716m

Register of Deeds Stamp & File Number

4. Lot No. \_\_\_\_\_, Recorded Plat \_\_\_\_\_  
5. Private Claims \_\_\_\_\_

A	B	C	D	E	F	G	H	I	J	K	L	M
2	6	5	4	3	2	1						
3												
4	7	8	9	10	11	12						
5												
6	18	17	16	15	14	13						
7												
8	19	20	21	22	23	24						
9												
10	30	29	28	27	26	25						
11												
12	31	32	33	34	35	36						
13												

I, BRYAN L. BOSS, in a field survey on SEPTEMBER 18, 19 97, do hereby certify that under requirements of P.A. 74, Michigan P.A. of 1970, the corner points mentioned in lines 1 and 2 above were in conformance with regulations and rules therefore as required in the current manual of survey instructions of the United States Department of the Interior, Bureau of Land Management or by a decree of a Court of Law and/or that the corner points mentioned in lines 3, 4 and 5 above were in conformance with the rules of the Michigan Board of Land Surveyors or by a Decree of a Court of Law; established, re-established, monumented, re-monumented, recovered, found as expressed below:

NOTE: Not more than 4 corners, all in the same town and range, may be recorded on this certificate.

A. Description of original monument and accessories and/or subsequent restoration:

WHITE OAK 8" N 04 E 17 LINKS  
WHITE OAK 8" N 78 W 37 LINKS

B. Description of corner evidence found and/or method applied in restoring or reestablishing corner:

FOUND 3/4" INCH PIPE ONE FOOT± BELOW GRAVEL SURFACE, THREE FEET± SOUTH OF CENTERLINE ROHN ROAD AND TWO FEET± WEST OF CENTERLINE TIPSICO LAKE ROAD.

PA. 345 1990, APPROVED BY LIVINGSTON COUNTY  
PEER GROUP ON 5-21-97 CO. REP JED

C. Description of monument for corner and accessories established to perpetuate locating the position of the corner:

SET 1 1/4" INCH X 30" PIPE ONE FOOT BELOW SURFACE WITH A 6" BREAKAWAY & BRASS CAP STAMPED "LIVINGSTON COUNTY MONUMENTATION CORNER"  
N 25 E 41.87' NAIL & TAG WEST SIDE 14" OAK  
N 30 E 36.47' NAIL & TAG WEST SIDE 8" TWIN CHERRY  
S 30 E 29.08' NAIL & TAG WEST SIDE 12" CHERRY  
S 45 W 29.85' NAIL & TAG NORTHWEST SIDE 24" TWIN OAK  
N 25 W 42.80' NAIL & TAG EAST SIDE 30" OAK

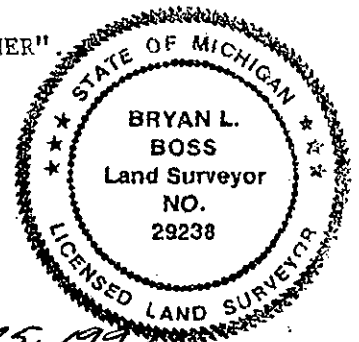

Signed by Bryan L. Boss

Date Sept. 25, 1997

Surveyor's Michigan License No. 29238

**SUMMARY  
M-9**

Northeast Corner, Section 25, Tyrone Township, Livingston County, Michigan.

G.L.O. notes record Alex Holmes set corner in 1815. The G.L.O. Map also records jog at A-9 and M-9 distant 104.28 feet. No witnesses were found in Section 24 or 25 field book. The 1930 survey by Maurice Baldwin records witnesses to A-9, but makes no reference to M-9. In 1977, Richard L. Smith surveyed West line of Section 19, Rose Township and again no record of Tyrone Township corners. On January 21, 1979, Christopher Newman recorded Act 74 and found a 1 inch pipe at M-9. Giffels-Webster survey on August 1, 1988 recorded found iron and witnesses checked Chris Newman.

**DISTANCES**

Grant Ward surveyed West line of Section 19, Rose Township and was in agreement with Richard L. Smith's previous survey (note Ward survey references M-9). Giffels-Webster and Boss Engineering were also in agreement on measurement from Northeast corner Section 25 to the East 1/4 corner of Section 24.

**WITNESSES**

On December 19, 1996 Boss Engineering found 3/4 inch pipe 1 foot ± deep, 2 feet ± West of centerline of Tipsico Lake Road, and 3 feet ± South of the centerline of Rohn Road. Witness by Boss Engineering on December 19, 1996, coincide with Charles Garlock's September 27, 1968 ; Newman, 1979 ; and Giffels-Webster, 1988.

Many over hanging branches will not be conducive for G.P.S.

We recommend acceptance of 1 inch pipe found by Boss as M-9, Northeast corner, Section 25, Tyrone Township.

File: Summ-9

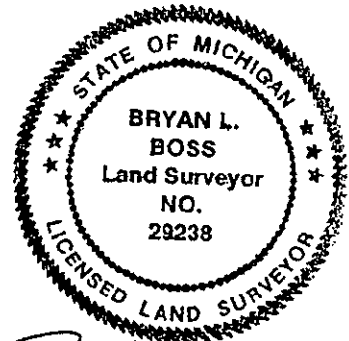

*Bryan L. Boss*