

**SURVEY & REMONUMENTATION**

MAR 13 1998

**SECTION**

1997 Mackinac County Remonumentation Corner  
**LAND CORNER RECORDATION CERTIFICATE**  
 Filing Requirement of Act 74, Mich. P.A. 1970

For corners in

Mackinac  
 (County)

Located In:

Corner Code #

1. Public Land Survey

T42NR 1W

M-10

T42NR 1E

A-10 ✓

T R

T R

2. Property Controlling in Section

S

T R

3. Miscellaneous Property in Sec.

S

T R

S

T R

S

T R

4. Lot No. \_\_\_\_\_, Recorded Plat \_\_\_\_\_

5. Private Claims \_\_\_\_\_

RECEIVED & FILED  
 DIANE FRANKEN  
 MACKINAC COUNTY REGISTER OF DEEDS  
 DEC 31 1997  
 AM \_\_\_\_\_ PM \_\_\_\_\_  
 (1819) (1819) (1819) (1819) (1819)  
 Register of Deeds Stamp & File Number

	A	B	C	D	E	F	G	H	I	J	K	L	M
1													
2	6		5		4		3		2		1		
3													
4	7		8		9		10		11		12		
5													
6	18		17		16		15		14		13		
7													
8	19		20		21		22		23		24		
9													
10	30		29		28		27		26		25		
11													
12	31		32		33		34		35		36		
13													

I, David B. Guthrie, in a field survey on Dec. 17, 1997 do hereby state that under requirements of P.A. 74, Michigan P.A. of 1970, the corner points mentioned in lines 1 and 2 above were in conformance with regulations and rules therefore as required in the current manual of survey instructions of the United States Department of the Interior, Bureau of Land Management or by a decree of a Court of Law and/or that the corner points mentioned in lines 3, 4 and 5 above were in conformance with the rules of the Michigan Board of Land Surveyors or by a Decree of a Court of Law; established, re-established, monumented, recovered, found as expressed below:

NOTE: Not more than 2 corners, all in the same town and range, may be recorded on this certificate.

A. Description of original monument and accessories and/or subsequent restoration:

- 1840: G.L.O. Survey by Wm. A. Burt - Set Post and Referenced
  - 1973: Survey by MDOT - Found 1/2" rod
  - 1980: Survey by Lawrence R. Fientdt - Found 1/2" solid rod
  - 1991: Survey by Ronald Bischer - iron pin
  - 1992: Survey by Neil E. Hill - Found 1/2" rod in Monument Box.
- Liber D Page 134

B. Description of corner evidence found and/or method applied in restoring or reestablishing corner:

1997: Remonumentation survey by R.S. Scott Associates, Inc.  
 Found 1/2" Iron Rod.  
 This corner position is compatible with County and local surveys. This corner position is accepted as a careful and faithful perpetuation of the position of the original corner.

ACCEPTED BY THE MACKINAC COUNTY  
 SURVEY PEER GROUP AS THE  
 OFFICIAL CORNER UNDER P.A.  
 345 OF 1990 AT A MEETING  
 HELD ON 12-19-97

C. Description of monument for corner and accessories established to perpetuate locating the position of the corner:

1997: Placed 3" Mackinac County Cap stamped to identify the corner over 1/2" Iron Rod in Monument Box.  
 Referenced -  
 (Exist.) Tag#3920 - S60°E - 79.70' - P.P.  
 (Exist.) MDSH Tag - S60°E - 80.09' - P.P.  
 (Exist.) Tag#3920 - S70°W - 94.20' - P.P.  
 (Exist.) MDSH Tag - S68°W - 94.65' - P.P.  
 (Exist.) USGS B.M. Monument - N65°W - 77.50' - Conc. Mon.  
 N89°E - 75.26' - 12" Red Pine

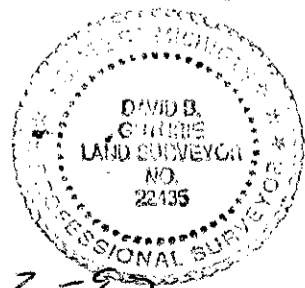

Signed by D.B. Guthrie

Surveyor's Michigan License No. 22435

Date: 12-22-97