

MICHIGAN
DEPARTMENT OF CONSERVATION
FORESTRY DIVISION

LAND CORNER RECORD

T. 42N N. R. 1N

Mackinac COUNTY

DESCRIPTION OF CORNER Sec. Cor. common to Secs. 22-23-26-27

CORNER MONUMENT 1" pipe with 4" aluminum cap

DATE MONUMENT PLACED AND WITNESSED 5-21-70

WITNESSES TO CORNER..... 12" Cedar (S22 NBT) N60°W 21.8'

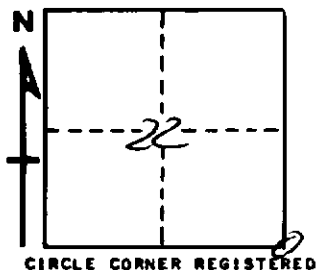

8" Cedar (S27 NBT) S44°W 15.9'

9" Cedar (S23 NBT) N89°E 23.0'

AND

DESCRIPTION IN DETAIL AS TO HOW CORNER WAS LOCATED AND IDENTIFIED OR RESTORED.

This corner re-established on line bet. Sec. Cor. one mile north and $\frac{1}{4}$ Cor. $\frac{1}{2}$ mile south, by single proportionate distance.

Found several cedar stumps chopped out at corner but no positive original evidence. Distance west to a pond checks with record.

Placed location poster on old log roads; $\frac{1}{2}$ ch. west and 1 ch. east of corner.

Found remains of an old log building (24' x 30') 23' east of corner.

Found no record of existing stream to south or to east of this corner.

SURVEYOR'S SEAL

SIGNED Billy D. Buckler
Billy D. Buckler
REGISTERED LAND SURVEYOR

DATE 8-4-70