

SURVEY & REMONUMENTATION

MAR 13 1998

SECTION

**1997 Mackinac County Remonumentation Corner
LAND CORNER RECORDATION CERTIFICATE
Filing Requirement of Act 74, Mich. P.A. 1970**

For corners in

<u>Mackinac</u> (County)	Located In:	Corner Code #
1. Public Land Survey	T <u>42NR 1W</u>	<u>C-2</u>
	T <u> </u> R <u> </u>	<u> </u>
	T <u> </u> R <u> </u>	<u> </u>
	T <u> </u> R <u> </u>	<u> </u>
2. Property Controlling in Section	S <u> </u> T <u> </u> R <u> </u>	<u> </u>
	S <u> </u> T <u> </u> R <u> </u>	<u> </u>
3. Miscellaneous Property in Sec.	S <u> </u> T <u> </u> R <u> </u>	<u> </u>
	S <u> </u> T <u> </u> R <u> </u>	<u> </u>

RECEIVED & FILED
DIANE FRANKOVICH
MACKINAC COUNTY REGISTER OF DEEDS

DEC 18 1997
AM PM
7|8|9|10|11|12|1|2|3|4|5|6

Register of Deeds Stamp & File Number

4. Lot No. _____, Recorded Plat _____
5. Private Claims _____

I, David B. Guthrie, in a field survey on July 18, 19 97 do hereby state that under requirements of P.A. 74, Michigan P.A. of 1970, the corner points mentioned in lines 1 and 2 above were in conformance with regulations and rules therefore as required in the current manual of survey instructions of the United States Department of the Interior, Bureau of Land Management or by a decree of a Court of Law and/or that the corner points mentioned in lines 3, 4 and 5 above were in conformance with the rules of the Michigan Board of Land Surveyors or by a Decree of a Court of Law, established, re-established, monumented, recovered, found as expressed below:

NOTE: Not more than 2 corners, all in the same town and range, may be recorded on this certificate.

	A	B	C	D	E	F	G	H	I	J	K	L	M
1													
2	6		5		4		3		2		1		
3													
4	7		8		9		10		11		12		
5													
6	18		17		16		15		14		13		
7													
8	19		20		21		22		23		24		
9													
10	30		29		28		27		26		25		
11													
12	31		32		33		34		35		36		
13													

- A. Description of original monument and accessories and/or subsequent restoration:
- 1840: G.L.O. Survey by J.H. Mullett - Set Post and Referenced -
Beech 10 / S86W / 25
Beech 8 / S28E / 14
 - 1975: Surveys by Thomas O'Brien - Fd. 1/2" Iron Rod - Certificates of Survey Recorded in Book 2, Page 186 and Book 2, Page 216.
 - 1986: Survey by Wm. Karr - Fd. 3/4" Iron Pipe - Certificate of Survey Recorded in L. 293, P. 342.

B. Description of corner evidence found and/or method applied in restoring or reestablishing corner:

ACCEPTED BY THE MACKINAC COUNTY SURVEY PEER GROUP AS THE OFFICIAL CORNER UNDER P.A. 345 OF 1990 AT A MEETING HELD ON 11-21-97

- 1997: Remonumentation Survey by R.S. Scott Associates, Inc.
Found 1/2" Iron Pipe.
Referenced -
S87°E - 8" Maple - 35.88'
S15°E - 8" Maple - 71.95'
S25°W - 10" Maple - 91.80'
N24°W - 6" Maple - 56.55'

This corner position is compatible with County and local surveys. This corner position is accepted as a careful and faithful perpetuation of the position of the original corner.

C. Description of monument for corner and accessories established to perpetuate locating the position of the corner:

- 1997: Placed 3" Mackinac County Cap stamped to identify the corner over 1/2" Iron Rod.
Referenced -
S87°E - 8" Maple - 35.88'
S15°E - 8" Maple - 71.95'
S25°W - 10" Maple - 91.80'
N24°W - 6" Maple - 56.55'

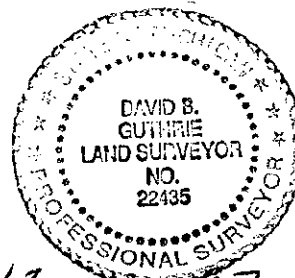

Signed by David B. Guthrie
Surveyor's Michigan License No. 22435

Date 12-18-97