

MAR 20 2000

LAND CORNER RECORDATION CERTIFICATE
Filing Requirement of Act 74, Mich. P.A. 1970

SECTION

Mackinac County Remonumentation Corner

For corners in

Mackinac County	Located in:	Corner Code #
1. Public Land Survey	T42N R01W	E-2
	T R	
	T R	
	T R	
2. Property Controlling in Section	S T R	
	S T R	
3. Miscellaneous Property in Sec.	S T R	
	S T R	
4. Lot No. , Recorded Plat		
5. Private Claims		

RECEIVED & FILED
DIANE FRANKOVICH
MACKINAC COUNTY REGISTRE OF DEEDS

FEB 25 2000

AM PM
7|8|9|10|11|12|1|2|3|4|5|6

Register of Deeds Stamp & File Number

	A	B	C	D	E	F	G	H	I	J	K	L	M
1													
2	6			5	●	4		3		2		1	
3													
4	7			8		9		10		11		12	
5													
6	18			17		16		15		14		13	
7													
8	19			20		21		22		23		24	
9													
10	30			29		28		27		26		25	
11													
12	31			32		33		34		35		36	
13													

I, Neil E. Hill, in a field survey on 12-20-99, do hereby state that under requirements of P.A. 74, Michigan P.A. of 1970, the corner points mentioned in lines 1 and 2 above were in conformance with regulations and rules therefore as required in the current manual of survey instructions of the United States Department of the Interior, Bureau of Land Management or by a decree of a Court of Law and /or that the corner points mentioned in lines 3, 4 and 5 above were in conformance with the rules of the Michigan Board of Land Surveyors or by a Decree of a Court of Law; established, re-established, monumented, recovered, found as expressed below:

NOTE: Not more than 2 corners, all in the same town and range, may be recorded on this certificate.

A. Description of original monument and accessories and/or subsequent restoration:

1845 GLO Notes J Mullett	10" Sugar for 1/4 Post			
1984 William Karr	4" Maple	N 72 E	20.40'	
Fd 3/4" Pipe	6" Ironwood	S 33 E	14.14'	
Accepted corner location	10" Maple	S 26 W	5.69'	
Liber C Page 043	8" Maple	N 34 W	7.87'	

ACCEPTED BY THE MACKINAC COUNTY
SURVEY PEER GROUP AS THE
OFFICIAL CORNER UNDER P.A.
345 OF 1990 AT A MEETING
HELD ON 11-05-99
Neil E. Hill

No Subsequent Information

B. Description of corner evidence found and/or method applied in restoring or reestablishing corner:

1999 Fd Corner and 2 witnesses
Accepted corner location
Placed 4" Alum. remonumentation cap

C. Description of monument for corner and accessories established to perpetuate locating the position of the corner:

Corner is a 3/4" pipe with 4" Alum. remonumentation cap
Corner is on the west side of a N-S trail, approx 20' South of an E-W trail

11" Maple	S 25 W	5.62'
9" Maple	N 35 W	7.91'
8" Maple	S 40 E	23.50'
16" Maple	N 20 E	46.80'

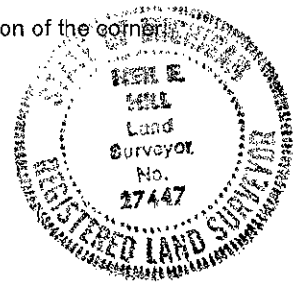

Bearings are compass bearings, corrected for declination, all distances are to a double-head nail in the side of the witness object unless otherwise noted.

Signed by Neil E. Hill P.S.P.C.

Date January 21 2000

Surveyor's Michigan License No. 27447

E-00379