

**LAND CORNER RECORDATION CERTIFICATE**  
**Filing Requirement of Act 74, Mich. P.A. 1970**

For corners in

Mackinac

(County)

Located In:

Corner Code #

1. Public Land Survey	T	42N	R	12W	811
	T	42N	R	12W	C12
	T		R		
	T		R		
2. Property Controlling in Section	S		T	R	
	S		T	R	
3. Miscellaneous	S		T	R	
Property in Sec.	S		T	R	

Register of Deeds Stamp & File Number

4. Lot No. \_\_\_\_\_, Recorded Plat \_\_\_\_\_  
 5. Private Claims \_\_\_\_\_

C12 Apr 25 2006  
 811 Apr 24 2006

I, Stephan J. Szyszkoski, in a field survey on \_\_\_\_\_, 19\_\_\_\_ do hereby state that under requirements of P.A. 74, Michigan P.A. of 1970, the corner points mentioned in lines 1 and 2 above were in conformance with regulations and rules therefore as required in the current manual of survey instructions of the United States Department of the Interior, Bureau of Land Management or by a decree of a Court of Law and/or that the corner points mentioned in lines 3, 4 and 5 above were in conformance with the rules of the Michigan Board of Land Surveyors or by a Decree of a Court of Law; established, re-established, monumented, recovered, found as expressed below:

**NOTE:** Not more than 2 corners, all in the same town and range, may be recorded on this certificate.

1	A	B	C	D	E	F	G	H	I	J	K	L	M
2		6		5		4		3		2		1	
3													
4		7		8		9		10		11		12	
5													
6		18		17		16		15		14		13	
7													
8		19		20		21		22		23		24	
9													
10		30		29		28		27		26		25	
11													
12		31		32		33		34		35		36	
13													

**A. Description of original monument and accessories and/or subsequent restoration:**

(811) Quarter corner common to Sections 30 and 31. 1849 - Established by Guy Carleton, US Deputy Surveyor: East corrected between Sections 30 & 31 ...41.90 Set post for 1/4 Section corner. Beech 12 N25E 19 links, Sugar 12 S67W 28 links. ...81.90 Section corner. Found no subsequent record.

(C12) Quarter corner common to Sections 31 and 32. 1849 - Established by Guy Carleton, US Deputy Surveyor: North between Sections 31 & 32 ...40.00 Set post for 1/4 section corner. Beech 12 East 15 links, Beech 6 S75W 11 links. ...80.00 Set post for corner to Sections 29,30,31 & 32. Found no subsequent record.

**B. Description of corner evidence found and/or method applied in restoring or reestablishing corner:**

(811) The original post and accessories were not recovered. Found no evidence of the position of the original corner on the ground. Reestablished the corner by single proportionate measurement to the original record and on the section line between Section corners of record 2773.33' West and 2647.57' East.

(C12) the original post and accessories were not recovered. Found no evidence of the position of the original corner on the ground. Reestablished the corner by single proportionate measurement to the original record and on the section line between Section corners of record, 2691.04' north and south, both being perpetuations of the positions of the original corners.

**C. Description of monument for corner and accessories established to perpetuate locating the position of the corner:**

(811) Set 1"IDx36" I.pipe with 4" alum. MDNR cap. Set measuring nails in:  
 6" Balsam N80E 15.5' mrkd "1/4S NBT"  
 19" Hemlock N45W 71.05' do  
 14" Hemlock S75W 62.85' do  
 21" Hemlock S22E 65.35' do

Bearings are magnetic. Distances are to nail with tag.

(C12) Set 1"IDx36" I.pipe with 4" alum. MDNR cap. Set measuring nails in:  
 11" Sugar S82E 11.15' mrkd "1/4S NBT"  
 9" Sugar N51E 18.65' do  
 14" Sugar N70W 27.25' do  
 14" Sugar S29W 70.8' do

Bearings are magnetic. Distances are to nail with tag.

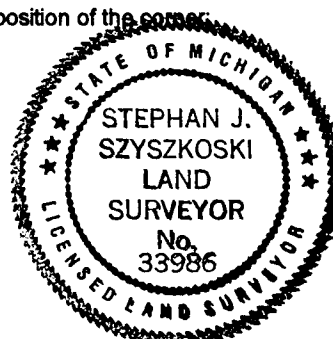

Signed by Stephan J. Szyszkoski  
 Surveyor's Michigan License No. 33986

Date 8/9/06