

MAY 20 1997

MACKINAC COUNTY REMONUMENTATION CORNER

COMMISSION

LAND CORNER RECORDATION CERTIFICATE
Filing Requirement of Act 74, Mich. P.A. 1970

For corners in
MACKINAC

_____	Located In:	Corner Code #
(County)		
1. Public Land Survey	T <u>43N</u> R <u>12W</u>	<u>M-3</u>
	T _____ R _____	_____
	T _____ R _____	_____
	T _____ R _____	_____
2. Property Controlling in Section	S _____ T _____ R _____	_____
	S _____ T _____ R _____	_____
3. Miscellaneous Property in Sec.	S _____ T _____ R _____	_____
	S _____ T _____ R _____	_____

RECEIVED & FILED
 DIANE FRANKOVICH
 MACKINAC COUNTY REGISTER OF DEEDS
 NOV 15 1996
 AM _____ PM _____
 7|8|9|10|11|12|1|2|3|4|5|6
 Register of Deeds Stamp & File Number

4. Lot No. _____, Recorded Plat _____
 5. Private Claims _____

I, JAMES H. GRANGER, in a field survey on AUGUST 28, 19 96
 do hereby state that under requirements of P.A. 74, Michigan P.A. of 1970, the corner points
 mentioned in lines 1 and 2 above were in conformance with regulations and rules therefore as
 required in the current manual of survey instructions of the United States Department of the Interior,
 Bureau of Land Management or by a decree of a Court of Law and /or that the corner points
 mentioned in lines 3, 4 and 5 above were in conformance with the rules of the Michigan Board of
 Land Surveyors or by a Decree of a Court of Law; established, re-established, monumented,
 recovered, found as expressed below:

NOTE: Not more than 2 corners, all in the same town and range, may be recorded
 on this certificate.

	A	B	C	D	E	F	G	H	I	J	K	L	P
1													
2		6		5		4		3		2		1	
3													
4		7		8		9		10		11		12	
5													
6		18		17		16		15		14		13	
7													
8		19		20		21		22		23		24	
9													
10		30		29		28		27		26		25	
11													
12		31		32		33		34		35		36	
13													

A. Description of original monument and accessories and/or subsequent restoration:

- 1841 - Original Survey Set wood post 10" Sugar S37°E 12 lks
W. Burt 8" Ironwood N42°W 37 lks
- 1961 - Survey Steel pin
Franklyn Burgess # 2531
- 1974 - LCRC Steel pin
Jerry Wilcox # 14102
- 1993 - LCRC Steel pin

B. Description of corner evidence found and/or method applied in restoring or reestablishing corner:

Found 1/2" iron with cap # 31591 in monument box and three witnesses.

ACCEPTED BY THE MACKINAC COUNTY
 SURVEY PEER GROUP AS THE
 OFFICIAL CORNER UNDER P.A.
 345 OF 1990 AT A MEETING
 HELDON 8-20-96

C. Description of monument for corner and accessories established to perpetuate locating the position of the corner

also corner **A-3, T43N, R11W**

Set 5/8" X 30" rebar with Remonumentation Cap in Monument box

- Power Pole N44°E 72.35' Fd. tag #31591
- 6" Maple N70°E 33.43' Set tag
- 10" Maple S30°E 85.56' Fd. tag #31591
- 10" Maple WEST 44.78' Fd. tag #31591

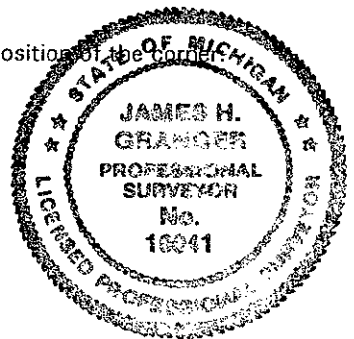

Signed by James H. Granger
 Surveyor's Michigan License No. 16041

Date 10-10-96

E 0109