

STATE OF MICHIGAN
DEPARTMENT
OF
NATURAL RESOURCES

LAND CORNER RECORD

Mackinac COUNTY
T 44N R 9W

DESCRIPTION OF CORNER Sec. Cor. common to Secs. 26-27-34-35

CORNER MONUMENT 1" pipe with 4" aluminum cap.

DATE MONUMENT PLACED AND WITNESSED 8-26-68

WITNESSES TO CORNER..... 6" Jack Pine (S34 NBT) S39°W 19.3'

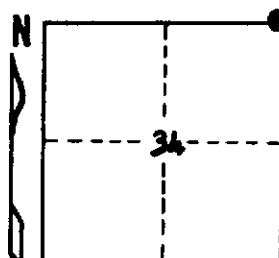

9" W. Pine (S27 NBT) N52°W 49.2'

AND

CIRCLE CORNER REGISTERED

DESCRIPTION IN DETAIL AS TO HOW CORNER WAS LOCATED AND IDENTIFIED OR RESTORED.

This corner replaced at iron pipe in N-S fence line. Believe corner to have been set by Marcus Schaaf, R.L.S. in 1935. Found iron fence post at corner. Cor. lies 20' west of old road.

SURVEYOR'S SEAL

SIGNED

Billy D. Buckler
Billie D. Buckler
REGISTERED LAND SURVEYOR

DATE

3-17-69

DISTRIBUTION:

County Courthouse
Area Forester (Regions I & II)
District or Region Surveyor
Forestry Div., Lansing