

LAND CORNER RECORDATION CERTIFICATE
Filing Requirement of Act 74, Mich. P.A. 1970

MAR 17 2000

For corners in

SECTION

1169
LIBER 9275 PAGE 520
01/04/2000 09:29:18 A.M.
MACOMB COUNTY, MI
CARMELLA SABAUGH, REG/DEEDS

Register of Deeds Stamp & File Number

Table with columns: Macomb (County), Located In: Erin Twp., Corner Code #. Rows include Public Land Survey, Property Controlling in Section, and Miscellaneous Property in Sec.

4. Lot No. , Recorded Plat
5. Private Claims

I, Michael S. Hoben, in a field survey on June 18, 1999 do hereby state that under requirements of P.A. 74, Michigan P.A. of 1970, the corner points mentioned in lines 1 and 2 above were in conformance with regulations and rules therefore as required in the current manual of survey instructions of the United States Department of the Interior, Bureau of Land Management or by a decree of a Court of Law and /or that the corner points mentioned in lines 3, 4 and 5 above were in conformance with the rules of the Michigan Board of Land Surveyors or by a Decree of a Court of Law; established, re-established, monumented, recovered, found as expressed below:

NOTE: Not more than 2 corners, all in the same town and range, may be recorded on this certificate.

A. Description of original monument and accessories and/or subsequent restoration

Table with columns: I-01 1817 GLO Notes, Wampler, Post. Includes entries for 'Fair Gardens', 'Grosse Point Lakeside Farms', 'Retty Heights Sub.', etc.

B. Description of corner evidence found and/or method applied in restoring or reestablishing corner:

I-01 I found a 1/2" rebar in a mon. box 10' south of the centerline of 14 Mile Road (conc.) at the centerline of Lipke Road (conc.). Lot irons in "Retty Heights Sub" and Assessors Plat No. 74 agree with the found corner at I-01. This is a common corner with I-13 (T.2N.,R.13E.) Clinton Township. "Fair Gardens Plat" (1919) record dimension from I-13 to I-12 = 2694.2' (meas. 2694.43') (R 2649' GLO) "Clinton West Industrial Park" record dimension from I-13 to I-12 = 2694.20' (meas. 2694.43') (R 2640' GLO) By description in Clinton Twp. from I-13 to H-13 (R. 2689.14') (M. 2689.63') (R 2640' GLO) From I-13 Clinton Twp. (I-10 Erin Twp.) to I-02 (Erin Twp.) (R. 2689.39') (M. 2689.43') (R 2640' GLO) L.C.R.C. L.7288, P124 NW 72.86' E face of a 20" diameter billboard sign pole (m. 73.24) SE 35.45' Found PK nail in E side of Power Pole (m. 35.45') SW 30.90' Drill hole at the NW corner of 2'x3' concrete base to meter station (m. 31.00') NE 62.75' PK nail in the SE side of light pole (m. 62.71') M.C.R.C. witnesses North 32.68' drill hole at the SE corner of 2'x3' concrete base to meter station (m. 31.00')

C. Description of monument for corner and accessories established to perpetuate locating the position of the corner:

I-01 I placed a 2" diameter aluminum cap stamped "Macomb County Monument MI Act 345 #35994" on the found iron in an exist monument box. N 57° E 62.71' Found PK nail S. E. side light pole. S 31° E 36.13' Found PK nail E. side power pole. S 25° E 35.46' Found PK nail E. side power pole. S 11° W 31.00' Found drill hole at N. W. corner 2'x3' conc. base to meter station. N 26° W 73.24' Set "+" E. face of 20" Dia. billboard sign pole.

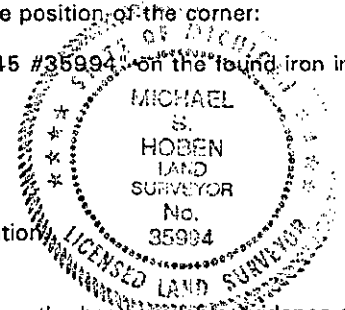

The selected location is accepted by me and is generally accepted by Professional Surveyors as the best available evidence of the original corner.

Signed by [Signature] Date Dec 27, 1999
Surveyor's Michigan License No. 35994

FORM APPROVED BY MICHIGAN STATE BOARD OF LAND SURVEYORS, JAN. 28, 1971

Handwritten initials or mark at the bottom of the page.