

MAR 17 2000

LAND CORNER RECORDATION CERTIFICATE  
Filing Requirement of Act 74, Mich. P.A. 1970

For corners in

SECTION

Macomb (County)	Located In: Clinton Twp.	Corner Code #
1. Public Land Survey	T 2N R 13E	I-11
	T R	
	T R	
	T R	
2. Property Controlling in Section	S T R	
	S T R	
3. Miscellaneous Property in Sec.	S T R	
	S T R	

1175  
LIBER 9275 PAGE 526  
01/04/2000 09:29:20 A.M.  
MACOMB COUNTY, MI  
CARMELLA SABAUGH, REG/DEEDS

Register of Deeds Stamp & File  
Number

4. Lot No. \_\_\_\_\_, Recorded Plat \_\_\_\_\_  
5. Private Claims \_\_\_\_\_

I, Michael S. Hoben, in a field survey on June 18, 1999 do hereby state that under requirements of P.A. 74, Michigan P.A. of 1970, the corner points mentioned in lines 1 and 2 above were in conformance with regulations and rules therefore as required in the current manual of survey instructions of the United States Department of the Interior, Bureau of Land Management or by a decree of a Court of Law and/or that the corner points mentioned in lines 3, 4 and 5 above were in conformance with the rules of the Michigan Board of Land Surveyors or by a Decree of a Court of Law; established, re-established, monumented, recovered, found as expressed below:

NOTE: Not more than 2 corners, all in the same town and range, may be recorded on this certificate.

	A	B	C	D	E	F	G	H	I	J	K	L
1												
2	6		5		4		3		2			
3												
4	7		8		9		10		11			
5												
6	18		17		16		15		14			
7												
8	19		20		21		22		23			
9												
10	30		29		28		27		26			
11												
12	31		32		33		34		35			
13												

A. Description of original monument and accessories and/or subsequent restoration:

I-11 1817 GLO Notes Wampler NA Set Post  
1912 "Glenwood Gardens" L. 2, P. 213 NA NA

(Continued on back)

B. Description of corner evidence found and/or method applied in restoring or reestablishing corner:

I-11 I found a copper clad iron in mon. box. Stamped #13589 in the centerline of 15 Mile Road (conc.). Fence line runs N&S from I-

1922 "A.F. Hengesbach's Sub" located property corners matched corner location of I-11  
1924 "Quinnton Sub." Located property corners Fit corner location of I-11

(Continued on back)

C. Description of monument for corner and accessories established to perpetuate locating the position of the corner:

I-11 I replaced the found a copper clad iron in mon. box. Stamped #13589 with a 3/4" x 24" iron w/2" diameter aluminum cap stamped "Macomb County Monument MI Act 345 #35994" in an existing monument box (raised box to road surface).

- N 3° E 38.52' Found P.K. w/tag "SWM 30092" west side T.P.
- N 70° E 85.29' Found nail w/MDSH tag NW side T.P.
- S 22° E 47.28' Set mag. nail w/Remon tag in west side P.P.
- N 7° W 60.26' North face-steel fence-post.
- S 81° W 150.45' Found P.K. north side P.P.

The selected location is accepted by me and is generally accepted by Professional Surveyors as the best available evidence of the original corner.

ACCEPTED BY THE MACOMB COUNTY SURVEY PEER GROUP AS THE OFFICIAL CORNER UNDER MICHIGAN PUBLIC ACT 345 OF 1990 AT A MEETING HELD ON 10/26/99

William E. Soderberg  
WILLIAM E. SODERBERG, P.S., CHAIRMAN

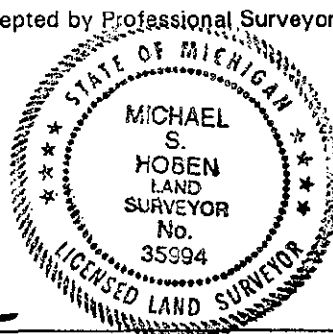

Signed by Michael S. Hoben

Date Dec 27 1999

Surveyor's Michigan License No. 35994

FORM APPROVED BY MICHIGAN STATE BOARD OF LAND SURVEYORS, JAN. 28, 1971

REVISED MAY 14  
REVISED JAN., 19  
REVISED OCT., 11

299

931