

LAND CORNER RECORDATION CERTIFICATE
 Filing Requirement of Act 74, Mich. P.A. 1970

For corners in
Macomb
 (County)

Located in: Shelby Twp. Corner Code # _____

1. Public Land Survey	T	<u>3N.</u>	R	<u>12E.</u>	<u>E-7</u>
	T	_____	R	_____	_____
	T	_____	R	_____	_____
	T	_____	R	_____	_____
2. Property Controlling in Section	S	_____	T	_____	_____
	S	_____	T	_____	_____
3. Miscellaneous Property in Sec.	S	_____	T	_____	_____
	S	_____	T	_____	_____

SURVEY &
 REMONUMENTATION

APR 07 1998

SECTION

Register of Deeds Stamp & File Number

4. Lot No. _____, Recorded Plat _____
 5. Private Claims _____

I, Jeffrey A. Wright, in a field survey on May 9, 19 97 do hereby state that under requirements of P.A. 74, Michigan P.A. of 1970, the corner points mentioned in lines 1 and 2 above were in conformance with regulations and rules therefore as required in the current manual of survey instructions of the United States Department of the Interior, Bureau of Land Management or by a decree of a Court of Law and/or that the corner points mentioned in lines 3, 4 and 5 above were in conformance with the rules of the Michigan Board of Land Surveyors or by a Decree of a Court of Law; established, re-established, monumented, recovered, found as expressed below:

NOTE: Not more than 2 corners, all in the same town and range, may be recorded on this certificate.

ACCEPTED BY THE MACOMB COUNTY SURVEY PEER GROUP AS THE OFFICIAL CORNER UNDER MICHIGAN PUBLIC ACT 345 OF 1990 AT A MEETING HELD ON 9-23-97

William E. ...

1	A	B	C	D	E	F	G	H	I	J	K	L	M
2		6		5		4		3		2		1	
3													
4		7		8		9		10		11		12	
5													
6		18		17		16		15		14		13	
7													
8		19		20		21		22		23		24	
9													
10		30		29		28		27		26		25	
11													
12		31		32		33		34		35		36	
13													

A. Description of original monument and evidence of its location:

Date	Surveyor	Number	Type	L.	P.	Monument Box
1817	Wampler		Set Post			GLO Records No
Unknown	MCRC		3/4" Iron			Field Notes Unrecorded Yes
Unknown	Unknown		3/4" Iron			Act 74 Unrecorded Yes
1974	Avendt	16034	1/2" Iron			Act 74 2498 42 Yes
1990	Avey	15396	1/2" Bar			Act 74 4983 759 Yes

B. Description of corner evidence found and/or method applied in restoring or reestablishing corner:

Found 1/2" Pipe in existing monument box at centerline intersection of 23 Mile Road & Mound Road

Location supported by corners in:	Ground	GLO	Grid
Brookside Estates Sub.#7 L. 65, P. 34	E-7-E-6 = 2626.86'	2640'/40 Chains	2626.54'
Brookside Estates Sub. #5 L. 51, P. 9	E-7-F-7 = 2660.02'	2624.16'/39.76 Chains	2659.70'
Chessire Place Sub. L. 92, P. 28-30	E-7-E-8 = 2640.30'	2640'/40 Chains	2639.99'
Evergreen Acres Sub. #1 L. 32, P. 28			
Evergreen Acres Sub. #2 L. 39, P. 41			

C. Description of monument for corner and accessories established to perpetuate locating the position of the corner:

Replaced 1/2" pipe in existing monument box with a 3/4" bar with an aluminum cap stamped "Macomb County Monument - MI Act 345 #40165"

- AZ 317° 54.90' to Mag nail w/ remonumentation tag SW side U. Pole
- AZ 207° 66.96' to Mag nail w/ remonumentation tag SE side U. Pole
- AZ 133° 60.81' to Mag nail w/ remonumentation tag NE side U. Pole
- AZ 33° 61.00' to Mag nail w/ remonumentation tag NW side U. Pole
- AZ 26° 123.39' to centerline top hydrant

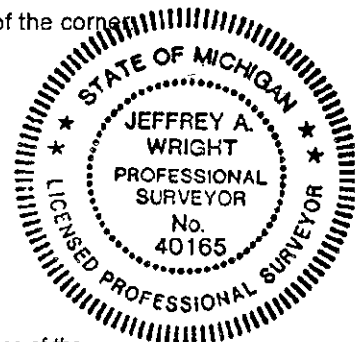

The selected location is accepted by me and is generally accepted by Professional Surveyors as the best available evidence of the position of the original corner.

Signed by *Jeffrey A. Wright* Date: 2 DECEMBER 1997

Surveyor's Michigan License No. 40165