

LAND CORNER RECORDATION CERTIFICATE
Filing Requirement of Act 74, Mich. P.A. 1970

**SURVEY &
REMONUMENTATION**

FEB 27 1997

COMMISSION

For corners in

Macomb
(County)

Located In:
Shelby Twp.

Corner Code #

1. Public Land Survey	T	<u>3N.</u>	R	<u>12E.</u>	<u>I-8</u>
	T		R		
	T		R		
	T		R		
2. Property Controlling in Section	S		T	R	
	S		T	R	
3. Miscellaneous Property in Sec.	S		T	R	
	S		T	R	

Register of Deeds Stamp & File Number

4. Lot No. _____, Recorded Plat _____
5. Private Claims _____

I, Jeffrey A. Wright, in a field survey on June 20, 1996, do hereby state that under requirements of P.A. 74, Michigan P.A. of 1970, the corner points mentioned in lines 1 and 2 above were in conformance with regulations and rules therefore as required in the current manual of survey instructions of the United States Department of the Interior, Bureau of Land Management or by a decree of a Court of Law and/or that the corner points mentioned in lines 3, 4 and 5 above were in conformance with the rules of the Michigan Board of Land Surveyors or by a Decree of a Court of Law; established, re-established, monumented, recovered, found as expressed below:

NOTE: Not more than 2 corners, all in the same town and range, may be recorded on this certificate.

ACCEPTED BY THE MACOMB COUNTY SURVEY PEER GROUP AS THE OFFICIAL CORNER UNDER MICHIGAN PUBLIC ACT 345 OF 1990 AT A MEETING HELD ON 7-23-96

William E. Soderberg
WILLIAM E. SODERBERG, P.S. CHAIRMAN

1	A	B	C	D	E	F	G	H	I	J	K	L	M
2		6		5		4		3		2		1	
3													
4		7		8		9		10		11		12	
5													
6		18		17		16		15		14		13	
7													
8		19		20		21		22		23		24	
9													
10		30		29		28		27		26		25	
11													
12		31		32		33		34		35		36	
13													

A. Description of original monument and accessories and/or subsequent restoration:

Date	Surveyor	Number	Type	L.	P.	Monument Box
1817	Wampler		Set Post	GLO Records		No
1973	Smith	16052	F. 1/2" Pipe	2414	502	No
1984	Avey	15396	F. 1/2" Pipe	Unrecorded		No
1991	Avey	30076	F. 1/2" Bar	5063	826	No

B. Description of corner evidence found and/or method applied in restoring or reestablishing corner:

F. 1/2" Bar on E'ly R/W fence (M-53 Expressway) 5' +/- N. of E-W ditch

Fits call in:	Location supported by corners in:		GLO
L. 2414, P. 502	F. 1/2" Pipe	S/P Runyan Acres L. 18, P. 10	1-8 - I-7 = 2631.14' 2640' / chains
L. 5063, P. 826	F. 1/2" Bar		1-8 - I-9 = 2623.59' 2640' / chains

C0438548 LIBER:07245 PAGE:409 08:59A 11/14/1996
CARMELLA SABAUGH-MACOMB COUNTY, MI REG/DEEDS

C. Description of monument for corner and accessories established to perpetuate locating the position of the corner:

Replaced 1/2" Bar w/ 3/4" Bar w/ aluminum cap stamped "Macomb County Monument - MI Act 345 of 1990"

- AZ 210° 35.43' to Mag nail with remonumentation tag SE side 10" Ash
- AZ 335° 17.05' to Mag nail with remonumentation tag NE side 12" Poplar
- AZ 271° 54.55' to Mag nail with remonumentation tag top of concrete headwall
- AZ 8° 21.84' to Mag nail with remonumentation tag E side 2-12" Ash
- AZ 34° 31.05' to Mag nail with remonumentation tag NW side 4-12" Maple

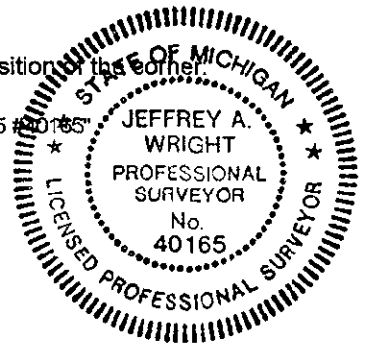

The selected location is accepted by me and is generally accepted by Professional Surveyor's as the best available evidence of the position by the original corner.

Signed by *Jeffrey A. Wright* Date: 16 OCTOBER 1996

Surveyor's Michigan License No. 40165

573