

SURVEY & REMONUMENTATION

APR 28 1995

COMMISSION

LAND CORNER RECORDATION CERTIFICATE Filing Requirement of Act 74, Mich. P.A. 1970

94 DEC -9 PM 2:47
C150760

For corners in Macomb

Macomb Twp.

CARMELLA SABAUGH
REGISTER OF DEEDS,
MACOMB COUNTY, MI

		Located In:		Corner Code #	
(County)					
		3N	13E	B-9	
1. Public Land Survey	T	_____	R	_____	_____
	T	_____	R	_____	_____
	T	_____	R	_____	_____
	T	_____	R	_____	_____
2. Property Controlling in Section	S	_____	T	_____	_____
	S	_____	T	_____	_____
3. Miscellaneous Property in Sec.	S	_____	T	_____	_____
	S	_____	T	_____	_____

LIBER **6523** PAGE **907**

Register of Deeds Stamp & File Number

4. Lot No. _____, Recorded Plat _____
5. Private Claims _____

I, Robert D. Kohn, in a field survey on August 22, 1994, do hereby certify that under requirements of P.A. 74, Michigan P.A. of 1970, the corner points mentioned in lines 1 and 2 above were in conformance with regulations and rules therefore as required in the current manual of survey instructions of the United States Department of the Interior, Bureau of Land Management or by a decree of a Court of Law and/or that the corner points mentioned in lines 3, 4 and 5 above were in conformance with the rules of the Michigan Board of Land Surveyors or by a Decree of a Court of Law; established, re-established, monumented, re-monumented, recovered, found as expressed below:

NOTE: Not more than 4 corners, all in the same town and range, may be recorded on this certificate.

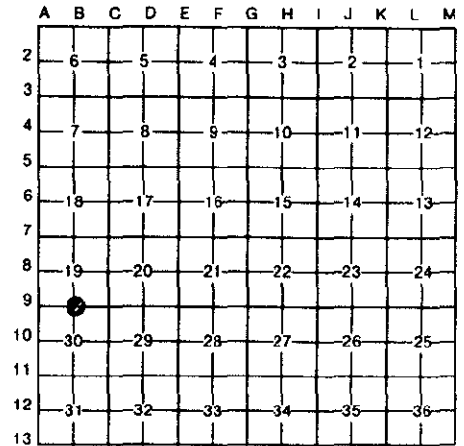

A. Description of original monument and accessories and/or subsequent restoration:

1817 Post	G.L.O.	W. Preston	N/A	Notes
1971 1/2" Pipe	L.C.R.C.	H. Avey	#15396	L2208 P301
1979 1/2" Pipe	L.C.R.C.	H. Kobs	#14097	L3162 P601
1979 1/2" Pipe	L.C.R.C.	W. Soderberg	#17635	L3218 P55
1979 1/2" Pipe	Survey	H. Kobs	#14097	L3142 P435
1979 1/2" Pipe	Survey	W. Soderberg	#17635	L3197 P104
1980 1/2" Pipe	L.C.R.C.	J. Fenn	#23505	L3217 P913
1985 1/2" Pipe	Survey	H. Kobs	#14097	L4055 P610-611

B. Description of corner evidence found and/or method applied in restoring or reestablishing corner:

A 1/2" pipe in asphalt pavement still marks this corner. The following witness ties were used to recover and verify its position:

2 ties from L.C.R.C.	L3162 P601
3 ties from L.C.R.C.	L3217 P913
4 ties from L.C.R.C.	L3218 P55

Field measurements were made between the following corners:

B-9 to A-9	2036.97	meas.		
	2021.58	rec.	G.L.O.	Notes
	2036.86	rec.	L81 P51-54	Plat
	2037.08	rec.	L3197 P104	Survey
	2036.80	rec.	tax	
B-9 to C-9	2666.61	meas.		
	2640	rec.	G.L.O.	Notes
	2666.48	rec.	L3142 P435	Survey
	2666.48	rec.	L4055 P611	Survey
	2666.48	rec.	L4055 P610	Survey

ACCEPTED BY THE MACOMB COUNTY SURVEY PEER
GROUP AS THE OFFICIAL CORNER UNDER MICHIGAN
PUBLIC ACT 345 OF 1990 AT A MEETING HELD
ON 9-27-94

William E. Soderberg
WILLIAM E. SODERBERG, P.S., CHAIRMAN

C. Description of monument for corner and accessories established to perpetuate locating the position of the corner:

I replaced the 1/2" pipe with a 3/4" x 24" iron rod with a 2" diameter aluminum cap stamped "Macomb County Monument MI Act 345 #26459" in a new monument box.

N.02° W.	28.12'	P.K. nail & remon. tag E. face u-pole
N.71° E.	79.79'	Centerline top nut fire hydrant
S.61° W.	77.75'	Chiseled " + " N. rim san. manhole
S.02° E.	26.67'	P.K. nail & remon. tag W. face u-pole

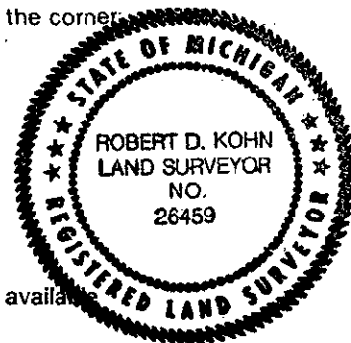

The selected location is accepted by me and generally accepted by Professional Surveyors as the best available evidence of the position of the original corner.

Signed by Robert D. Kohn Date November 9, 1994
Surveyor's Michigan License No. 26459