

SURVEY & REMONUMENTATION

APR 28 1995

C150765

COMMISSION

LAND CORNER RECORDATION CERTIFICATE

Filing Requirement of Act 74, Mich. P.A. 1970

For corners in Macomb

Macomb Twp.

94 DEC -9 PM 2:47

CARMELLA SABAUGH
REGISTER OF DEEDS
MACOMB COUNTY, MI

LIBER 6523 PAGE 912

Register of Deeds Stamp & File Number

		Located In:		Corner Code #	
(County)					
		3N	13E	C-9	
1. Public Land Survey		T _____	R _____		_____
		T _____	R _____		_____
		T _____	R _____		_____
		T _____	R _____		_____
2. Property Controlling in Section	S _____	T _____	R _____		_____
	S _____	T _____	R _____		_____
3. Miscellaneous Property in Sec.	S _____	T _____	R _____		_____
	S _____	T _____	R _____		_____

4. Lot No. _____, Recorded Plat _____
5. Private Claims _____

I, Robert D. Kohn, in a field survey on August 22, 1994, do hereby certify that under requirements of P.A. 74, Michigan P.A. of 1970, the corner points mentioned in lines 1 and 2 above were in conformance with regulations and rules therefore as required in the current manual of survey instructions of the United States Department of the Interior, Bureau of Land Management or by a decree of a Court of Law and/or that the corner points mentioned in lines 3, 4 and 5 above were in conformance with the rules of the Michigan Board of Land Surveyors or by a Decree of a Court of Law; established, re-established, monumented, re-monumented, recovered, found as expressed below:

NOTE: Not more than 4 corners, all in the same town and range, may be recorded on this certificate.

A. Description of original monument and accessories and/or subsequent restoration:

Date	Monument	G.L.O.	W. Preston	N/A	Notes
1817	Post				
1972	1/2" Iron bar	L.C.R.C.	H. Kobs	#14097	L2370 P411
1977	1/2" Steel rod	L.C.R.C.	J. Fenn	#23505	L2844 P956
1978	1/2" Re-rod	L.C.R.C.	W. Soderberg	#17635	L3089 P941
1978	Re-rod	Survey	W. Soderberg	#17635	L3059 P207
1979	1/2" Iron bar	Survey	H. Kobs	#14097	L3142 P435
1985	1/2" Bar	Survey	H. Kobs	#14097	L4055 P610
1991	1/2" Bar	L.C.R.C.	W. Avey	#30076	L5063 P829
1992	Iron in mon. box	Survey	W. Soderberg	#17635	L5739 P35

B. Description of corner evidence found and/or method applied in restoring or reestablishing corner:

A 1/2" iron rod in asphalt pavement still marks this corner. The following witness ties were used to recover and verify its position:

- 2 ties from L.C.R.C. L2370 P411
- 4 ties each from L.C.R.C. L2844 P956
- L3089 P941
- L5063 P829

Field measurements were made between the following corners:

C-9 to C-8	2667.69	meas.			
	2640	G.L.O.			
	2668.48	rec.	L4055 P610	Survey	
C-9 to D-9	2671.10	meas.			
	2633.07	G.L.O.			
	2670.97	rec.	L5739 P35	Survey	
C-9 to C-10	2669.66	meas.			
	2640	G.L.O.			
	2669.48	rec.	L3059 P207	Survey	
C-9 to B-9	2666.61	meas.			
	2640	G.L.O.			
	2666.48	rec.	L3142 P435	Survey	
	2666.48	rec.	L4055 P610	Survey	

ACCEPTED BY THE MACOMB COUNTY SURVEY PEER
GROUP AS THE OFFICIAL CORNER UNDER MICHIGAN
PUBLIC ACT 345 OF 1990 AT A MEETING HELD
ON 9-27-94

William E. Soderberg
WILLIAM E. SODERBERG, P.S., CHAIRMAN

C. Description of monument for corner and accessories established to perpetuate locating the position of the corner:

I replaced the 1/2" iron rod in asphalt pavement with a 3/4" x 24" iron rod with 2" diameter aluminum stamped "Macomb County Monument MI Act 345 #26459" with new monument box.

- N.76° W. 110.73' Centerline top nut fire hydrant
- S.80° W. 131.88' P.K. nail and remon. tag in S. face power pole
- N.45° E. 50.76' P.K. nail and remon. tag in N.W. face U-pole
- S.59° E. 46.92' Bolt spike N.E. face U-pole

The selected location is accepted by me and generally accepted by Professional Surveyors as the best available evidence of the position of the original corner.

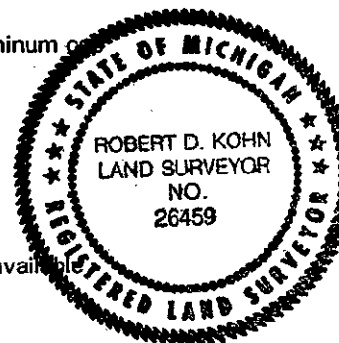

Signed by Robert D. Kohn Date November 9, 1994

Surveyor's Michigan License No. 26459