

SURVEY & REMONUMENTATION

APR 28 1995

C150767

COMMISSION

LAND CORNER RECORDATION CERTIFICATE

Filing Requirement of Act 74, Mich. P.A. 1970

For corners in Macomb

Macomb Twp.

94 DEC -9 PM 2:47

CARMELLA SCHAUGH
REGISTER OF DEEDS
MACOMB COUNTY, MI

LIBER 6523 PAGE 914

Register of Deeds Stamp & File Number

	Located In:		Corner Code #
	3N	13E	
1. Public Land Survey	T	R	D-3
	T	R	
	T	R	
	T	R	
2. Property Controlling in Section	S	T	R
	S	T	R
3. Miscellaneous Property in Sec.	S	T	R
	S	T	R

4. Lot No. _____, Recorded Plat _____
5. Private Claims _____

I, Robert D. Kohn, in a field survey on October 2, 1994, do hereby certify that under requirements of P.A. 74, Michigan P.A. of 1970, the corner points mentioned in lines 1 and 2 above were in conformance with regulations and rules therefore as required in the current manual of survey instructions of the United States Department of the Interior, Bureau of Land Management or by a decree of a Court of Law and/or that the corner points mentioned in lines 3, 4 and 5 above were in conformance with the rules of the Michigan Board of Land Surveyors or by a Decree of a Court of Law; established, re-established, monumented, re-monumented, recovered, found as expressed below:

NOTE: Not more than 4 corners, all in the same town and range, may be recorded on this certificate.

A. Description of original monument and accessories and/or subsequent restoration:

Date	Description	Notes	Surveyor	License #	Notes
1817	Post		W. Preston	N/A	
1974	5/8" Bar	L.C.R.C.	H. Kobs	#14097	L2534 P483
1974	5/8" Bar	Survey	H. Kobs	#14097	L2534 P458
1975	5/8" Bar	Survey	H. Kobs	#14097	L2653 P31
1979	5/8" Bar	Survey	H. Kobs	#14097	L3120 P132
1985	5/8" Bar	Survey	D. King	#30085	L3880 P110
1985	5/8" Bar	Survey	D. King	#30085	L3880 P112
1985	5/8" Bar	Survey	D. King	#30085	L3900 P809
1987	5/8" Bar	Survey	D. King	#30085	L4306 P725
1990	5/8" Bar	Survey	D. King	#30085	L5014 P678
1993	5/8" Bar	Survey	D. King	#30085	L5969 P157

B. Description of corner evidence found and/or method applied in restoring or reestablishing corner:

A 5/8" bar in asphalt pavement which is 1.5' south of the centerline of the road currently marks this corner. The following witness ties were used to recover and verify its positions:

3 ties from L.C.R.C. L2534 P483

Field measurements were made between the following corners:

From	To	Distance	Measurement	Notes
C-3	D-3	2671.78	meas.	
		2640	rec.	G.L.O.
		2671.73	rec.	L5969 P157
D-3	E-3	2663.76	meas.	
		2640	rec.	G.L.O.
		2663.85	rec.	L2534 P458
		2663.84	rec.	L3880 P110

ACCEPTED BY THE MACOMB COUNTY SURVEY PEER GROUP AS THE OFFICIAL CORNER UNDER MICHIGAN PUBLIC ACT 345 OF 1990 AT A MEETING HELD ON 10-18-94

William E. Soderberg
WILLIAM E. SODERBERG, P.S., CHAIRMAN

C. Description of monument for corner and accessories established to perpetuate locating the position of the corner:

I replaced the 5/8" bar with a 3/4" x 24" iron rod with 2" diameter aluminum cap stamped "Macomb County Monument MI Act 345 #26459" in new monument box.

N.40° E.	165.11'	S.E. house corner, house #17671 25 Mile Rd.
S.38° E.	33.34'	P.K. and remon. tag in west face of 36" Maple
S.45° W.	50.00'	Set P.K. nail & remon. tag in S.E. face of utility pole
N.11° W.	21.34'	Set P.K. and remon tag in west face of utility pole

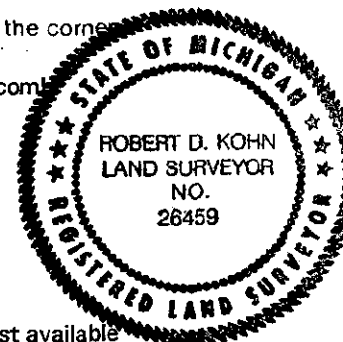

The selected location is accepted by me and is generally accepted by Professional Surveyors as the best available evidence of the position of the original corner.

Signed by Robert D. Kohn

Date November 9, 1994

Surveyor's Michigan License No. 26459