

SURVEY & REMONUMENTATION

APR 28 1995

COMMISSION

LAND CORNER RECORDATION CERTIFICATE
Filing Requirement of Act 74, Mich. P.A. 1970

C150768

For corners in Macomb

Macomb Twp.

		Located In:		Corner Code #/19
(County)				
		3N	13E	D-5
1. Public Land Survey	T	_____	R	_____
	T	_____	R	_____
	T	_____	R	_____
	T	_____	R	_____
2. Property Controlling in Section	S	_____	T	_____
	S	_____	T	_____
3. Miscellaneous Property in Sec.	S	_____	T	_____
	S	_____	T	_____

94 DEC -9 PM 2:48

CAROL A. BAUGH
REGISTER OF DEEDS
MACOMB COUNTY, MI

LIBER **6523** PAGE **915**

Register of Deeds Stamp & File Number

4. Lot No. _____, Recorded Plat _____
5. Private Claims _____

Robert D. Kohn

September 16

94

I, _____, in a field survey on _____, 19____, do hereby certify that under requirements of P.A. 74, Michigan P.A. of 1970, the corner points mentioned in lines 1 and 2 above were in conformance with regulations and rules therefore as required in the current manual of survey instructions of the United States Department of the Interior, Bureau of Land Management or by a decree of a Court of Law and/or that the corner points mentioned in lines 3, 4 and 5 above were in conformance with the rules of the Michigan Board of Land Surveyors or by a Decree of a Court of Law; established, re-established, monumented, re-monumented, recovered, found as expressed below:

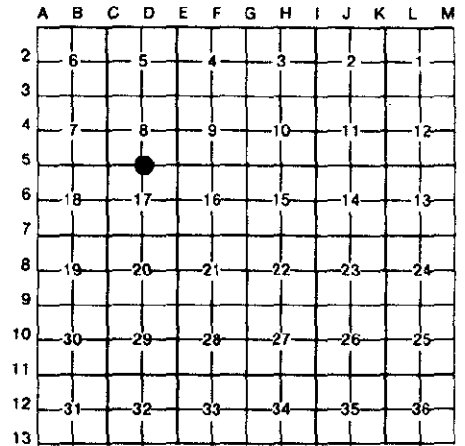

NOTE: Not more than 4 corners, all in the same town and range, may be recorded on this certificate.

A. Description of original monument and accessories and/or subsequent restoration:

1817	Set post	G.L.O.	W. Preston	N/A	Notes
1979	N/A	M.C.R.C.	Lozen	N/A	Sec. 8 File 62
1985	1/2" Iron bar	Survey	H. Kobs	#14097	L3880 P63
1986	1/2" Iron	L.C.R.C.	H. Kobs	#14097	L3880 P119
1989	1/2" Re-bar	L.C.R.C.	S. Money	#30092	L4718 P612
1989	1/2" Iron bar	Survey	D. King	#30085	L4729 P202

B. Description of corner evidence found and/or method applied in restoring or reestablishing corner:

A P.K. nail in an asphalt road currently marks this corner. The following witness ties were used to recover and verify its position:

2 ties from L.C.R.C.	L3880 P119
3 ties from L.C.R.C.	L4718 P612
1 tie from M.C.R.C.	File No. 62

ACCEPTED BY THE MACOMB COUNTY SURVEY PEER GROUP AS THE OFFICIAL CORNER UNDER MICHIGAN PUBLIC ACT 345 OF 1990 AT A MEETING HELD ON 9-27-94

William E. Soderberg
WILLIAM E. SODERBERG, P.S., CHAIRMAN

Field measurements were made between the following corners:

C-5 to D-5	2663.00	meas.	G.L.O.	Notes	2641.32
	2662.94	rec.	L5767 P593	Condominium	
	2662.65	rec.	L3880 P63	Survey	
D-5 to E-5	2674.99	meas.	G.L.O.	Notes	2641.98
	2675.00	rec.	L3880 P63	Survey	
	2675.00	rec.	L4729 P202	Survey	

C. Description of monument for corner and accessories established to perpetuate locating the position of the corner:

I replaced the P.K. nail in asphalt pavement with a new monument box with a 3/4" x 24" iron rod with 2" diameter aluminum cap stamped "Macomb County Monument MI Act 345 #26459".

N.12° E.	21.96'	P.K. nail & remon. tag in E. face of U-pole
S.00° E.	33.07'	Found a concrete monument
N.82° W.	152.33'	Set a P.K. nail & remon. tag in the S. face of a U-pole
N.82° E.	148.43'	Set a P.K. nail & remon. tag in the S. face of a U-pole

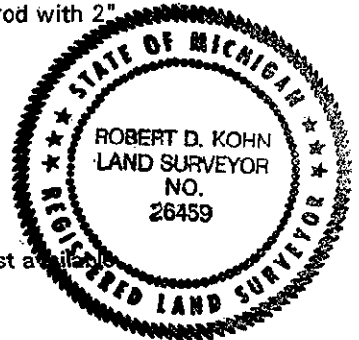

The selected location is accepted by me and generally accepted by Professional Surveyors as the best available evidence of the position of the original corner.

Signed by Robert D. Kohn
Surveyor's Michigan License No. 26459

Date NOVEMBER 9, 1994