

**LAND CORNER RECORDATION CERTIFICATE**  
**Filing Requirement of Act 74, Mich. P.A. 1970**

**SURVEY & REMONUMENTATION COMMISSION**

FEB 27 1997

COMMISSION

For corners in

Macomb  
 (County)

Located In: Macomb Twp. Corner Code #

|                                    |             |              |            |
|------------------------------------|-------------|--------------|------------|
| 1. Public Land Survey              | T <u>3N</u> | R <u>13E</u> | <u>E-1</u> |
|                                    | T _____     | R _____      | _____      |
|                                    | T _____     | R _____      | _____      |
|                                    | T _____     | R _____      | _____      |
| 2. Property Controlling in Section | S _____     | T _____      | R _____    |
|                                    | S _____     | T _____      | R _____    |
| 3. Miscellaneous Property in Sec.  | S _____     | T _____      | R _____    |
|                                    | S _____     | T _____      | R _____    |

ACCEPTED BY THE MACOMB COUNTY SURVEY PEER GROUP AS THE OFFICIAL CORNER UNDER MICHIGAN PUBLIC ACT 345 OF 1990 AT A MEETING HELD ON 7-23-96  
*William E. Soderberg*  
 WILLIAM E. SODERBERG, P.S., CHAIRMAN  
**Register of Deeds Stamp & File Number**

4. Lot No. \_\_\_\_\_, Recorded Plat \_\_\_\_\_

5. Private Claims \_\_\_\_\_

I, Robert D. Kohn, in a field survey on November 30, 1996 do hereby state that under requirements of P.A. 74, Michigan P.A. of 1970, the corner points mentioned in lines 1 and 2 above were in conformance with regulations and rules therefore as required in the current manual of survey instructions of the United States Department of the Interior, Bureau of Land Management or by a decree of a Court of Law and /or that the corner points mentioned in lines 3, 4 and 5 above were in conformance with the rules of the Michigan Board of Land Surveyors or by a Decree of a Court of Law; established, re-established, monumented, recovered, found as expressed below:

|    |    |   |    |   |    |   |    |   |    |   |    |   |
|----|----|---|----|---|----|---|----|---|----|---|----|---|
| A  | B  | C | D  | E | F  | G | H  | I | J  | K | L  | M |
| 1  |    |   |    |   |    |   |    |   |    |   |    |   |
| 2  | 6  |   | 5  |   | 4  |   | 3  |   | 2  |   | 1  |   |
| 3  |    |   |    |   |    |   |    |   |    |   |    |   |
| 4  | 7  |   | 8  |   | 9  |   | 10 |   | 11 |   | 12 |   |
| 5  |    |   |    |   |    |   |    |   |    |   |    |   |
| 6  | 18 |   | 17 |   | 16 |   | 15 |   | 14 |   | 13 |   |
| 7  |    |   |    |   |    |   |    |   |    |   |    |   |
| 8  | 19 |   | 20 |   | 21 |   | 22 |   | 23 |   | 24 |   |
| 9  |    |   |    |   |    |   |    |   |    |   |    |   |
| 10 | 30 |   | 29 |   | 28 |   | 27 |   | 26 |   | 25 |   |
| 11 |    |   |    |   |    |   |    |   |    |   |    |   |
| 12 | 31 |   | 32 |   | 33 |   | 34 |   | 35 |   | 36 |   |
| 13 |    |   |    |   |    |   |    |   |    |   |    |   |

NOTE: Not more than 2 corners, all in the same town and range, may be recorded on this certificate.

A. Description of original monument and accessories and/or subsequent restoration:

|      |                      |            |        |                          |
|------|----------------------|------------|--------|--------------------------|
| 1817 | No Corner set        | W. Preston | N/A    | GLO Notes                |
| 1973 | Found iron           | F. Bridges | #5779  | Survey L 2420 P 1        |
| 1977 | 1/2" Pipe in mon box | W. Coulter | #14760 | L.C.R.C. L 2807 P 354    |
| 1989 | Iron pipe in mon box | M. Dunn    | #30081 | L.C.R.C. L 4587 P 332    |
| 1991 | 1/2" Iron in mon box | D. King    | #30085 | Survey L 5253 P 196      |
| 1993 | 1/2" Iron in mon box | D. King    | #30085 | Survey L 5969 P 124, 122 |

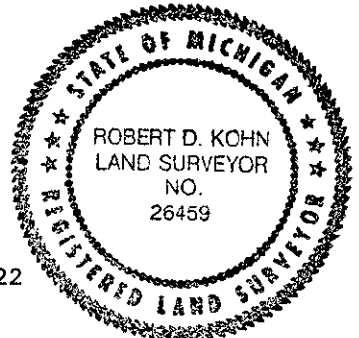

B. Description of corner evidence found and/or method applied in restoring or reestablishing corner:

A 1" iron pipe in an existing monument box currently occupies this corner and falls on line between the south 1/4 corner of Section 32 (D-13) and the S.E. corner of Section 32 (E-13). The following witness ties were used to recover and verify its position:

- 2 ties match witnesses from L 5253 P 196 & L 5969 P 124, 122
- 3 ties match witnesses from L 2807 P 354 & L 4687 P 332

Field measurements were made between the following corners:

|            |                      |            |                        |             |                       |
|------------|----------------------|------------|------------------------|-------------|-----------------------|
| E-1 to F-1 | 2687.99 meas.        | D-1 to E-1 | 2669.09 meas.          | E-1 to E-13 | 95.33 meas.           |
|            | 2687.54 Rec L2420 P1 |            | 2668.80 Rec L5253 P196 |             | 100.32 Rec G.L.O.     |
|            |                      |            |                        |             | 95.35 Rec. L2807 P354 |

C. Description of monument for corner and accessories established to perpetuate locating the position of the corner:

I replaced the 1" iron pipe with a 3/4" x 24" iron rod with a 2" diameter aluminum cap stamped "Macomb County Monument MI Act 345 #26459" in the existing monument box in asphalt pavement; the witnesses are as follows:

|           |        |   |
|-----------|--------|---|
| Due North | 32.11' | P.K. nail and Mac. Co. remon. washer in E. face U-pole        |
| Due East  | 95.33' | Mac. Co. remon. cap & iron #26459 in mon. box (E-13) Ray Twp. |
| S. 20°W.  | 91.00' | P.K. nail and Mac. Co. remon. washer in S.E. face U-pole      |
| S. 60°W.  | 66.35' | P.K. nail and Mac. Co. remon. washer in N. face 12" Walnut    |

The selected location is accepted by me and generally accepted by Professional Surveyors as the best available evidence of the position of the original corner.

Signed by Robert D. Kohn Date November 30, 1996  
 Surveyor's Michigan License No. #26459

600