

SURVEY & REMONUMENTATION

APR 28 1995

LAND CORNER RECORDATION CERTIFICATE

Filing Requirement of Act 74, Mich. P.A. 1970

For corners in **COMMISSION**
Macomb

Macomb Twp.

C150771

(County)	Located In:	Corner Code #
	3N 13E	E-3
1. Public Land Survey	T _____ R _____	_____
	T _____ R _____	_____
	T _____ R _____	_____
	T _____ R _____	_____
2. Property Controlling in Section	S _____ T _____ R _____	_____
	S _____ T _____ R _____	_____
3. Miscellaneous Property in Sec.	S _____ T _____ R _____	_____
	S _____ T _____ R _____	_____
4. Lot No. _____, Recorded Plat _____		
5. Private Claims _____		

LIBER **6523** PAGE **918**
94 DEC -9 PM 2:48

CAROL J. GAUGH
REGISTER OF DEEDS
MACOMB COUNTY, MI

Register of Deeds Stamp & File Number

I, Robert D. Kohn, in a field survey on October 2, 1994

do hereby certify that under requirements of P.A. 74, Michigan P.A. of 1970, the corner points mentioned in lines 1 and 2 above were in conformance with regulations and rules therefore as required in the current manual of survey instructions of the United States Department of the Interior, Bureau of Land Management or by a decree of a Court of Law and/or that the corner points mentioned in lines 3, 4 and 5 above were in conformance with the rules of the Michigan Board of Land Surveyors or by a Decree of a Court of Law; established, re-established, monumented, re-monumented, recovered, found, as expressed below:

NOTE: Not more than 4 corners, all in the same town and range, may be recorded on this certificate.

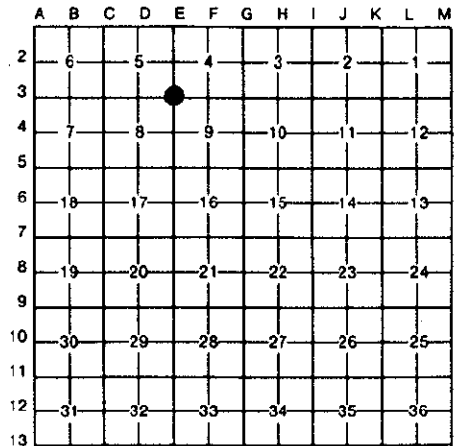

A. Description of original monument and accessories and/or subsequent restoration:

1817 12" Black Ash	Notes	W. Preston	N/A	Notes
1974 1/2" Iron in mon box	L.C.R.C.	G. Avendt	#16034	L2480 P467
1974 1/2" Iron in mon box	L.C.R.C.	H. Kobs	#14097	L2534 P483
1974 1/2" Iron in mon box	L.C.R.C.	J. Buckerfield	#10868	L2544 P224
1974 1/2" Iron in mon box	Survey	H. Kobs	#14097	L2534 P458
1974 1/2" Iron in mon box	Survey	G. Avendt	#16034	L2480 P466
1974 1/2" Iron in mon box	Survey	H. Kobs	#14097	L2569 P83
1977 1/2" Iron in mon box	Survey	G. Avendt	#16034	L2870 P783
1985 1/2" Iron in mon box	Survey	D. King	#30085	L3880 P110
1985 1/2" Iron in mon box	Survey	D. King	#30085	L3900 P809

B. Description of corner evidence found and/or method applied in restoring or reestablishing corner:

A 1/2" iron in a monument box being 1.0' ± north of the centerline of existing asphalt pavement currently marks this corner. The following witness ties were used to recover and verify its position:

- 3 ties from L.C.R.C. L2480 P467
- 2 ties from L.C.R.C. L2534 P483

Field measurements were made between the following corners:

D-3 to E-3	2663.76	meas.		
	2640	rec.	G.L.O.	Notes
	2663.85	rec.	L2534 P458	Survey
	2663.84	rec.	L3880 P110	Survey
E-3 to F-3	2663.74	rec.	L3900 P809	Survey
	2684.85	meas.		
	2646.60	rec.	G.L.O.	Notes
E-3 to F-3	2684.86	rec.	L2569 P83	Survey
	2676.14	meas.		
E-3 to E-4	2640	rec.	G.L.O.	Notes

C. Description of monument for corner and accessories established to perpetuate locating the position of the corner:

I replaced the 1/2" iron rod in an existing monument box with a 3/4" x 24" iron rod with 2" diameter aluminum cap stamped "Macomb County Monument MI Act 345 #26459".

- N.40° E. 114.45' Southwest corner of house #18721
- N.48° E. 37.54' P.K. and remon. tag in S.E. face of utility pole
- N.80° W. 130.75' P.K. and remon. tag in S. face of utility pole
- N.62° W. 93.42' Centerline top of hydrant

ACCEPTED BY THE MACOMB COUNTY SURVEY PEER
GROUP AS THE OFFICIAL CORNER UNDER MICHIGAN
PUBLIC ACT 345 OF 1990 AT A MEETING HELD
ON 10-18-94

William E. Soderberg
WILLIAM E. SODERBERG, P.S., CHAIRMAN

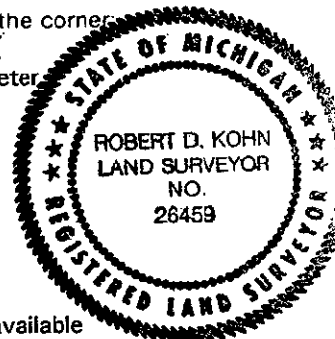

The selected location is accepted by me and generally accepted by Professional Surveyors as the best available evidence of the position of the original corner.

Signed by Robert D. Kohn

Date November 9, 1994

Surveyor's Michigan License No. 26459