

# SURVEY & REMONUMENTATION

APR 28 1995

**COMMISSION**

## LAND CORNER RECORDATION CERTIFICATE Filing Requirement of Act 74, Mich. P.A. 1970

**C150779**

For corners in Macomb

Macomb Twp.

LIBER **6523** PAGE **926**

|                                    |                         |               |       |
|------------------------------------|-------------------------|---------------|-------|
|                                    | Located In:             | Corner Code # |       |
|                                    | 3N      13E             | E-12          |       |
| 1. Public Land Survey              | T _____ R _____         |               | _____ |
|                                    | T _____ R _____         |               | _____ |
|                                    | T _____ R _____         |               | _____ |
|                                    | T _____ R _____         |               | _____ |
| 2. Property Controlling in Section | S _____ T _____ R _____ |               | _____ |
|                                    | S _____ T _____ R _____ |               | _____ |
| 3. Miscellaneous Property in Sec.  | S _____ T _____ R _____ |               | _____ |
|                                    | S _____ T _____ R _____ |               | _____ |

94 DEC -9 PM 2:49

CARMEL M. LAUGH  
REGISTER OF DEEDS  
MACOMB COUNTY, MI

**Register of Deeds Stamp & File Number**

4. Lot No. \_\_\_\_\_, Recorded Plat \_\_\_\_\_  
5. Private Claims \_\_\_\_\_

Robert D. Kohn

July 22

94

I, \_\_\_\_\_, in a field survey on \_\_\_\_\_, 19 \_\_\_\_\_, do hereby certify that under requirements of P.A. 74, Michigan P.A. of 1970, the corner points mentioned in lines 1 and 2 above were in conformance with regulations and rules therefore as required in the current manual of survey instructions of the United States Department of the Interior, Bureau of Land Management or by a decree of a Court of Law and/or that the corner points mentioned in lines 3, 4 and 5 above were in conformance with the rules of the Michigan Board of Land Surveyors or by a Decree of a Court of Law; established, re-established, monumented, re-monumented, recovered, found as expressed below:

**NOTE: Not more than 4 corners, all in the same town and range, may be recorded on this certificate.**

|    |    |    |    |    |    |    |   |   |   |   |   |   |   |
|----|----|----|----|----|----|----|---|---|---|---|---|---|---|
|    | A  | B  | C  | D  | E  | F  | G | H | I | J | K | L | M |
| 2  | 6  | 5  | 4  | 3  | 2  | 1  |   |   |   |   |   |   |   |
| 3  |    |    |    |    |    |    |   |   |   |   |   |   |   |
| 4  | 7  | 8  | 9  | 10 | 11 | 12 |   |   |   |   |   |   |   |
| 5  |    |    |    |    |    |    |   |   |   |   |   |   |   |
| 6  | 18 | 17 | 16 | 15 | 14 | 13 |   |   |   |   |   |   |   |
| 7  |    |    |    |    |    |    |   |   |   |   |   |   |   |
| 8  | 19 | 20 | 21 | 22 | 23 | 24 |   |   |   |   |   |   |   |
| 9  |    |    |    |    |    |    |   |   |   |   |   |   |   |
| 10 | 30 | 29 | 28 | 27 | 26 | 25 |   |   |   |   |   |   |   |
| 11 |    |    |    |    |    |    |   |   |   |   |   |   |   |
| 12 | 31 | 32 | 33 | 34 | 35 | 36 |   |   |   |   |   |   |   |
| 13 |    |    |    |    |    |    |   |   |   |   |   |   |   |

**A. Description of original monument and accessories and/or subsequent restoration:**

|                      |          |              |        |            |
|----------------------|----------|--------------|--------|------------|
| 1817 Post            | G.L.O.   | W. Preston   | N/A    | Notes      |
| 1972 "T" Iron        | L.C.R.C. | R. Smith     | #16052 | L2302 P904 |
| 1978 "T" Iron        | L.C.R.C. | R. Patterson | #17631 | L2940 P348 |
| 1979 "T" Iron        | L.C.R.C. | J. Fenn      | #23505 | L3217 P916 |
| 1987 "T" Iron        | L.C.R.C. | R. Donnelly  | #21563 | L4723 P609 |
| 1986 "T" Iron        | L.C.R.C. | W. Soderberg | #17635 | L4369 P432 |
| 1990 Iron & mon. box | Survey   | W. Soderberg | #17635 | L4888 P307 |
| 1991 "T" Iron        | L.C.R.C. | W. Avey      | #30076 | L5290 P292 |

**B. Description of corner evidence found and/or method applied in restoring or reestablishing corner:**

A "T" iron rod in a monument box in asphalt pavement currently marks this corner. The following witness ties were used to recover and verify its position:  
 2 ties from L.C.R.C.      L2940 P348  
 4 ties from L.C.R.C.      L3217 P916  
 3 ties each from L.C.R.C.      L4369 P432      L4723 P609      L5290 P292

Field measurements were made between the following corners:

|              |   |       |              |        |
|--------------|---|-------|--------------|--------|
| E-12 to E-11 | 2680.82   | meas. |              |        |
|              | 2640  | rec.  | G.L.O. notes |        |
|              | 2680.64   | rec.  | L70 P37-38   | Plats  |
|              | 2680.64   | rec.  | L4888, P307  | Survey |
| E-12 to E-13 | State Highway road construction in progress. Corner inaccessible. |       |              |        |

ACCEPTED BY THE MACOMB COUNTY SURVEY PEE GROUP AS THE OFFICIAL CORNER UNDER MICHIGAN PUBLIC ACT 345 OF 1990 AT A MEETING HELD ON 9-27-94  
  
 WILLIAM E. SODERBERG, P.S. CHAIRMAN

**C. Description of monument for corner and accessories established to perpetuate locating the position of the corner:**

I replaced the "T" iron with a 3/4" x 24" iron rod with 2" diameter aluminum cap stamped "Macomb County Monument MI Act 345 #26459" in an existing monument box in asphalt pavement.

|          |         |   |
|----------|---------|---|
| N.08° E. | 219.29' | P.K. & remon. tag W. face U-pole          |
| S.73° E. | 32.89'  | P.K. nail and remon. tag S. face U-pole   |
| S.39° W. | 65.35'  | Centerline top nut fire hydrant           |
| S.13° E. | 133.52' | P.K. nail and remon. tag N.E. face U-pole |

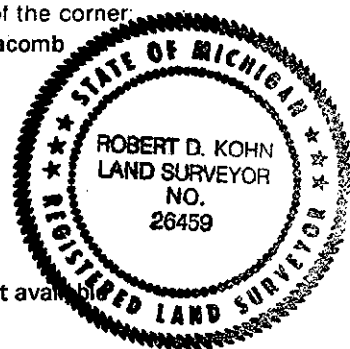

The selected location is accepted by me and generally accepted by Professional Surveyors as the best available evidence of the position of the original corner.

Signed by \_\_\_\_\_  
 Surveyor's Michigan License No. 26459

Date NOVEMBER 9, 1994