

SURVEY & REMONUMENTATION

APR 28 1995

COMMISSION

LAND CORNER RECORDATION CERTIFICATE
Filing Requirement of Act 74, Mich. P.A. 1970

C150782

94 DEC -9 PM 2:49

CARMEL BAUGH
 REGISTER OF DEEDS
 MACOMB COUNTY, MI

LIBER 6523 PAGE 929

Register of Deeds Stamp & File Number

For corners in Macomb (County) Located In: Macomb Twp. Corner Code # F-7

	3N	13E	
1. Public Land Survey	T	R	
	T	R	
	T	R	
	T	R	
2. Property Controlling in Section	S	T	R
	S	T	R
3. Miscellaneous Property in Sec.	S	T	R
	S	T	R

4. Lot No. _____, Recorded Plat _____
 5. Private Claims _____

Robert D. Kohn August 12 94

I, _____, in a field survey on _____, 19 _____ do hereby certify that under requirements of P.A. 74, Michigan P.A. of 1970, the corner points mentioned in lines 1 and 2 above were in conformance with regulations and rules therefore as required in the current manual of survey instructions of the United States Department of the Interior, Bureau of Land Management or by a decree of a Court of Law and/or that the corner points mentioned in lines 3, 4 and 5 above were in conformance with the rules of the Michigan Board of Land Surveyors or by a Decree of a Court of Law; established, re-established, monumented, re-monumented, recovered, found as expressed below:

NOTE: Not more than 4 corners, all in the same town and range, may be recorded on this certificate.

A	B	C	D	E	F	G	H	I	J	K	L	M
2	6	5	4	3	2	1						
3												
4	7	8	9	10	11	12						
5												
6	18	17	16	15	14	13						
7												
8	19	20	21	22	23	24						
9												
10	30	29	28	27	26	25						
11												
12	31	32	33	34	35	36						
13												

A. Description of original monument and accessories and/or subsequent restoration:

1817	3" Beech	G.L.O.	W. Preston	N/A	Notes
1967	1/2" Iron	M.C.R.C.	N/A	Sec.16	File #86
1978	5/8" R.R. in monument box	L.C.R.C.	J. Fenn	#23505	L3168 P259
1979	1/2" Bar in monument box	L.C.R.C.	H. Kobs	#14097	L3186 P875
1979	Iron in mon. box	Survey	R. Smith	#16052	L3184 P663
1979	1/2" bar in mon. box	Survey	H. Kobs	#14097	L3186 P866
1994	5/8" Iron in mon. box	Survey	W. Soderberg	#17635	L6281 P168

B. Description of corner evidence found and/or method applied in restoring or reestablishing corner:

A 1/2" rod in a monument box in asphalt pavement still marks this corner. The following witness ties were used to recover and verify its position.

- 2 ties from L.C.R.C. L3168 P259
- 2 ties from L.C.R.C. L3186 P875

Field measurements were made between the following corners:

E-7 to F-7	2688.79	meas.			
	2646.60	G.L.O.	Notes		
	2688.85	rec.	L102 P43-49	Plats	
	2688.99	rec.	L3184 P663	Survey	
F-7 to G-7	2674.28	meas.			
	2646.60	G.L.O.	Notes		
	2673.96	rec.	L3186 P866	Survey	
	2674.21	rec.	L6281 P168	Survey	

ACCEPTED BY THE MACOMB COUNTY SURVEY PEER GROUP AS THE OFFICIAL CORNER UNDER MICHIGAN PUBLIC ACT 345 OF 1990 AT A MEETING HELD ON 9-27-94
William E. Soderberg
 WILLIAM E. SODERBERG, P.S., CHAIRMAN

C. Description of monument for corner and accessories established to perpetuate locating the position of the corner:

I replaced the 1/2" rod in a monument box in asphalt pavement with a 3/4" x 24" iron rod with 2" diameter aluminum cap stamped "Macomb County Monument MI Act 345 #26459".

- S.72° E. 134.98' P.K. nail & remon. tag in U-pole
- S.01° W. 41.65' Concrete monument
- S.53° W. 40.13' P.K. and remon. tag N.W. face of a U-pole
- N.41° W. 33.42' P.K. and remon. tag S.W. face of a U-pole
- S.27° E. 48.91' P.K. nail and remon. tag in W. face of an 8" Pine

The selected location is accepted by me and generally accepted by Professional Surveyors as the best available evidence of the position of

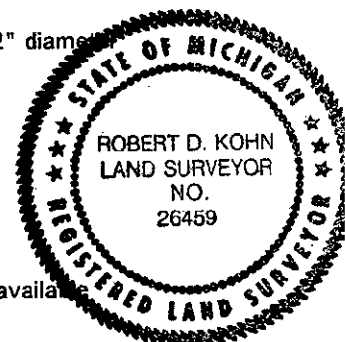

Signed by Robert D. Kohn Date November 9, 1994
 Surveyor's Michigan License No. 26459