

SURVEY & REMONUMENTATION

APR 28 1995

COMMISSION

LAND CORNER RECORDATION CERTIFICATE Filing Requirement of Act 74, Mich. P.A. 1970 Macomb Twp.

For corners in Macomb

	Located In:	Corner Code #	
(County)	3N 13E	H-11	
1. Public Land Survey	T _____ R _____	_____	_____
	T _____ R _____	_____	_____
	T _____ R _____	_____	_____
	T _____ R _____	_____	_____
2. Property Controlling in Section	S _____ T _____ R _____	_____	_____
	S _____ T _____ R _____	_____	_____
3. Miscellaneous Property in Sec.	S _____ T _____ R _____	_____	_____
	S _____ T _____ R _____	_____	_____
4. Lot No. _____, Recorded Plat _____			
5. Private Claims _____			

C150794

LIBER 6523 PAGE 941

94 DEC -9 PM 2: 50

CARMEL E. SGAUGH
REGISTER OF DEEDS
MACOMB COUNTY, MI

Register of Deeds Stamp & File Number

Robert D. Kohn August 20 94

I, _____, in a field survey on _____, 19 _____, do hereby certify that under requirements of P.A. 74, Michigan P.A. of 1970, the corner points mentioned in lines 1 and 2 above were in conformance with regulations and rules therefore as required in the current manual of survey instructions of the United States Department of the Interior, Bureau of Land Management or by a decree of a Court of Law and/or that the corner points mentioned in lines 3, 4 and 5 above were in conformance with the rules of the Michigan Board of Land Surveyors or by a Decree of a Court of Law; established, re-established, monumented, re-monumented, recovered, found as expressed below:

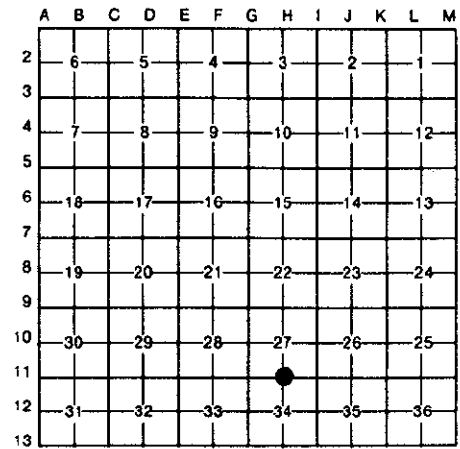

NOTE: Not more than 4 corners, all in the same town and range, may be recorded on this certificate.

A. Description of original monument and accessories and/or subsequent restoration:

1817 Beech (no size)	G.L.O.	W. Preston	N/A	Notes
1973 1/2" Bar	L.C.R.C.	H. Avey	#15396	L2522 P271
1987 N/A	Survey	W. Soderberg	#17635	L4421 P853

B. Description of corner evidence found and/or method applied in restoring or reestablishing corner:

A 1/2" iron rod in a monument box in asphalt pavement marks this corner. All witness ties from L.C.R.C. L2522 P271 do not exist.

Field measurements were made between the following corners:

H-11 to G-11	2670.41	meas.		
	2633.40	G.L.O. Notes		
	2670.37	rec.	L4421 P853	Survey
H-11 to I-11	2672.57	meas.		
	2633.40	G.L.O. Notes		
	2672.56	rec.	L4421 P853	Survey

ACCEPTED BY THE MACOMB COUNTY SURVEY PEER GROUP AS THE OFFICIAL CORNER UNDER MICHIGAN PUBLIC ACT 345 OF 1990 AT A MEETING HELD ON 9-27-94

William E. Soderberg
WILLIAM E. SODERBERG, P.S., CHAIRMAN

C. Description of monument for corner and accessories established to perpetuate locating the position of the corner:

I replaced the 1/2" iron rod with a 3/4" x 24" iron rod with 2" diameter aluminum cap stamped "Macomb County Monument MI Act 345 #26459", in an existing monument box.

N.79° W.	164.83'	P.K. nail and remon. tag in U-pole
S.42° W.	154.54'	N.W. corner brick garage
S.42° E.	89.03'	P.K. nail and remon. tag 8" tree
S.01° E.	65.73'	P.K. nail and remon. tag in U-pole

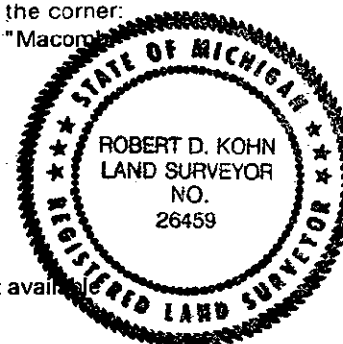

The selected location is accepted by me and generally accepted by Professional Surveyors as the best available evidence of the position of the original corner.

Signed by Robert D. Kohn Date November 9, 1994

Surveyor's Michigan License No. 26459