

REMONUMENTATION

APR 28 1995

COMMISSION

C150801

LAND CORNER RECORDATION CERTIFICATE
Filing Requirement of Act 74, Mich. P.A. 1970

LIBER 6523 PAGE 948

For corners in Macomb

Macomb Twp.

94 DEC -9 PM 2:50

CARMELO SABAUGH
REGISTER OF DEEDS
MACOMB COUNTY, MI

Table with columns: Located In: (3N, 13E), Corner Code: # (I-11), and rows for Public Land Survey, Property Controlling in Section, and Miscellaneous Property in Sec.

Register of Deeds Stamp & File Number

4. Lot No. , Recorded Plat
5. Private Claims

Robert D. Kohn

August 20

94

I, in a field survey on do hereby certify that under requirements of P.A. 74, Michigan P.A. of 1970, the corner points mentioned in lines 1 and 2 above were in conformance with regulations and rules therefore as required in the current manual of survey instructions of the United States Department of the Interior, Bureau of Land Management or by a decree of a Court of Law and/or that the corner points mentioned in lines 3, 4 and 5 above were in conformance with the rules of the Michigan Board of Land Surveyors or by a Decree of a Court of Law, established, re-established, monumented, re-monumented, recovered, found as expressed below:

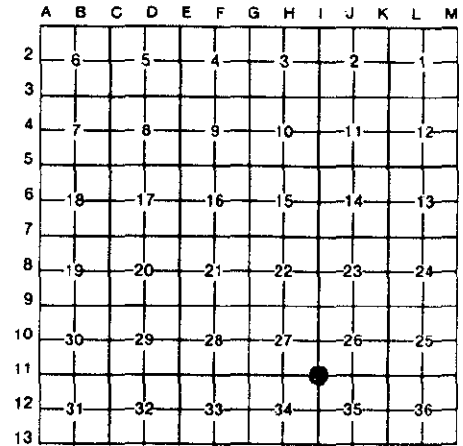

NOTE: Not more than 4 corners, all in the same town and range, may be recorded on this certificate.

A. Description of original monument and accessories and/or subsequent restoration:

Table with columns: Date (1817, 1988, 1987), Monument Type (Post, Iron rod, N/A), Surveyor (W. Preston, M. Dunn, W. Soderberg), Notes (#30081, #17635), and File Numbers (L4484 P576, L4421 P849).

B. Description of corner evidence found and/or method applied in restoring or reestablishing corner:

A 1/2" iron rod in a monument box in asphalt pavement marks this corner. The following witness ties were used to recover and verify its position:

1 tie from L.C.R.C. L4484 P576

Field measurements were made between the following corners:

Table with columns: Corner Pair (H-11 to I-11, I-11 to I-12, I-11 to I-10), Distance (e.g., 2672.57, 2633.4), Measurement Type (meas., G.L.O., rec.), and Reference (L4421 P849, L6372 P718, L38 P3, Real estate atlas).

ACCEPTED BY THE MACOMB COUNTY SURVEY PEER GROUP AS THE OFFICIAL CORNER UNDER MICHIGAN PUBLIC ACT 345 OF 1990 AT A MEETING HELD ON 9-27-94. WILLIAM E. SODERBERG, P.S. CHAIRMAN

C. Description of monument for corner and accessories established to perpetuate locating the position of the corner:

I replaced the 1/2" iron rod with a 3/4" x 24" iron rod with 2" diameter aluminum cap stamped "Macomb County Monument MI Act 345 #26459" in an existing monument box.

Table with columns: Angle (N.29° E, N.24° W, S.37° W, S.68° E), Distance (66.11', 69.70', 75.97', 164.57'), and Monument Type (P.K. nail and remon. tag in U-pole).

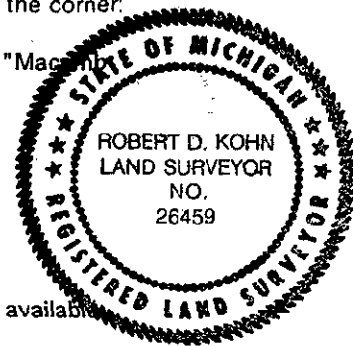

The selected location is accepted by me and generally accepted by Professional Surveyors as the best available evidence of the position of the original corner.

Signed by Robert D. Kohn
Surveyor's Michigan License No. 26459

Date November 9, 1994