

SURVEY & REMONUMENTATION

APR 29 1996

COMMISSION

LAND CORNER RECORDATION CERTIFICATE Filing Requirement of Act 74, Mich. P.A. 1970

For corners in Macomb
(County)

Located In: Macomb Twp. Corner Code # _____

- | | | | | | |
|--------------------------------------|---|-----------|---|------------|-------------|
| 1. Public Land Survey | T | <u>3N</u> | R | <u>13E</u> | <u>J-11</u> |
| | T | _____ | R | _____ | _____ |
| | T | _____ | R | _____ | _____ |
| | T | _____ | R | _____ | _____ |
| 2. Property Controlling in Section | S | _____ | T | _____ | R |
| | S | _____ | T | _____ | R |
| 3. Miscellaneous Property in Section | S | _____ | T | _____ | R |
| | S | _____ | T | _____ | R |
4. Lot No. _____, Recorded Plat _____
5. Private Claims _____

Register of Deeds Stamp & File Number

A	B	C	D	E	F	G	H	I	J	K	L	M
2	6	5	4	3	2	1						
3												
4	7	8	9	10	11	12						
5												
6	18	17	16	15	14	13						
7												
8	19	20	21	22	23	24						
9												
10	30	29	28	27	26	25						
11												
12	31	32	33	34	35	36						
13												

I, Robert D. Kohn, in a field survey on July 6, 1995, do hereby certify that under requirements of P.A. 74, Michigan P.A. of 1970, the corner points mentioned in lines 1 and 2 above were in conformance with regulations and rules therefore as required in the current manual of survey instructions of the United States Department of the Interior, Bureau of Land Management or by a decree of a Court of Law and/or that the corner points mentioned in lines 3, 4 and 5 above were in conformance with the rules of the Michigan Board of Professional Surveyors or by a Decree of a Court of Law; established, re-established, monumented, re-monumented, recovered, found as expressed below:

NOTE: Not more than 4 corners, all in the same town and range, may be recorded on this certificate.

A. Description of original monument and accessories and/or subsequent restoration:

					Notes
1817	Post	G.L.O.	W. Preston	N/A	
1988	1/2" Iron rod	L.C.R.C.	M. Dunn	#30081	L4484 P576
1988	1/2" Iron rod	Survey	S. Dunn	#28408	L4484 P579
1989	1/2" Iron rod	L.C.R.C.	M. Dunn	#30081	L4687 P328
1994	1/2" Iron in monument box	L.C.R.C.	S. Money	#30092	L6185 P585
1995	1/2" Iron in mon. box	M.C.R.C.	R. Campbell	n/a	File No. 134

B. Description of corner evidence found and/or method applied in restoring or reestablishing corner:

A 1/2" iron rod in an existing monument box 3' ± north of the centerline of an asphalt road currently occupies this corner. An apparent tree and brush line extends to the south from this corner. The following witness ties were used to recover and verify its position:
 3 ties match L.C.R.C. L6185 P585
 3 ties match M.C.R.C. File No. 134

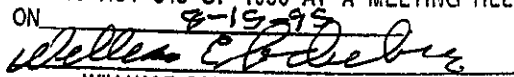
ACCEPTED BY THE MACOMB COUNTY SURVEY PEER GROUP AS THE OFFICIAL CORNER UNDER MICHIGAN PUBLIC ACT 345 OF 1990 AT A MEETING HELD ON 8-19-95

 WILLIAM E. SODERBERG, P.S., CHAIRMAN

Field measurements were made between the following corners:

I-11 to J-11	2704.10	meas.	
	2663.76	rec.	G.L.O.
J-11 to K-11	2692.32	meas.	
	2663.76	rec.	G.L.O.
	2692.38	rec.	M.C.R.C.

#38953A, Sheet 2

C. Description of monument for corner and accessories established to perpetuate locating the position of the corner:

I replaced the 1/2" iron rod with a 3/4" x 24" iron rod with a 2" diameter aluminum cap stamped "Macomb County Monument MI Act 345 #26459" in an existing monument box in asphalt pavement.

N.55° W.	29.95'	P.K. nail and M.C.R. tag in top guard rail post
N.40° E.	26.66'	P.K. nail and tag #30092 in most N.E. guard rail post
S.40° E.	33.45'	P.K. nail and tag #30092 in most S.E. guard rail post
S.55° W.	104.42'	P.K. nail and tag #30092 in N.W. face utility pole

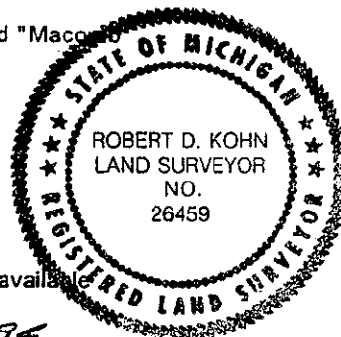

The selected location is accepted by me and generally accepted by Professional Surveyors as the best available evidence of the position of the original corner.

Signed by Robert D. Kohn

Date Dec 11, 1995

Surveyor's Michigan License No. 26459

FORM APPROVED BY MICHIGAN STATE BOARD OF PROFESSIONAL SURVEYORS, JAN. 28, 1971
 REVISED MAY 14, 1975
 REVISED JAN., 1983