

SURVEY & REMONUMENTATION

APR 29 1996

COMMISSION

LAND CORNER RECORDATION CERTIFICATE

Filing Requirement of Act 74, Mich. P.A. 1970

For corners in Macomb
(County)

Located In: Macomb Twp. Corner Code #

	3N	13E	K-5
1. Public Land Survey	T _____	R _____	_____
	T _____	R _____	_____
	T _____	R _____	_____
	T _____	R _____	_____
2. Property Controlling in Section	S _____	T _____	R _____
	S _____	T _____	R _____
3. Miscellaneous Property in Section	S _____	T _____	R _____
	S _____	T _____	R _____

Register of Deeds Stamp & File Number

4. Lot No. _____, Recorded Plat _____
5. Private Claims _____

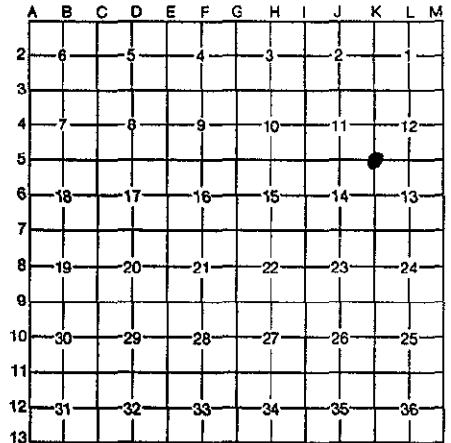

I, Robert D. Kohn, in a field survey on July 1, 1995, do hereby certify that under requirements of P.A. 74, Michigan P.A. of 1970, the corner points mentioned in lines 1 and 2 above were in conformance with regulations and rules therefore as required in the current manual of survey instructions of the United States Department of the Interior, Bureau of Land Management or by a decree of a Court of Law and/or that the corner points mentioned in lines 3, 4 and 5 above were in conformance with the rules of the Michigan Board of Professional Surveyors or by a Decree of a Court of Law; established, re-established, monumented, re-monumented, recovered, found as expressed below:

NOTE: Not more than 4 corners, all in the same town and range, may be recorded on this certificate.

A. Description of original monument and accessories and/or subsequent restoration:

	G.L.O.	W. Preston	N/A	Notes
1817 Post	G.L.O.	W. Preston	N/A	File No. R-12, 55
1929 1" Solid iron	M.C.R.C.	N/A	N/A	L2317 P188, P185
1972 1" pipe	L.C.R.C./Survey	R. Smith	#16052	L2910 P147, P748
1978 P.K. nail	Survey	G. James	#19835	L3023 P330
1978 Found pipe	Survey	R. Smith	#16052	L3168 P960
1979 Found pipe	Survey	R. Smith	#16052	L3239 P345
1980 Found pipe	Survey	R. Kreger	#24601	

SEE REVERSE SIDE OF THIS SHEET

B. Description of corner evidence found and/or method applied in restoring or reestablishing corner:

An existing monument box with 1" pipe in asphalt pavement currently marks this corner at the intersection of 24 Mile Road and North Avenue. The following witness ties were used to recover and verify its position:
 2 ties match L.C.R.C./Survey L2317 P188, P185; L3023 P330; L3168 P960
 3 ties match Survey L2910 P147, P148
 3 ties match L.C.R.C./Survey L4077 P537, P548; L4729 P144; L5969 P118
 3 ties match Survey L3590 P347, P771 - P777
 3 ties match Survey L5925 P74

Field measurements were made between the following corners:

J-5 to K-5	2751.90	meas.	
	2709.96	G.L.O.	
	2752.00	rec.	Survey L4077 P537, P548; L4621 P458

SEE REVERSE SIDE OF THIS SHEET

C. Description of monument for corner and accessories established to perpetuate locating the position of the corner:

I replaced the 1" pipe in an existing monument box in asphalt pavement with a 3/4" x 24" iron rod with a 2" diameter aluminum cap stamped "Macomb County Monument MI Act 345 #26459".

N.45° E.	41.34'	P.K. nail and M.C.R. tag in S.E. face utility pole
N.45° W.	41.13'	P.K. nail and M.C.R. tag in N.E. face utility pole
S.35° W.	80.99'	Found P.K. nail S.E. face 16" poplar
S.20° W.	105.65'	Found P.K. nail w/washer N.W. face utility pole
S.30° E.	77.23'	Centerline top nut fire hydrant

The selected location is accepted by me and generally accepted by Professional Surveyors as the best available evidence of the position of the original corner.

Signed by Robert D. Kohn
Surveyor's Michigan License No. 26459

Date Dec. 11, 1995

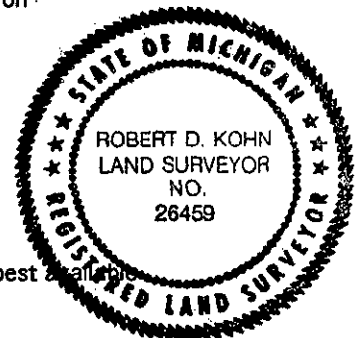

ACCEPTED BY THE MACOMB COUNTY SURVEY PEER GROUP AS THE OFFICIAL CORNER UNDER MICHIGAN PUBLIC ACT 345 OF 1890 AT A MEETING HELD ON 8-15-95
WILLIAM E. SODERBERG, P.S., CHAIRMAN

A. Description of original monument and accessories and/or subsequent restoration: (continued)

1983	Found pipe	Survey	G. Kattouah	#14095	L3590 P347
1985	Found iron	Survey	G. Kattouah	#14095	L3795 P771 - P777
1986	3/4" iron bar	L.C.R.C./Survey	D. King	#30085	L4077 P537, P548
1988	3/4" iron bar	Survey	D. King	#30085	L4621 P458
1989	3/4" pipe	Survey	D. King	#30085	L4729 P144
1992	3/4" pipe	Survey	D. King	#30085	L5969 P118
1993	1/4" iron inside pipe	Survey	R. Stecker	#30103	L5925 P74

B. Description of corner evidence found and/or method applied in restoring or reestablishing corner: (continued)

K-5 to L-5	2681.05	meas.		
	2658.40	G.L.O.		
	2681.00	rec.	Survey	L3239 P345
K-5 to K-6	2681.11	rec.	Survey	L3609 P521
	2677.20	meas.		
	2640.00	G.L.O.		
	2676.90	rec.	Survey	L2317 P185; L3023 P330
	2676.96	rec.	Survey	L3239 P345
	2677.53	rec.	Survey	L3590 P347 & L3795 P771 - 777
	2676.89	rec.	Survey	L5969 P118