

APR 29 1995

COMMISSION

LAND CORNER RECORDATION CERTIFICATE
Filing Requirement of Act 74, Mich. P.A. 1970

For corners in Macomb (County)

Located In: Macomb Twp. Corner Code #

- 1. Public Land Survey T 3N R 13E K-8
2. Property Controlling in Section S T R
3. Miscellaneous in Section S T R

Register of Deeds Stamp & File Number

- 4. Lot No. , Recorded Plat
5. Private Claims

I, Robert D. Kohn, in a field survey on July 1, 1995, do hereby certify that under requirements of P.A. 74, Michigan P.A. of 1970, the corner points mentioned in lines 1 and 2 above were in conformance with regulations and rules therefore as required in the current manual of survey instructions of the United States Department of the Interior, Bureau of Land Management or by a decree of a Court of Law and/or that the corner points mentioned in lines 3, 4 and 5 above were in conformance with the rules of the Michigan Board of Professional Surveyors or by a Decree of a Court of Law; established, re-established, monumented, re-monumented, recovered, found as expressed below:

Grid table with columns A-L and rows 2-13. A dot is present at the intersection of column J and row 8.

NOTE: Not more than 4 corners, all in the same town and range, may be recorded on this certificate.

A. Description of original monument and accessories and/or subsequent restoration:

Table with 5 columns: Year, Description, G.L.O., Name, and Notes. Includes entries for 1817 Post, 1975 n/a, 1975 Found 3/4" Iron bar, 1983 3/4" Iron bar in monument box, and 1987 3/4" Iron bar in monument box.

B. Description of corner evidence found and/or method applied in restoring or reestablishing corner:

A 3/4" iron bar in a monument box in asphalt pavement currently occupies this corner. A fence line extends west from this position. The following witness ties were used to verify and recover its position: 2 ties match L.C.R.C. L2590 P348, 2 ties match Survey L3705 P61; L4306 P708, 2 ties match M.C.R.C. File No. 102

Field measurements were made between the following corners:

Table with 4 columns: Corner pair, Distance, Measurement type, and Reference. Includes K-8 to K-7 and K-8 to K-9.

C. Description of monument for corner and accessories established to perpetuate locating the position of the corner:

I replaced the 3/4" iron bar in an existing monument box in asphalt pavement with a 3/4" x 24" iron bar with a 2" diameter aluminum cap stamped "Macomb County Monument MI Act 345 #26459".

Table with 3 columns: Direction and Distance, and Description of monument. Includes Due W. 32.10', N.60° E. 33.10', S.75° E. 98.40', and S.50° W. 82.13'.

The selected location is accepted by me and generally accepted by Professional Surveyors as the best available evidence of the position of the original corner.

Signed by Robert D. Kohn

Date Dec. 11, 1995

Surveyor's Michigan License No. 26459

FORM APPROVED BY MICHIGAN STATE BOARD OF PROFESSIONAL SURVEYORS, JAN. 28, 1971 REVISED MAY 14, 1975 REVISED JAN., 1983

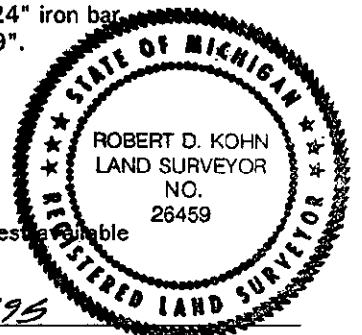

ACCEPTED BY THE MACOMB COUNTY SURVEYOR BEER GROUP AS THE OFFICIAL CORNER UNDER MICHIGAN PUBLIC ACT 345 OF 1990 AT A MEETING HELD ON 8-15-95 WILLIAM E. SODERBERG, P.S., CHAIRMAN