

APR 29 1995

COMMISSION

LAND CORNER RECORDATION CERTIFICATE
Filing Requirement of Act 74, Mich. P.A. 1970

For corners in Macomb
 (County)

Located In: Macomb Twp. Corner Code #

- | | | | | |
|--------------------------------------|---|-------|-----|-------|
| | | 3N | 13E | K-9 |
| 1. Public Land Survey | T | _____ | R | _____ |
| | T | _____ | R | _____ |
| | T | _____ | R | _____ |
| | T | _____ | R | _____ |
| 2. Property Controlling in Section | S | _____ | T | _____ |
| | S | _____ | T | _____ |
| 3. Miscellaneous Property in Section | S | _____ | T | _____ |
| | S | _____ | T | _____ |
4. Lot No. _____, Recorded Plat _____
 5. Private Claims _____

Register of Deeds Stamp & File Number

| A | B | C | D | E | F | G | H | I | J | K | L | M |
|----|----|----|----|----|----|----|---|---|---|---|---|---|
| 2 | 6 | 5 | 4 | 3 | 2 | 1 | | | | | | |
| 3 | | | | | | | | | | | | |
| 4 | 7 | 8 | 9 | 10 | 11 | 12 | | | | | | |
| 5 | | | | | | | | | | | | |
| 6 | 13 | 17 | 16 | 15 | 14 | 13 | | | | | | |
| 7 | | | | | | | | | | | | |
| 8 | 19 | 20 | 21 | 22 | 23 | 24 | | | | | | |
| 9 | | | | | | | | | | | | |
| 10 | 30 | 29 | 28 | 27 | 26 | 25 | | | | | | |
| 11 | | | | | | | | | | | | |
| 12 | 31 | 32 | 33 | 34 | 35 | 36 | | | | | | |
| 13 | | | | | | | | | | | | |

I, Robert D. Kohn, in a field survey on July 1, 1995, do hereby certify that under requirements of P.A. 74, Michigan P.A. of 1970, the corner points mentioned in lines 1 and 2 above were in conformance with regulations and rules therefore as required in the current manual of survey instructions of the United States Department of the Interior, Bureau of Land Management or by a decree of a Court of Law and/or that the corner points mentioned in lines 3, 4 and 5 above were in conformance with the rules of the Michigan Board of Professional Surveyors or by a Decree of a Court of Law; established, re-established, monumented, re-monumented, recovered, found as expressed below:

NOTE: Not more than 4 corners, all in the same town and range, may be recorded on this certificate.

A. Description of original monument and accessories and/or subsequent restoration:

| | | | | |
|---|-----------------|------------|--------|--------------------|
| 1817 Post | G.L.O. | W. Preston | N/A | Notes |
| 1929 1" Solid iron | M.C.R.C. | N/A | N/A | File No. R-12, 107 |
| 1988 Set R.R. spike in asphalt pavement | L.C.R.C. Survey | M. Dunn | #30081 | L4484 P575 |
| 1988 Set R.R. spike | Survey | S. Dunn | #28408 | L4484 P579 |

B. Description of corner evidence found and/or method applied in restoring or reestablishing corner:

A railroad spike in asphalt pavement currently occupies this corner. The following witness ties were used to verify and recover its position:

- 3 ties match L.C.R.C. L4484 P575
- 3 ties match Survey L4484 P579

Field measurements were made between the following corners:

| | | | | |
|-------------|-------------------------|-------|--------|------------|
| J-9 to K-9 | 2751.90 | meas. | | |
| | G.L.O. notes incomplete | | | |
| | 2752.09 | rec. | Survey | L4484 P579 |
| K-9 to K-8 | 2669.70 | meas. | | |
| | 2640.00 | rec. | G.L.O. | |
| K-9 to L-9 | 2696.84 | meas. | | |
| | 2663.10 | rec. | G.L.O. | |
| K-9 to K-10 | 2654.67 | meas. | | |
| | 2640.00 | rec. | G.L.O. | |
| | 2654.80 | rec. | Survey | L4484 P579 |

C. Description of monument for corner and accessories established to perpetuate locating the position of the corner:

I replaced the railroad spike in asphalt pavement with a 3/4" X 24" iron bar with a 2" diameter aluminum cap stamped "Macomb County Monument MI Act 345 #26459" in an new monument box.

- N.45° E. 44.87' P.K. nail and M.C.R. tag in N.W. face 8" Maple
- N.85° E. 33.46' P.K. nail and tag #23505 S. face utility pole
- S.45° W. 43.81' P.K. nail and M.C.R. tag in N.W. face 12" Cottonwood
- N.85° W. 33.70' P.K. nail and M.C.R. tag in S. face utility pole

The selected location is accepted by me and generally accepted by Professional Surveyors as the best available evidence of the position of the original corner.

Signed by Robert D. Kohn
 Surveyor's Michigan License No. 26459

Date DEC. 11, 1995

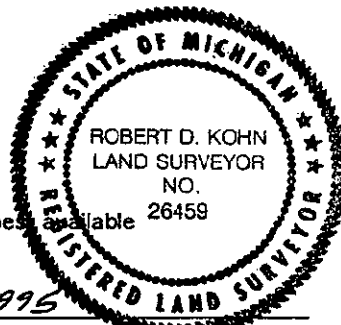

ACCEPTED BY THE MACOMB COUNTY SURVEY PEER GROUP AS THE OFFICIAL CORNER UNDER MICHIGAN PUBLIC ACT 345 OF 1990 AT A MEETING HELD ON 8-15-95
 WILLIAM E. SODERBERG, P.S., CHAIRMAN