

APR 29 1996

COMMISSION

LAND CORNER RECORDATION CERTIFICATE
Filing Requirement of Act 74, Mich. P.A. 1970

For corners in Macomb Located In: Macomb Twp. Corner Code #
 (County)

- 1. Public Land Survey T 3N R 13E K-10
 T _____ R _____
 T _____ R _____
 T _____ R _____
- 2. Property Controlling S _____ T _____ R _____
 in Section S _____ T _____ R _____
- 3. Miscellaneous S _____ T _____ R _____
 Property in Section S _____ T _____ R _____

Register of Deeds Stamp & File Number

- 4. Lot No. _____, Recorded Plat _____
- 5. Private Claims _____

A	B	C	D	E	F	G	H	I	J	K	L	M
2	6		5		4		3		2		1	
3												
4	7		8		9		10		11		12	
5												
6	18		17		16		15		14		13	
7												
8	19		20		21		22		23		24	
9												
10	30		29		28		27		26		25	
11												
12	31		32		33		34		35		36	
13												

I, Robert D. Kohn, in a field survey on July 1, 1995, do hereby certify that under requirements of P.A. 74, Michigan P.A. of 1970, the corner points mentioned in lines 1 and 2 above were in conformance with regulations and rules therefore as required in the current manual of survey instructions of the United States Department of the Interior, Bureau of Land Management or by a decree of a Court of Law and/or that the corner points mentioned in lines 3, 4 and 5 above were in conformance with the rules of the Michigan Board of Professional Surveyors or by a Decree of a Court of Law; established, re-established, monumented, re-monumented, recovered, found as expressed below:

NOTE: Not more than 4 corners, all in the same town and range, may be recorded on this certificate.

A. Description of original monument and accessories and/or subsequent restoration:

1817	10" Elm	G.L.O.	W. Preston	N/A	Notes	
1975	N/A	M.C.R.C.	E. Rivard	N/A		File No. 128
1987	1" Iron bar in mon box	Survey	D. King	#30085		L4306 P713
1988	1-1/2" Iron bar in mon. box	Survey	S. Dunn	#28408		L4484 P579
1988	1-1/2" Iron bar in mon. box	L.C.R.C.	M. Dunn	#30081		L4484 P577
1989	1-1/2" Iron bar in mon. box	L.C.R.C.	M. Dunn	#30081		L4687 P328
1990	1" bar in mon. box	L.C.R.C.	H. Avey	#15396		L4795 P488
1995	1" Iron in mon. box	M.C.R.C.	R. Campbell	N/A		File No. 128

B. Description of corner evidence found and/or method applied in restoring or reestablishing corner:

A 1" iron bar in a monument box in asphalt pavement currently marks this corner. The following witness ties were used to verify and recover its position:

- 1 tie matches Survey L4306 P713
- 3 ties match Survey L4484 P579
- 3 ties match L.C.R.C. L4484 P577
- 3 ties match L.C.R.C. L4687 P328
- 3 ties match L.C.R.C. L4795 P488
- 2 ties match M.C.R.C. File No. 128

ACCEPTED BY THE MACOMB COUNTY SURVEY PROFESSIONAL GROUP AS THE OFFICIAL CORNER UNDER MICHIGAN PUBLIC ACT 345 OF 1990 AT A MEETING HELD ON 8-15-95

William E. Soderberg
 WILLIAM E. SODERBERG, P.S., CHAIRMAN

Field measurements were made between the following corners:

K-9 to K-10	2654.67	meas.		
	2640.00	rec.	G.L.O.	
	2654.80	rec.	Survey	L4484 P579
K-10 to K-11	2665.24	meas.		
	2640.00	rec.	G.L.O.	
	2665.15	rec.	M.C.R.C.	#38953A Sheet 2

C. Description of monument for corner and accessories established to perpetuate locating the position of the corner:

I replaced the 1" iron bar with a 3/4" x 24" iron rod with a 2" diameter aluminum cap stamped "Macomb County Monument MI Act 345 #26459" in an existing monument box.

N.45° E.	44.67'	Nail and M.C.R. tag in N.W. face utility pole
S.87° W.	53.31'	P.K. nail and M.C.R. tag in N.W. face utility pole
S.40° W.	55.73'	P.K. nail and M.C.R. tag in S.E. face 16" Elm
S.30° W.	83.75'	P.K. nail and M.C.R. tag S.E. face 20" Maple

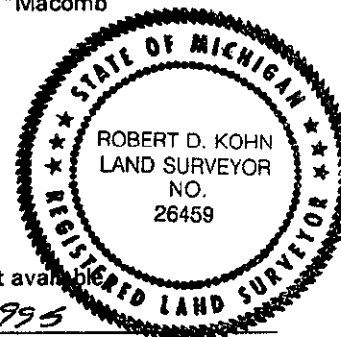

The selected location is accepted by me and generally accepted by Professional Surveyors as the best available evidence of the position of the original corner.
 Signed by [Signature] Date DEC 11, 1995

Surveyor's Michigan License No. 26459 FORM APPROVED BY MICHIGAN STATE BOARD OF PROFESSIONAL SURVEYORS, JAN. 28, 1971
 REVISED MAY 14, 1975
 REVISED JAN., 1983