

**SURVEY &
REMONUMENTATION**

C0158335 LIBER:06543 PAGE:357 08:35A 01/05/1995
APR 28 1995 ARMELLA SABAUGH-MACOMB COUNTY, MI REG/DEEDS

COMMISSION

**LAND CORNER RECORDATION CERTIFICATE
Filing Requirement of Act 74, Mich. P.A. 1970**

For corners in

<u>MACOMB</u> (County)	Located In: CHESTERFIELD TOWNSHIP	Corner Code # <u> </u>
1. Public Land Survey	T <u>3N</u> R <u>14E</u>	<u>A-3</u>
	T <u> </u> R <u> </u>	<u> </u>
	T <u> </u> R <u> </u>	<u> </u>
	T <u> </u> R <u> </u>	<u> </u>
2. Property Controlling in Section	S <u> </u> T <u> </u> R <u> </u>	<u> </u>
	S <u> </u> T <u> </u> R <u> </u>	<u> </u>
3. Miscellaneous Property in Sec.	S <u> </u> T <u> </u> R <u> </u>	<u> </u>
	S <u> </u> T <u> </u> R <u> </u>	<u> </u>

Register of Deeds Stamp & File Number

4. Lot No. , Recorded Plat
5. Private Claims

I, CRAIG P. AMEY, in a field survey on AUGUST 25, 19 94 do hereby certify that under requirements of P.A. 74, Michigan P.A. of 1970, the corner points mentioned in lines 1 and 2 above were in conformance with regulations and rules therefore as required in the current manual of survey instructions of the United States Department of the Interior, Bureau of Land Management or by a decree of a Court of Law and /or that the corner points mentioned in lines 3, 4 and 5 above were in conformance with the rules of the Michigan Board of Land Surveyors or by a Decree of a Court of Law; established, re-established, monumented, re-monumented, recovered, found as expressed below:

A	B	C	D	E	F	G	H	I	J	K	L	M
1												
2	6	5	4	3	2	1						
3												
4	7	8	9	10	11	12						
5												
6	18	17	16	15	14	13						
7												
8	19	20	21	22	23	24						
9												
10	30	29	28	27	26	25						
11												
12	31	32	33	34	35	36						
13												

NOTE: Not more than 4 corners, all in the same town and range, may be recorded on this certificate.

A. Description of original monument and accessories and/or subsequent restoration:

1817 G.L.O. Pages 55-57	William Preston	No witnesses found
1979 LCRC Liber 3168 Page 267	John R Fenn, #23505	Found, 1/2" rerod
1979 LCRC Liber 3179 Page 738	William E Soderberg, #17635	Found, 1/2" rerod
1983 LCRC Liber 3465 Page 178	Herbert J. Kobs, #14097	Found, 1/2" iron bar w/cap #5557
1989 LCRC Liber 0487 Page 333	Martin C. Dunn, #30081	Found, 1/2" iron rod

Corner is common to M-3 T3N, R13E

B. Description of corner evidence found and/or method applied in restoring or reestablishing corner:
Found: 1/2" rebar with damaged cap, 0.3' below the surface of twenty five mile road (gravel)
This corner verified by: found and matched existing witnesses

1979 LCRC Liber 3168 Page 267	Found, 1/2 Rerod
25.79' South	Found, Pk nail in fence post
65.25' Southwest	Found, Pk nail in d.e. Pole
41.73' W/southwest	Found, Pk nail in 6" ash
44.00' Northwest	Found, Pk nail in d.e. Pole
1979 LCRC Liber 3179 Page 738	Found, 1/2" rerod
43.99' Northwest	Found, Pk nail in southwest face of d.e. Pole
65.28' Southwest	Found, Pk nail in southeast face of d.e. Pole
25.80' South	Found, Pk nail in west face fence post
1989 LCRC Liber 4687 Page 333	Found, 1/2" rerod
43.99' Northwest	Found, Pk nail in southwest face of d.e. Pole
65.28' Southwest	Found, Pk nail in southeast face of d.e. Pole
25.80' South	Found, Pk nail in west face fence post

ACCEPTED BY THE MACOMB COUNTY SURVEY PEEER GROUP AS THE OFFICIAL CORNER UNDER MICHIGAN PUBLIC ACT 345 OF 1990 AT A MEETING HELD ON 9-27-94
William E. Soderberg
WILLIAM E. SODERBERG, P.S., CHAIRMAN

C. Description of monument for corner and accessories established to perpetuate locating the position of the corner:

Replaced 1/2" rerod with a 3/4" x 24" iron and a Macomb County Remonumentation cap stamped:
"MACOMB COUNTY MONUMENT", "34970", "MI ACT 345"

S 25.84'	PK and MCR tag in the west side of a fence post
SW 65.29'	PK and MCR tag in the east face of a DE pole.
WSW 41.64'	PK and MCR tag in the southeast side of a triple 8" ash
NW 44.00'	PK and MCR tag in the southwest face of a DE pole

The selected location is accepted by me and is generally accepted by Professional Surveyors as the best available evidence of the position of the original corner

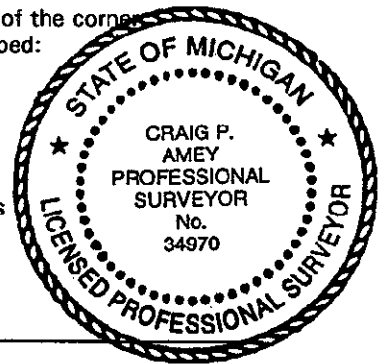

Signed by *C. Amey* Date 12-15-94
Surveyor's Michigan License No. 34970