

LAND CORNER RECORDATION CERTIFICATE
Filing Requirement of Act 74, Mich. P.A. 1970

SURVEY &
RECORDATION
DOCUMENTATION

For corners in

<u>Macomb</u> (County)	Located In: Ray Twp	Corner Code #
1. Public Land Survey	T <u>4N</u> R <u>13E</u>	<u>E-13</u>
	T _____ R _____	_____
	T _____ R _____	_____
	T _____ R _____	_____
2. Property Controlling in Section	S _____ T _____ R _____	_____
	S _____ T _____ R _____	_____
3. Miscellaneous Property in Sec.	S _____ T _____ R _____	_____
	S _____ T _____ R _____	_____

APR 20 2000

SECTION

ACCEPTED BY THE MACOMB COUNTY SURVEY PEER GROUP AS THE OFFICIAL CORNER UNDER MICHIGAN PUBLIC ACT 345 OF 1990 AT A MEETING HELD ON 7-23-96
William E. Soderberg
WILLIAM E. SODERBERG, P.S., CHAIRMAN
Register of Deeds Stamp & File Number

4. Lot No. _____, Recorded Plat _____

5. Private Claims _____

I, Robert D. Kohn, in a field survey on November 30, 1996 do hereby state that under requirements of P.A. 74, Michigan P.A. of 1970, the corner points mentioned in lines 1 and 2 above were in conformance with regulations and rules therefore as required in the current manual of survey instructions of the United States Department of the Interior, Bureau of Land Management or by a decree of a Court of Law and /or that the corner points mentioned in lines 3, 4 and 5 above were in conformance with the rules of the Michigan Board of Land Surveyors or by a Decree of a Court of Law; established, re-established, monumented, recovered, found as expressed below:

NOTE: Not more than 2 corners, all in the same town and range, may be recorded on this certificate.

1	A	B	C	D	E	F	G	H	I	J	K	L	M
2		6		5		4		3		2		1	
3													
4		7		8		9		10		11		12	
5													
6		18		17		16		15		14		13	
7													
8		19		20		21		22		23		24	
9													
10		30		29		28		27		26		25	
11													
12		31		32		33		34		35		36	
13													

A. Description of original monument and accessories and/or subsequent restoration:

1817	Post	W. Preston	N/A	G.L.O. Notes
1977	Mon. box in pavement	J. Barnes	#13616	Survey L2846
P869				
1988	Mon. box in pavement (unable to open)	H. Avey	#15396	L.C.R.C. L4353 P443
1989	3/4" pipe in monument box	H. Kobs	#14097	L.C.R.C. L4729 P129
1989	3/4" pipe in monument box	H. Kobs	#14097	Survey L4729 P137

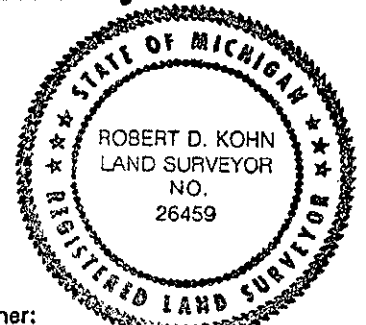

B. Description of corner evidence found and/or method applied in restoring or reestablishing corner:

A 3/4" pipe in an existing monument box in asphalt pavement is currently occupying this position. A tree line with wood and wire fence extends to the north from this corner. The following witness ties were used to recover and verify its position.

3 ties match witnesses L4353 P443 L.C.R.C.
L4729 P129 L.C.R.C.
L4729 P137 Survey

Field measurements were observed between the following corners:

D-13 to E-13	2666.13' meas.	E-13 to F-13	2699.25 meas.	E-1 to E-13	95.33 meas.
	2640.00' rec. G.L.O.		2640.00 rec. G.L.O.		100.32 rec G.L.O.
	2665.90' rec. survey L4729 P137		2699.09 rec. LCRC		95.33 rec L.C.R.C. L4729 P129
	2665.55' rec. survey L2846 P869		L4353 P443		95.36 rec. L.C.R.C. L4353 P443

C. Description of monument for corner and accessories established to perpetuate locating the position of the corner:

I replaced the 3/4" pipe with a 3/4" x 24" iron rod and placed a 2" diameter aluminum cap stamped "Macomb County MI Act 345 #26459" in the existing monument box in asphalt pavement. Witness ties are as follows:

Due West	95.33'	Mac. Co. remon. cap & iron #26459 in mon. box (E-1) Macomb Twp.
N87°E.	84.95'	P.K. nail and Mac. Co. remon. washer in S.E. face U-pole
S42°W.	92.91'	P.K. nail and Mac. Co. remon. washer in S.E. face U-pole
N57°W.	99.35'	P.K. nail and tag #17623 in N.E. face U-pole

The selected location is accepted by me and generally accepted by Professional Surveyors as the best available evidence of the position of the original corner.

Signed by Robert D. Kohn

Date November 30, 1996

Surveyor's Michigan License No. #26459