

APR 29 1996

COMMISSION

LAND CORNER RECORDATION CERTIFICATE
 Filing Requirement of Act 74, Mich. P.A. 1970

For corners in Macomb (County) Located In: Bruce Township Corner Code # _____

1. Public Land Survey	T	<u>5N</u>	R	<u>12E</u>	<u>I-10</u>
	T		R		
	T		R		
	T		R		
2. Property Controlling in Section	S		T	R	
	S		T	R	
3. Miscellaneous Property in Section	S		T	R	
	S		T	R	

Register of Deeds Stamp & File Number

4. Lot No. _____, Recorded Plat _____
 5. Private Claims _____

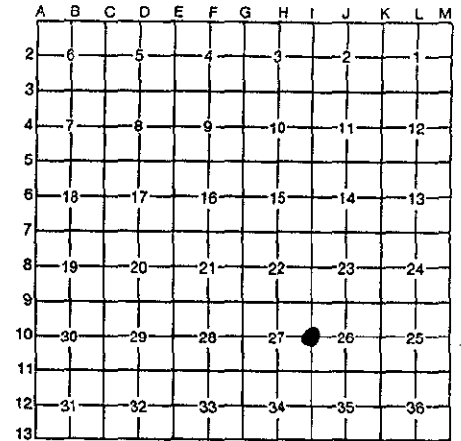

I, James E. Kovas, PE, PS, in a field survey on May 16, 19 95, do hereby certify that under requirements of P.A. 74, Michigan P.A. of 1970, the corner points mentioned in lines 1 and 2 above were in conformance with regulations and rules therefore as required in the current manual of survey instructions of the United States Department of the Interior, Bureau of Land Management or by a decree of a Court of Law and/or that the corner points mentioned in lines 3, 4 and 5 above were in conformance with the rules of the Michigan Board of Professional Surveyors or by a Decree of a Court of Law; established, re-established, monumented, re-monumented, recovered, found as expressed below:

NOTE: Not more than 4 corners, all in the same town and range, may be recorded on this certificate.

A. Description of original monument and accessories and/or subsequent restoration:

- 1) 1817 - GLO Wampler; Post was made of ironwood, 4" diameter, no bearing trees
- 2) 1973 - Kobs, PS 14097 Survey L. 2424 page 571
- 3) 1980 - Kobs, PS, 14097 Survey L. 3287 page 551, fnd PK nail
- 4) 1991 - Donnelly, PS 21563 Unrecorded Survey for Dave Adams & Associates
- 5) 1993 - Donnelly, PS 21563 LCRC L. 5298 page 940 fnd PK nail
- 6) 1993 - Avey, PS 30076 Unrecorded Survey
- 7) 1994 - King, PS 30085 Unrecorded Survey for George Adams
- 8) 1994 - King, PS 30085 Unrecorded Survey for James Burlison

ACCEPTED BY THE MACOMB COUNTY SURVEY PEER GROUP AS THE OFFICIAL CORNER UNDER MICHIGAN PUBLIC ACT 345 OF 1990 AT A MEETING HELD ON 10/17/95

William E. Soderberg
 WILLIAM E. SODERBERG, P.S., CHAIRMAN

B. Description of corner evidence found and/or method applied in restoring or reestablishing corner:

1995 - Wade-Trim, Inc. - Kovas, PS 33138 fnd PK nail in asphalt pavement in centerline of Van Dyke (Old M-58)
 Witnesses from survey in (8) above and in LCRC (4) above were used to recover and verify the location of the found PK.

DISTANCES	1995 W-T GPS	1988 MDOT JOB #05688A	1973 KOBBS	1991 DONNELLY	1994 KING	1980 KOBBS	1993 W. AVEY
1) NW 26 TO W 1/4 26	2613.53'	2613.36'					
2) W 1/4 26 TO SW 26	2591.66'		2591.76	2591.69	2598.21	2598.00'	2598.35
3) SW 26 TO W 1/4 35	2639.69'						

C. Description of monument for corner and accessories established to perpetuate locating the position of the corner:

I-10 West 1/4 Corner of Section 26
 Replaced PK nail with 3/4"x 24" iron rod with 2" diameter aluminum cap stamped "MACOMB COUNTY monument MI Act 345 #33138 in a newly set monument box.
 N 81° W 101.79' PK in U.P.
 N 17° E 50.95' PK in U.P.
 S 40° E 65.97' PK in U.P.
 S 77° W 58.73' Nail in U.P.

No evidence of any type of monument was found when a hole was made in the pavement to set the monument box. The selected location is accepted by me and is generally accepted by Professional Surveyors as the best available evidence of the position of the original corner.

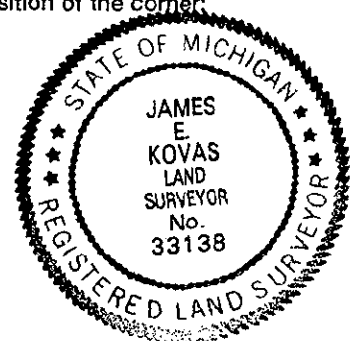

Signed by James E. Kovas Date 10/26/95
 Surveyor's Michigan License No. 33138