

**LAND CORNER RECORDATION CERTIFICATE**  
**Filing Requirement of Act 74, Mich. P.A. 1970**

For corners in  
Manistee  
 (County)

Located In: \_\_\_\_\_ Corner Code ##  
 \_\_\_\_\_  
 \_\_\_\_\_  
 \_\_\_\_\_  
 \_\_\_\_\_  
 \_\_\_\_\_  
 \_\_\_\_\_

**REGISTER'S OFFICE**  
**MANISTEE COUNTY**  
 #95-386 RT 11:50 A.M.  
**OCT 09 1995**  
*Renny A. Repore*  
**REGISTER OF DEEDS**

1. Public Land Survey T 21N R 16W I-9  
 T \_\_\_\_\_ R \_\_\_\_\_  
 T \_\_\_\_\_ R \_\_\_\_\_  
 T \_\_\_\_\_ R \_\_\_\_\_
2. Property Controlling S \_\_\_\_\_ T \_\_\_\_\_ R \_\_\_\_\_  
 in Section S \_\_\_\_\_ T \_\_\_\_\_ R \_\_\_\_\_
3. Miscellaneous S \_\_\_\_\_ T \_\_\_\_\_ R \_\_\_\_\_  
 Property in Sec. S \_\_\_\_\_ T \_\_\_\_\_ R \_\_\_\_\_
4. Lot No. \_\_\_\_\_, Recorded Plat \_\_\_\_\_
5. Private Claims \_\_\_\_\_

Register of Deeds Stamp & File Number

	A	B	C	D	E	F	G	H	I	J	K	L	M
2	6	5	4	3	2	1							
3													
4	7	8	9	10	11	12							
5													
6	13	17	16	15	14	13							
7													
8	19	20	21	22	23	24							
9													
10	30	29	28	27	26	25							
11													
12	31	32	33	34	35	36							
13													

Richard Hays, in a field survey on June, 1995,  
 do hereby certify that under requirements of P.A. 74, Michigan P.A. of 1970, the corner points mentioned  
 in lines 1 and 2 above were in conformance with regulations and rules therefore as required in the  
 current manual of survey instructions of the United States Department of the Interior, Bureau of Land  
 Management or by a decree of a Court of Law and/or that the corner points mentioned in lines 3, 4 and 5  
 above were in conformance with the rules of the Michigan Board of Land Surveyors or by a Decree of a  
 Court of Law; established, re-established, monumented, re-monumented, recovered, found as  
 expressed below:

**NOTE: Not more than 4 corners, all in the same town and range, may be recorded on this certificate.**

A. Description of original monument and accessories and/or subsequent restoration:  
**I-9 SECTION CORNER COMMON TO SECTIONS 22, 23, 26 & 27**  
 1847:G.L.O. Survey 1977:Carl Roser  
 8" W. Oak S-78 1/2 -W 47 Lks Found 1" Pipe in Center-  
 10" W. Oak N-38 -E 79 Lks Line of E & W Road from Ross  
 Witness:  
 24" B. Oak N-48 -W 62.73'  
 6" J. Pine S-15 -W 79.48'  
 24" B. Oak N-56 -W 73.16'  
 Post W/Tag North 33.00'

B. Description of corner evidence found and/or method applied in restoring or reestablishing corner:  
**I-9 SECTION CORNER COMMON TO SECTIONS 22, 23, 26 & 27**  
 1995:Found 1" pipe in centerline of road:  
 24" B. Oak N-48 -W 62.73'  
 6" J. Pine S-15 -W 79.48'  
 24" B. Oak N-56 -W 73.16'  
 Post W/Tag North 33.00'

Corner I-09 ratified by the Manistee County Peer Group  
 according to the county plan adopted pursuant to P.A. 345 of 1990,  
 as amended, (being the State Survey and Remonument Act, MCL 54.261  
 et. seq.). Date of Peer Review: Richard A. Repore

C. Description of monument for corner and accessories established to perpetuate locating the position of the corner:  
**I-9 SECTION CORNER COMMON TO SECTIONS 22, 23, 26 & 22**  
 1995:Replaced 1" pipe with the Standard Manistee County Monument  
 with Brass Cap as the best available evidence of the position  
 of the Original Corner.

24" B. Oak N-48 -W 62.73'  
 6" J. Pine S-15 -W 79.48'  
 24" B. Oak N-56 -W 73.16'  
 Post W/Tag North 33.00'  
 Centerline of dirt road to the south of West 135.00' more or less

Signed by Richard Hays  
 Surveyor's Michigan License No. 25847

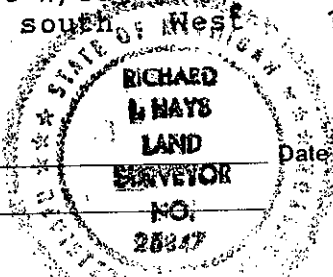

Date July 5, 1995