

**LAND CORNER RECORDATION CERTIFICATE**  
**Filing Requirement of Act 74, Mich. P.A. 1970**

For corners in  
Manistee  
 (County)

Located In: Corner Code #  
 E 1/4 Sec. 36  
 M-12

REGISTER'S OFFICE  
 MANISTEE COUNTY  
 #94-538 AT 10:35 A.M.  
 NOV 2-9 1994

*Penny A. Peperas*  
 REGISTER OF DEEDS

1. Public Land Survey T 23N R 14W M-12  
 T 23N R 13W A-12 ✓  
 T \_\_\_\_\_ R \_\_\_\_\_  
 2. Property Controlling S \_\_\_\_\_ T \_\_\_\_\_ R \_\_\_\_\_  
 In Section S \_\_\_\_\_ T \_\_\_\_\_ R \_\_\_\_\_  
 3. Miscellaneous S \_\_\_\_\_ T \_\_\_\_\_ R \_\_\_\_\_  
 Property in Sec. S \_\_\_\_\_ T \_\_\_\_\_ R \_\_\_\_\_

Register of Deeds Stamp & File Number

4. Lot No. \_\_\_\_\_, Recorded Plat \_\_\_\_\_  
 5. Private Claims \_\_\_\_\_

	A	B	C	D	E	F	G	H	I	J	K	L	M
2	6	5	4	3	2								
3													
4	7	8	9	10	11	12							
5													
6	18	17	16	15	14	13							
7													
8	19	20	21	22	23	24							
9													
10	30	29	28	27	26	25							
11													
12	31	32	33	34	35	36							
13													

I, Bruce J. Jenema in a field survey on July 11, 1994, do hereby certify that under requirements of P.A. 74, Michigan P.A. of 1970, the corner points mentioned in lines 1 and 2 above were in conformance with regulations and rules therefore as required in the current manual of survey instructions of the United States Department of the Interior, Bureau of Land Management or by a decree of a Court of Law and/or that the corner points mentioned in lines 3, 4 and 5 above were in conformance with the rules of the Michigan Board of Land Surveyors or by a Decree of a Court of Law; established, re-established, monumented, re-monumented, recovered, found as expressed below:

NOTE: Not more than 4 corners, all in the same town and range, may be recorded on this certificate.

A. Description of original monument and accessories and/or subsequent restoration:

Oct. 1839 John Brink GLO Surveyor West boundary Section 36, T23N, R14W  
 Witness: Maple 13" S31°W 35 links Beech 9" N01°W 33 links  
 On 5-11-1909 EH Baird Witnessed corner established by:  
 WPS 28" S83°E 59 links WPS 14" S50°E 50 links  
 Book "B" Manistee County survey records page 286

B. Description of corner evidence found and/or method applied in restoring or reestablishing corner:

Found both witness by EH Baird to re-establish this corner  
 FENCE LINE N&S

Corner M-12 ratified by the Manistee County Peer Group according to the county plan adopted pursuant to P.A. 345 of 1990, as amended, (being the State Survey and Remonument Act, MCL 54.261 et. seq.). Date of Peer Review: *[Signature]*

APPROVED NOV 07 1994

C. Description of monument for corner and accessories established to perpetuate locating the position of the corner:

As a careful & Faithful re-establishment of this corner I have set a 2" x 30" steel pipe with a brass ID cap and witness by:  
 12" Maple S25°E 7.90 ft.  
 12" Maple N55°W 33.40 ft.  
 TW. 6" Maple N45°W 33.20 ft.  
 6" Maple N06°E 47.15 ft.

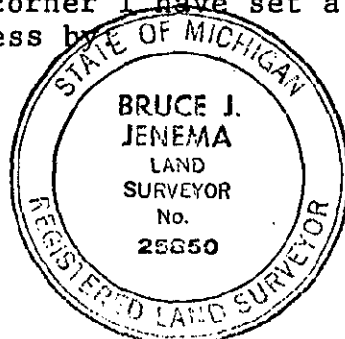

Signed by *Bruce J. Jenema* Date Nov. 3, 1994  
 Surveyor's Michigan License No. 25850