

MICHIGAN
DEPARTMENT OF CONSERVATION
FORESTRY DIVISION

LAND CORNER RECORD

T. 24 N.R. 14 W

Manistee COUNTY

DESCRIPTION OF CORNER W 1/8 corner common to Sections 28-33

CORNER MONUMENT Set 1/2" x 14" iron bar over 1" iron bolt.

DATE MONUMENT PLACED AND WITNESSED 11-1-61

WITNESSES TO CORNER.....

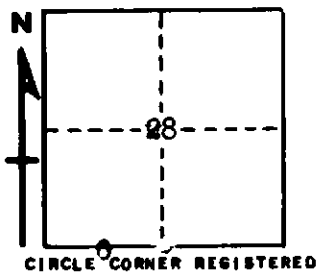

* SW corner of house - N 43½ E - 180.0 feet

Fence post - North - 30.1 feet

AND
Fence post - West - 25.0 feet

* Muenscher witness

DESCRIPTION IN DETAIL AS TO HOW CORNER WAS LOCATED AND IDENTIFIED OR RESTORED.

This corner was found while making a survey in this township. Found a 1" wagon bolt at corner, as established by E. W. Muenscher in 1907 survey, from his witness. Falls in line with road east and south, fences north and west.

SURVEYOR'S SEAL

SIGNED Kenneth J. Osting DATE 11/15/61
REGISTERED LAND SURVEYOR