

**LAND CORNER RECORDATION CERTIFICATE**  
**Filing Requirement of Act 74, Mich. P.A. 1970**

For corners in  
Manistee  
(County)

Located In: \_\_\_\_\_ Corner Code #/ # \_\_\_\_\_

REGISTER'S OFFICE  
 MANISTEE COUNTY  
 #93-632 AT 9:40 A.M.  
**NOV 3 1993**  
*Penny A. Peperas*  
 REGISTER OF DEEDS

- |                                    |                                 |
|------------------------------------|---------------------------------|
| 1. Public Land Survey              | T <u>24N</u> R <u>R16W</u> M-2  |
|                                    | T _____ R _____                 |
|                                    | T <u>24N</u> R <u>15W</u> A-2 ✓ |
|                                    | T _____ R _____                 |
| 2. Property Controlling in Section | S _____ T _____ R _____         |
|                                    | S _____ T _____ R _____         |
| 3. Miscellaneous Property in Sec.  | S _____ T _____ R _____         |
|                                    | S _____ T _____ R _____         |

Register of Deeds Stamp & File Number

4. Lot No. \_\_\_\_\_, Recorded Plat \_\_\_\_\_
5. Private Claims \_\_\_\_\_

	A	B	C	D	E	F	G	H	I	J	K	L	M
2	6	5	4	3	2	1							
3													
4	7	8	9	10	11	12							
5													
6	18	17	16	15	14	13							
7													
8	19	20	21	22	23	24							
9													
10	30	29	28	27	26	25							
11													
12	31	32	33	34	35	36							
13													

I, Bruce J. Jenema in a field survey on Sept. 22, 1993, do hereby certify that under requirements of P.A. 74, Michigan P.A. of 1970, the corner points mentioned in lines 1 and 2 above were in conformance with regulations and rules therefore as required in the current manual of survey instructions of the United States Department of the Interior, Bureau of Land Management or by a decree of a Court of Law and/or that the corner points mentioned in lines 3, 4 and 5 above were in conformance with the rules of the Michigan Board of Land Surveyors or by a Decree of a Court of Law; established, re-established, monumented, re-monumented, recovered, found as expressed below:

**NOTE: Not more than 4 corners, all in the same town and range, may be recorded on this certificate.**

**A. Description of original monument and accessories and/or subsequent restoration:**

M-2 East one-quarter corner originally established by the General Land office survey by John Brink 11-4-1836  
 Set 1/4 Section post witness by Beech 8" West 04 links, ironwood 7" N34°W 27 links  
 No record subsequent restoration by co-surveyors

**B. Description of corner evidence found and/or method applied in restoring or reestablishing corner:**

1" iron rod found by Gourdie-Fraser and Associates 12-2-88 and witness by 10" Maple S70°E 29.95 and 8" Basswood S40°E 51.80  
 NOTE: This corner falls within an excavated sand trail, an old tree to tree fence line corner is 12.5' South and 33' East

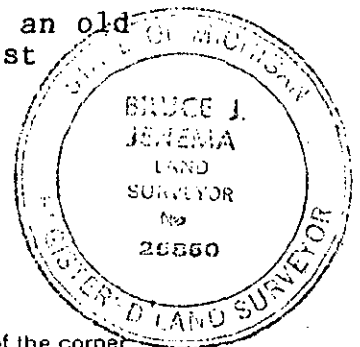

**C. Description of monument for corner and accessories established to perpetuate locating the position of the corner:**

East one-quarter corner Section 1, T24N, R16W  
 2"x30" Stainless Steel pipe with Brass cap replaces found 1" Iron Rod  
 Witness by  
 6" Maple N19°W 36.35', 4" Ash N27°E 54.66'  
 12" Maple S73°E 42.88', 10" Maple S70°E 29.85' (reocrd 29.95, GFA)  
 and 8" Basswood 51.80' (51.55' record GFA)

Corner M-2 ratified by the Manistee County Peer Group pursuant to P.A. 123 of 1915, as amended by P.A. 245 of 1990, as amended. Date of Peer Review: **APPROVED OCT 4 1993**

Signed by Bruce J. Jenema Date 9-29-93

Surveyor's Michigan License No. 25850