

1993

LAND CORNER RECORDATION CERTIFICATE
Filing Requirement of Act 74, Mich. P.A. 1970

COMMISSION

For corners in

Manistee

(County)

Located In:

Corner Code #

1. Public Land Survey	T <u>24N</u> R <u>16W</u>	<u>I-3</u>
	T _____ R _____	_____
	T _____ R _____	_____
	T _____ R _____	_____
2. Property Controlling in Section	S _____ T _____ R _____	_____
	S _____ T _____ R _____	_____
3. Miscellaneous Property in Sec.	S _____ T _____ R _____	_____
	S _____ T _____ R _____	_____

REGISTER'S OFFICE
MANISTEE COUNTY

#93-639 AT 10:05 A.M.

NOV 3 1993

Penny A. Peters
REGISTER OF DEEDS

Register of Deeds Stamp & File Number

4. Lot No. _____, Recorded Plat _____

5. Private Claims _____

I, Richard L. Hays, in a field survey on October 27, 1993, do hereby certify that under requirements of P.A. 74, Michigan P.A. of 1970, the corner points mentioned in lines 1 and 2 above were in conformance with regulations and rules therefore as required in the current manual of survey instructions of the United States Department of the Interior, Bureau of Land Management or by a decree of a Court of Law and/or that the corner points mentioned in lines 3, 4 and 5 above were in conformance with the rules of the Michigan Board of Land Surveyors or by a Decree of a Court of Law; established, re-established, monumented, re-monumented, recovered, found as expressed below:

NOTE: Not more than 4 corners, all in the same town and range, may be recorded on this certificate.

A. Description of original monument and accessories and/or subsequent restoration:
I-3 SECTION COMMON TO SECTIONS 2,3,10 & 11

1839 G.L.O.: Set Post, No Witnesses

1926: J. H. Millard, County Surveyor set Iron Pipe	1986: Found 1" Iron Pipe set by Anthony Slawinski:	1988: Found 1" Iron Pipe set by Glen F. De La Mater (L.C.R.C. #88-634)
24" Hemlock South 35.00 Links	6" Maple N-55°-W 27.32'	3" Maple N-47°-E 14.67'
5" Maple N-25½°-W 22.75 Links	6" Maple N-50°-E 14.72'	12" Maple S-32°-E 20.15'
5" Cedar S-31½°-E 33.00 Links	12" Maple S-30°-E 20.17'	6" Maple N-56°-W 27.26'
		5" Cedar (fallen) S-31°-E 8'

Set by J. H. Millard in 1926

B. Description of corner evidence found and/or method applied in restoring or reestablishing corner:
I-3 SECTION COMMON TO SECTIONS 2,3,10 & 11

1993 Found 1" Iron Pipe. Corner fits witness of L.C.R.C. #88-634

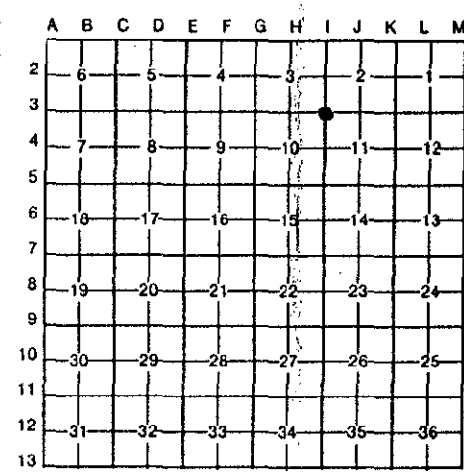

Corner I-3 ratified by the Manistee County Peer Group pursuant to P.A. 123 of 1915, as amended by P.A. 345 of 1990, as amended. Date of Peer Review: Nov 1, 1993

MANISTEE COUNTY PLANNING DEPARTMENT
415 THIRD ST - COURTHOUSE
MANISTEE, MI 49660-1696

C. Description of monument for corner and accessories established to perpetuate locating the position of the corner:
I-3 SECTION COMMON TO SECTIONS 2,3,10 & 11

Replaced 1" Iron with standard Manistee County Monument with Brass Cap (set 0.60' above grade). This Monument is accepted as the best available evidence of the position of the Corner.

12" Maple	S-32°-E	20.20'
11" Spruce	S-45°-W	66.87'
6" Maple	N-58°-W	27.30'
3" Maple	N-48°-E	14.64'

Old Fence Lines are approximately 100' North and West of Corner.

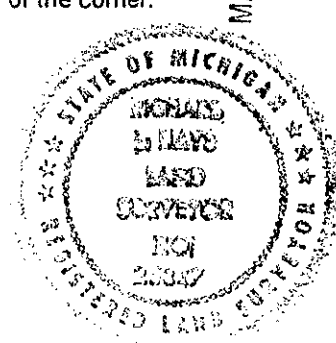

Signed by Richard Hays Date Oct 28, 1993
Surveyor's Michigan License No. 25847