

DEC 29 1993

LAND CORNER RECORDATION CERTIFICATE
Filing Requirement of Act 74, Mich. P.A. 1970

SECTION
For corners in MASON (County)

Located In:

Corner Code #

- 1. Public Land Survey T 18N R 16W B-7
2. Property Controlling in Section S T R
3. Miscellaneous S T R
Property in Sec. S T R
4. Lot No. Recorded Plat
5. Private Claims

Register of Deeds Stamp & File Number
FILED AT 10 O'CLOCK 28 A
11 1993
MARY OWEN DEN KOSTER

I, Kenneth L. Ross, in a field survey on July 17 19 98, do hereby certify that under requirements of P.A. 74, Michigan P.A. of 1970, the corner points mentioned in lines 1 and 2 above were in conformance with regulations and rules therefore as required in the current manual of survey instructions of the United States Department of the Interior, Bureau of Land Management or by a decree of a Court of Law and/or that the corner points mentioned in lines 3, 4 and 5 above were in conformance with the rules of the Michigan Board of Land Surveyors or by a Decree of a Court of Law, established, re-established, monumented, re-monumented, recovered, found as expressed below.

NOTE: Not more than 4 corners, all in the same town and range, may be recorded on this certificate.

A. Description of original monument and accessories and/or subsequent restoration:

B-7 1/4 Corner for Sections 18 and 19, T18N-R16W.

1839, Sylvester Sibley, G.L.O.
Set Wood Post
#1 Black Ash 12" S 56 E 18 lks. (11.08')
#2 Black Ash 12" N 40 W 38 lks. (25.08')

Gives a distance of 2577.30' to SW cor. of Section 19.

1963, Ken Stephens, Mason Co. Survey
Set 3/4" Iron Pipe at

no witness recorded (E- 47)

1997, Ken Ross, RLS# 17634
Found 3/4" Iron pipe by Ken Stephens in Survey 97315s.

- #3 Black Ash 9" S 39 E 12.05'
#4 Black Ash 8" S 67 W 23.49'
#5 Black Ash 14" N 14 W 31.87'
#6 Black Ash 22" N 27 E 10.01'

B. Description of corner evidence found and/or method applied in restoring or reestablishing corner:

B-7 1/4 Corner for Sections 18 and 19, T18N-R16W.

On July 17, 1990, I found 3/4" Iron Pipe by Stephens and used by Rex Pope (RLS# 39093) and in Surveys. I found no evidence to dispute this location for the corner.

Condition of record witnesses are as follows; #1 Gone #2 Gone #3 Found in good condition
#4 Found in good condition #5 Found in good condition #6 Found in good condition

C. Description of monument for corner and accessories established to perpetuate locating the position of the corner:

B-7 1/4 Corner for Sections 18 and 19, T18N-R16W.

I replaced 3/4" Iron Pipe by Stephens with a 5/8" Re-rod, 24" in length, in the exact location, placed a 3 1/2 aluminum cap over re-rod, stamped to identify the corner, and is accepted as a careful and faithful re-establishment of the position of the original corner.

- Ext. "BT" #3 Black Ash 9" S 39 E 12.05' (60d spike in NE side of tree)
Ext. "BT" #4 Black Ash 8" S 67 W 23.49' (60d spike in NW side of tree)
Ext. "BT" #5 Black Ash 14" N 14 W 31.87' (60d spike in SE side of tree)
Ext. "BT" #6 Black Ash 22" N 27 E 10.01' (60d spike in SE side of tree)

Signed by [Signature] Date Sept 8, 1990
Surveyor's Michigan License No. 17634

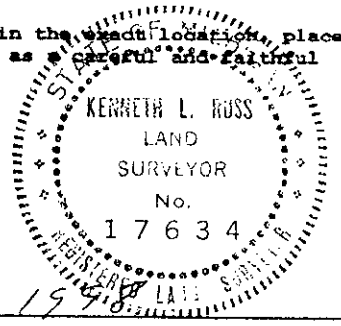

FORM APPROVED BY MICHIGAN STATE BOARD OF LAND SURVEYORS, JAN. 28, 1971
REVISED MAY 14, 1975
REVISED JAN. 1983
ADAPTED FOR WORD PROCESSING MARCH, 1993

Peer Group Reviewed and Approved
Date 9-8-98
[Signature]
Michigan Land Surveyor