

**SURVEY &  
MONUMENTATION**

DEC 18 1995

**COMMISSION LAND CORNER RECORDATION CERTIFICATE**  
Filing Requirement of Act 74, Mich. P.A. 1970

For corners in

<u>MASDN</u> (County)	Located In:	Corner Code #:
1. Public Land Survey	T 18 N R 17 W	J-1
	T _____ R _____	_____
	T _____ R _____	_____
	T _____ R _____	_____
2. Property Controlling in Section	S _____ T _____ R _____	_____
	S _____ T _____ R _____	_____
3. Miscellaneous Property in Sec.	S _____ T _____ R _____	_____
	S _____ T _____ R _____	_____

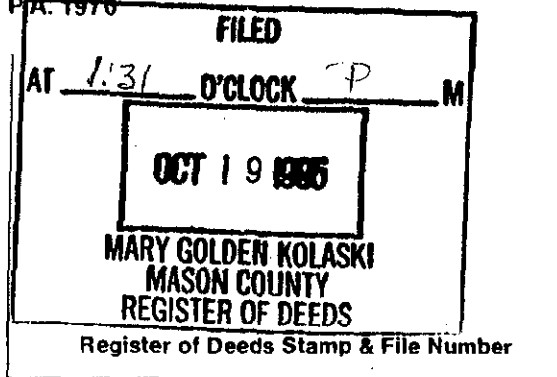

4. Lot No. \_\_\_\_\_, Recorded Plat \_\_\_\_\_  
5. Private Claims \_\_\_\_\_

A	B	C	D	E	F	G	H	I	J	K	L	M
2	6	5	4	3	2	1						
3												
4	7	8	9	10	11	12						
5												
6	18	17	16	15	14	13						
7												
8	19	20	21	22	23	24						
9												
10	30	29	28	27	26	25						
11												
12	31	32	33	34	35	36						
13												

I, Sammy S. Barnett, in a field survey on October 10, 1995, do hereby certify that under requirements of P.A. 74, Michigan P.A. of 1970, the corner points mentioned in lines 1 and 2 above were in conformance with regulations and rules therefore as required in the current manual of survey instructions of the United States Department of the Interior, Bureau of Land Management or by a decree of a Court of Law and/or that the corner points mentioned in lines 3, 4 and 5 above were in conformance with the rules of the Michigan Board of Land Surveyors or by a Decree of a Court of Law; established, re established, monumented, re-monumented, recovered, found as expressed below:

**NOTE: Not more than 4 corners, all in the same town and range, may be recorded on this certificate.**

A. Description of original monument and accessories and/or subsequent restoration:

J-1 North 1/4 Corner for Section 2, T18N, R17W, on the Township Line

1838, Brookfield & Mullett, G.L.O.  
Run original township line, but did not set this corner.

1899, R.O. Towns, M.C.S.  
Identified as a stake

1985, Dennis Dunlap, RLS  
Set 1 1/2" Iron Pipe, half-way and on line BETWEEN NE COR & NW COR  
#1 N-S fence West 5'  
#2 Center-line grade West 15'  
#3 Fence Corner, North 120'  
#4 Maple 12" North 64.61'

1994, Ken Ross, M.C.S.  
Found 1 1/2" Iron Pipe  
#5 Poplar 12" North 31.80'  
#6 Cherry 8" N 70° E 34.36'  
#7 Center-grade West 9'

B. Description of corner evidence found and/or method applied in restoring or reestablishing corner:

J-1 North 1/4 Corner for Section 2, T18N, R17W, on the Township Line

On October 10, 1995, I found a 1 1/2" Iron Pipe 9 feet East of an old Road grade, 8" above ground surface, Iron pipe is 4 feet long, with a 1/2" Re-rod inside, with RLS cap No. 17634, also found old fence corner, which lies S 20° E, 10.7 feet, fence runs to the East and to the South, also found a steel fence post next to Iron NW, 0.40 feet, found no other evidence to dispute this location for the corner.

Condition of recorded witnesses is; #1 Gone #2 Gone #3 Gone #4 Gone #5 Gone #6 Found in good condition #7 ok

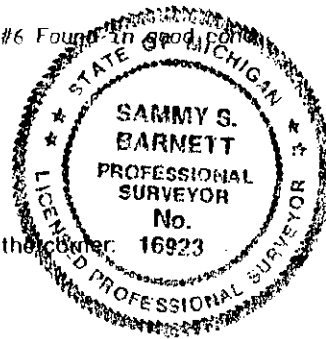

C. Description of monument for corner and accessories established to perpetuate locating the position of the corner:

J-1 North 1/4 Corner for Section 2, T18N, R17W, on the Township Line

I replace 1 1/2" Iron Pipe with a 5/8" Re-rod, 24" long with an aluminum cap (2 1/2" in dia.), stamped MASON COUNTY MONUMENT, placed flush with the ground, and is accepted as a careful and faithful reestablishment of the position of the original corner.

- ODT #6 Cherry 10" N 70° E 34.29' (60d spike in NW side of tree)
- Tw. Black Oak N 48° W 32.45 (60d spike in SW side of tree)
- Poplar 6" S 31° W 35.01' (60d spike in SE side of tree)
- Mason County Aluminum cap West 13.18 feet, South 1/4 corner for Section 35, T19N, R17W.

LIBER 3 PAGE 353

Signed by Sammy S. Barnett  
Surveyor's Michigan License No. 16923

Date 10-16-95

Peer Group Reviewed  
and Approved  
Date: 10-12-95  
Kenneth J. ...  
Mason County Surveyor