

SURVEY & MONUMENTATION

JAN 23 2001

LAND CORNER RECORDATION CERTIFICATE

Filing Requirement of Act 74, Mich. P.A. 1970

SECTION

For corners In: Located In: Corner Code #
Mason County

- 1. Public Land Survey T 18N R 17W A-9
T 18N R 18W M-9 ✓
T R
T R
- 2. Property Controlling S T R
in Section S T R
- 3. Miscellaneous S T R
Property in Sec. S T R

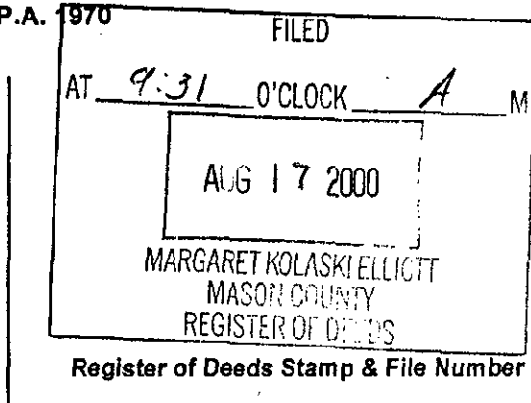

- 4. Lot No. _____ Recorded Plat _____
- 5. Private Claims _____

I, Kenneth L. Ross in a field survey on June 8, 2000, Do hereby certify that under requirements of P.A.74, Michigan P.A. of 1970, the corner points mentioned in lines 1 and 2 above were in conformance with regulations and rules therefore as required in the current manual of survey instructions of the United States Department of the Interior, Bureau of Land Management or by a decree of a Court of Law and/or that the corner points mentioned in lines 3, 4 and 5 above were in conformance with the rules of the Michigan Board of Land Surveyors or by a Decree of a Court of Law; established, re-established, monumented, re-monumented, recovered, found as expressed below:

¼ corner common to section 19 and 30 of T18N, R17W, and section 24 and 25 of T18N, R18W.

	A	B	C	D	E	F	G	H	I	J	K	L	M
1													
2	6	5	4	3	2	1							
3													
4	7	8	9	10	11	12							
5													
6	18	17	16	15	14	13							
7													
8	19	20	21	22	23	24							
9													
10	30	29	28	27	26	25							
11													
12	31	32	33	34	35	36							
13													

A. Description of original monument and accessories and/or subsequent restoration:

- GLO 1838 Mullett & Brookfield Pine 26" N84W 26 lks. (17.16') #1 W. Oak 8" S67W 97 lks. (64.02') #2
Ross #17634 unrecorded Act 132 June, 1992 "monument box" No Witnesses taken
Fluharty RLS18223, April, 1990 L3, P14 Act. 74 Fd. ¼" angle iron 6" Maple S5E 46.67' #7 14" Oak S65W 91.80' #6 PP N7W 201.98' #8
- Ross #17634 1985 Unrecorded Act 132, used corner In Sec. traverse, no witnesses
Ross, #17634 unrecorded Act 132 March 1981 "monument box" No witnesses taken
Fluharty RLS 18223 7-23-87 L359 P177 Same as above.
- Hooth PLS 7966 L1 P317 Jan 27, 1977 Old "T" iron in mon. Box W. end culvert N20W 78.00' #3 Road sign post N45W 45.09' #4 28" oak N80W 93.42' #5 14" oak S55W 91.31' #6
Stephens PLS 7318, unrecorded survey for Consumers Power Co. Oct. 1967 Iron fence post (inverted) Rd. sign N43W 45.71' #4 35" B. Oak N70W 93.18' #5 14" R. Oak S50W 90.98' #6
MCRC undated Same as Stephens 1967

B. Description of corner evidence found and/or method applied in restoring or reestablishing corner:

I found a 5/8" iron rod in a monument box. in the center of an E-W road and in the centerline of a road to the North.
Condition of accessories is as follows: 1, 2, 3, 4, are gone 5, 6, 7 and 8 are in good condition.
I found nothing to dispute the location of this corner.

C. Description of monument for corner and accessories established to perpetuate locating the position of the corner:

I set a 2 ½" Aluminum cap on the existing 5/8" iron rod in the monument box and accepted this a careful and faithful reestablishment of the position of the original corner.

- 15" R. Oak S65W 91.14' Set 60d spike on NW side #6
- 10" Maple S05E 46.41' Set 60d spike on E side #7
- T Pole 12" high +/- N80E 140.58 Set mag nail N side
- Center 4' Crimson Maple N41W 72.4' (no nail set)

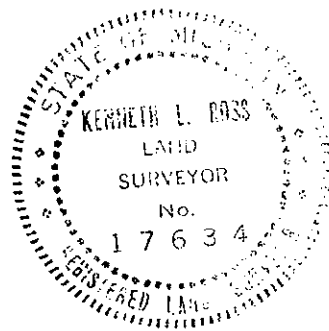

Signed by [Signature] Date 8-10-2000
Surveyor's Michigan License No. 17634

Approved by Peer Review Group on 8-10-2000
Kenneth L. Ross, County Representative

FORM APPROVED BY MICHIGAN STATE BOARD OF LAND SURVEYORS, JAN. 28, 1971
REVISED MAY 14, 1978
REVISED JAN, 1983
ADAPTED FOR WORD PROCESSING MARCH, 1993