

**SURVEY &  
REMONUMENTATION**

MAY 07 1997

**COMMISSION**

**LAND CORNER RECORDATION CERTIFICATE**

Filing Requirement of Act 74, Mich. P.A. 1970

For corners in  
Mason County  
(County)

Located In: \_\_\_\_\_ Corner Code # \_\_\_\_\_

1. Public Land Survey T 20N R 16W I-8  
T R  
T R  
T R

2. Property Controlling S T R  
in Section S T R

3. Miscellaneous S T R  
Property in Sec. S T R

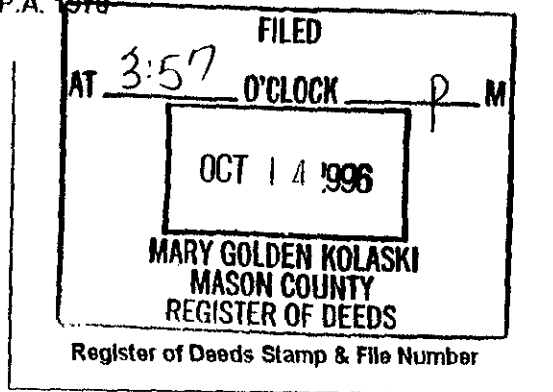

4. Lot No. \_\_\_\_\_ Recorded Plat \_\_\_\_\_  
5. Private Claims \_\_\_\_\_

I, Kenneth L. Ross, in a field survey on AUGUST, 1996, do hereby certify that under requirements of P.A. 74, Michigan P.A. of 1970, the corner points mentioned in lines 1 and 2 above were in conformance with regulations and rules therefore as required in the current manual of survey instructions of the United States Department of the Interior, Bureau of Land Management or by a decree of a Court of Law and/or that the corner points mentioned in lines 3, 4 and 5 above were in conformance with the rules of the Michigan Board of Land Surveyors or by a Decree of a Court of Law; established, re-established, monumented, re-monumented, recovered, found as expressed below:

**NOTE: Not more than 4 corners, all in the same town and range, may be recorded on this certificate.**

	A	B	C	D	E	F	G	H	I	J	K	L	M
1													
2	6	5	4	3	2	1							
3													
4	7	8	9	10	11	12							
5													
6	18	17	16	15	14	13							
7													
8	19	20	21	22	23	24							
9													
10	30	29	28	27	26	25							
11													
12	31	32	33	34	35	36							
13													

**A. Description of original monument and accessories and/or subsequent restoration:**  
In 1839, John Brink, set the original corner, stating "set quarter section post common to Sections 22 and 23". Witnesses taken: (1) 9" Beech, S06°E, 12 links, (2) 14" Beech, N89°W, 64 links. In May 1881, C.E. Mitchell, Found corner identified by Government Marks and Witnesses, (Referring to GLO). No Witnesses Taken. In 1966, Robert Griffin, RLS, set 5" X3' square reinforced concrete post, set 1 foot below the road surface with a 3" diameter brass cap and filed an Act 74, Liber 1, page 104, Mason County Records, Witnesses Given: (3) SW Corner Basement Wall of Frame Hse, N05°E, 367.96', (4) Spike and shiner, 4" Cedar Fence Corner, East, 28.26', (5) Spike and shiner, in South Side Cedar Post, West, 33.00', (6) 10" Dock Spike in SW side 9" Maple, scribed "BT" N37°W, 173.18', (7) 16 penny spike and Brass tag (RLS 13584) in NE side Tel. Pole, N60°W, 38.21'. In 1975, Kenneth L. Ross, RLS, Found Monument by Griffin, No Witnesses Given. In 1990 Kenneth L. Ross, RLS, found Broken USFS Monument, No Witnesses given. In 1991, Kenneth L. Ross, RLS, Set 2" X 30" Stainless Steel Pipe with Brass Cap, buried 18" under the surface of the road. Witnesses Given: (8) 8" W. Oak, N42°W, 109.32', (9) NE Corner of House S50°W, 146.25'. (10) Government Witness Post, West, 32.65', (11) P.P. S79°E, 21.46', (12) P.P. S43°W, 53.99'. Used in Survey of Section 23, T.20N., R.16W. Mason County Road Commission Records, State 1" pipe at this location. Witnesses Given (13) Fence Post, West, 25.2', (14) Fence Post, East, 28.5'.

**B. Description of corner evidence found and/or method applied in restoring or reestablishing corner:**  
In August, 1996 I found the 2" X 30" Stainless Steel Pipe and Brass Cap. Witnesses (3), (8), (9), (10), (11) and (12) are standing and in good condition. Witnesses (1), (2), (4), (5), (6), (7), (13) and (14) have been destroyed.

**C. Description of monument for corner and accessories established to perpetuate locating the position of the corner:**  
I did not replace the 2" X 30" stainless steel pipe and cap and accepted as a careful and faithful reestablishment of position of the original corner. Witnesses checked or set: (3) SW Corner of Basement wall of Frame Hse, 367.95'  
(8) 8" White Oak, N42°W, 109.32'  
(9) NE Corner of House, S50°W, 146.25'  
(10) Government Post, West, 32.65'  
(11) P.P. S79°E, 21.46'  
(12) P.P. S43°W, 53.99'

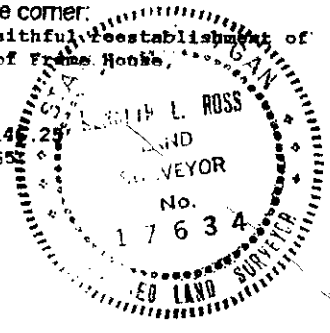

Signed by [Signature]  
Surveyor's Michigan License No. 17634

Date 9-30-96

[Signature]  
Mason County Surveyor

FORM APPROVED BY MICHIGAN STATE BOARD OF LAND SURVEYORS, JAN. 28, 1971  
REVISED MAY 14, 1975  
REVISED JAN., 1983  
ADAPTED FOR WORD PROCESSING MARCH, 1997