

**SURVEY &  
REMONUMENTATION**

APR 04 1996

**COMMISSION**

**LAND CORNER RECORDATION CERTIFICATE**

Filing Requirement of Act 74, Mich. P.A. 1970

STATE OF MICHIGAN  
COUNTY OF MECOSTA  
RECEIVED FOR RECORD

For corners in Mecosta Located In: \_\_\_\_\_ Corner Code \_\_\_\_\_  
# \_\_\_\_\_ (County) \_\_\_\_\_

95 DEC 29 8:47

*Janet Brown*  
REGISTER OF DEEDS

Register of Deeds Stamp & File Number

- |                                    |                                 |                        |
|------------------------------------|---------------------------------|------------------------|
| 1. Public Land Survey              | Sec 20/ T <u>13</u> R <u>10</u> | <u>E-8, 1/4 Corner</u> |
|                                    | 21 T _____ R _____              | _____                  |
|                                    | T _____ R _____                 | _____                  |
|                                    | T _____ R _____                 | _____                  |
| 2. Property Controlling in Section | S _____ T _____ R _____         | _____                  |
|                                    | S _____ T _____ R _____         | _____                  |
| 3. Miscellaneous Property in Sec.  | S _____ T _____ R _____         | _____                  |
|                                    | S _____ T _____ R _____         | _____                  |

4. Lot No. \_\_\_\_\_, Recorded Plat \_\_\_\_\_  
5. Private Claims \_\_\_\_\_

I, William Tingley a field survey on July 25, 1995, do hereby certify that under requirements of P.A. 74, Michigan P.A. of 1970, the corner points mentioned in lines 1 and 2 above were in conformance with regulations and rules therefore as required in the current manual of survey instructions of the United States Department of the Interior, Bureau of Land Management or by a decree of a Court of Law and/or that the corner points mentioned in lines 3, 4 and 5 above were in conformance with the rules of the Michigan Board of Land Surveyors or by a Decree of a Court of Law; established, re-established, monumented, re-monumented, recovered, found as expressed below:

**NOTE: Not more than 4 corners, all in the same town and range, may be recorded on this certificate.**

**A. Description of original monument and accessories and/or subsequent restoration:**

1837, Abner VanNess, Deputy Surveyor, GLO Notes

Maple 6" N20°E 10 links

Pine 8" N70°W 16 links

1902, Lyman June, Page 111, Survey Record

Old Corner replaced

1974, Patrick Salisbury, Survey Liber 10, Page 315

3/4" Iron Bar

Oak 18" S50°W 34.97 feet

Oak 20" S01°W 50.92 feet

Power Pole N44°W 85.83 feet

1976, Gerald Gray, #17741, Survey

Found 1" Steel Bar

Oak 24" S45°W 35.24 feet

Oak 8" N30°E 27.35 feet

oak 30" South 51.16 feet

1978, Duane Wood, #24625, LCRC, Liber 1, Page 457

Same record as 1976

Also same on survey recorded September 18, 1978

1985, Charles Fricke, #21781, Survey

Shows same bearing trees as 1976

1993, Duane Wood, #24625, Survey, Liber 11, page 673

Same Bearing Trees as 1976

1993, James Keller

Same record as 1976

**B. Description of corner evidence found and/or method applied in restoring or reestablishing corner:**

Found 1" x 25" Solid Bar 0.5 feet below surface

Found Nail 24" Twin Maple S45°E 44.04 feet

Found Nail 30" Oak South 51.03 feet

Found Nail 32" Oak S45°W 34.39 feet

Found Nail 8" Oak N35°E 28.78 feet

**C. Description of monument for corner and accessories established to perpetuate locating the position of the corner:**

Set Remonumentation Corner over bar

Found Nail 24" Twin Maple S45°E 44.04 feet

Found Nail 30" Oak South 51.03 feet

Found Nail 32" Oak S45°W 34.39 feet

Found Nail 8" Oak N35°E 28.78 feet

This corner is accepted as a careful and faithful perpetuation of the position of the original corner.

1	A	B	C	D	E	F	G	H	I	J	K	L	M
2	6	5	4	3	2	1							
3													
4	7	8	9	10	11	12							
5													
6	18	17	16	15	14	13							
7													
8	19	20	21	22	23	24							
9													
10	30	29	28	27	26	25							
11													
12	31	32	33	34	35	36							
13													

APPROVED BY MECOSTA CO. PEER GROUP  
IN ACCORDANCE WITH P.A. 345 of 1990

*James M. Knapp*  
CHAIRMAN  
DATE July 27, 1995

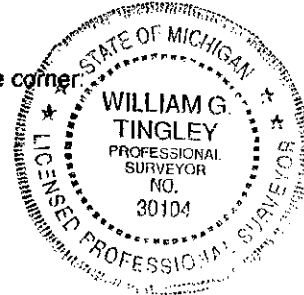

Signed by William G. Tingley Date 12-12 1995

Surveyor's Michigan License No. 30104

FORM APPROVED BY MICHIGAN STATE BOARD OF LAND SURVEYORS, JAN. 28, 1  
REVISED MAY 14, 15  
REVISED JAN. 15  
ADAPTED FOR WORD PROCESSING MARCH, 15