

**SURVEY & REMONUMENTATION**

**MECOSTA COUNTY REMONUMENTATION PROGRAM**

OCT 29 1998

CORNER APPROVED BY PEER GROUP ON August 14, 1998

STATE OF MICHIGAN  
COUNTY OF MECOSTA  
RECEIVED FOR RECORD

**LAND CORNER RECORDATION CERTIFICATE**

SECTION

Filing Requirement of Act 74, Mich. P.A. 1970

'98 SEP 24 AM 11:01

For corners in

Mecosta

(County)

Located In:  
Mecosta Twp

Corner Code #

1. Public Land Survey	SEC 20 T 14N R 10W	E-7
	T R	
	T R	
	T R	
2. Property Controlling in Section	S T R	
	S T R	
3. Miscellaneous Property in Sec.	S T R	
	S T R	

*John Brown*  
REGISTER OF DEEDS

Register of Deeds Stamp & File Number

4. Lot No. \_\_\_\_\_, Recorded Plat \_\_\_\_\_  
5. Private Claims \_\_\_\_\_

	A	B	C	D	E	F	G	H	I	J	K	L	M
2	6	5	4	3	2	1							
3													
4	7	8	9	10	11	12							
5													
6	18	17	16	15	14	13							
7													
8	19	20	21	22	23	24							
9													
10	30	29	28	27	26	25							
11													
12	31	32	33	34	35	36							
13													

I, James J. Keller, in a field survey on July 27 19 98, do hereby certify that under requirements of P.A. 74, Michigan P.A. of 1970, the corner points mentioned in lines 1 and 2 above were in conformance with regulations and rules therefore as required in the current manual of survey instructions of the United States Department of the Interior, Bureau of Land Management or by a decree of a Court of Law and/or that the corner points mentioned in lines 3, 4 and 5 above were in conformance with the rules of the Michigan Board of Land Surveyors or by a Decree of a Court of Law; established, re-established, monumented, re-monumented, recovered, found as expressed below:

**NOTE: Not more than 2 corners, all in the same town and range, may be recorded on this certificate.**

A. Description of original monument and accessories and/or subsequent restoration:

March 1, 1838, Abner E. Van Ness, Deputy Surveyor GLO, "Set post Cor of Sect. 16, 17, 20, & 21."  
8" Beech S37-1/2°E 7 Links (4.62')  
8" Hemlock S5°W 38 Links (25.08').

December 13, 1926, Wm Fargo, CP Co. Dwg #F-5618, "Accepted RR iron & stone."  
10" Maple S26°W 75 Links (49.50')  
20" W. Oak N68-1/2°W 99-1/2 Links (65.67').

June 13, 1979, Norman L. Ochs, RLS #22439 (LCRC L1 F487) "Fnd 3/4" pipe."  
P. pole West 34.09'  
28" Maple S26°W 49.4'  
P. pole S58°E 54.26'  
10" R. Pine N43°E 47.34'

October 17, 1990, James J. Keller, RLS #10693 (FB 107-W P74) Fnd 3/4" pinch top IP 1.0' deep.  
Fnd 40d in P. pole MY-1-132 N87°W 34.05'  
Fnd 40d NW sd 16" Red Pine N44°E 47.38'  
Fnd 40d SW sd P. pole MY1-132-B S53°E 54.21'  
Fnd NE&S cap & 40d in 40" Maple S28°W 49.33'

B. Description of corner evidence found and/or method applied in restoring or reestablishing corner:

July 27, 1998, James J. Keller, RLS #10693 (FB 138-W P58) Fnd 3/4" Pinch top IP 14" deep.  
Fnd 40d S sd P. pole N86°W 34.05'  
Set 60d SE sd 14" Red pine N46°E 47.10'  
Fnd 40d SW sd P. pole S52°E 54.46'  
Fnd NE&S cap NW sd 38" Maple S31°W 49.40'

C. Description of monument for corner and accessories established to perpetuate locating the position of the corner:

Accepted rusty pinch top 3/4" pipe & set Remonumentation Monument over it as best evidence of the position of the original corner.  
Fnd 40d S sd P. pole & set PK nail & tag above N86°W 34.05'  
Fnd 60d & set tag SE sd 14" Red Pine N46°E 47.10'  
Fnd 40d SW sd P. pole & set PK nail & tag above S52°E 54.46'  
Fnd NE&S cap NW sd 38" Maple & set 60d & tag above S31°W 49.40'

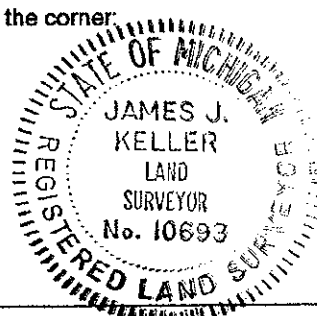

Signed by James J. Keller  
Surveyor's Michigan License No. 10693

Date August 20, 1998

FORM APPROVED BY MICHIGAN STATE BOARD OF LAND SURVEYORS, JAN. 28, 1971  
REVISED MAY 14, 1975  
REVISED JAN, 1983  
ADAPTED FOR WORD PROCESSING MARCH, 1993

APPROVED BY MECOSTA CO. PEER GROUP  
IN ACCORDANCE WITH P.A. 345 of 1990

James S. Knapp  
CHAIRMAN  
DATE Aug. 14, 1998

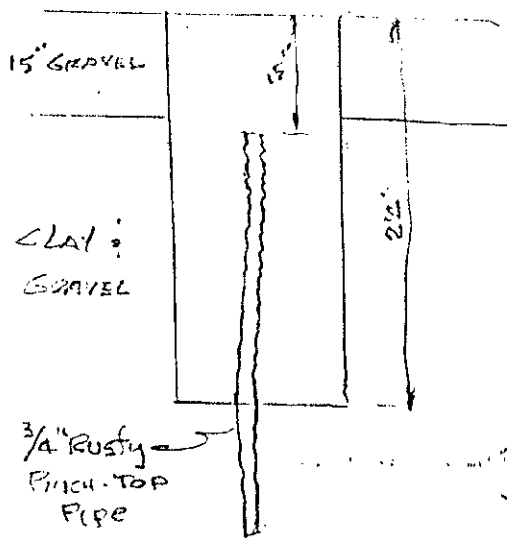

AS FOUND



SET REMON.  
MON OVER  
3/4 RUSTY PINCH  
TOP PIPE

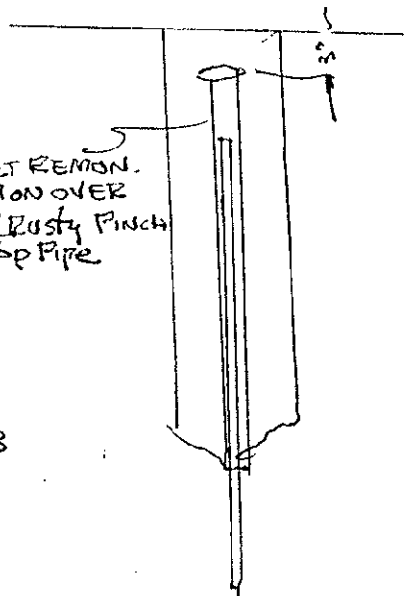

AS SET

AUG 18, 1998  
JJK JHN

SURVEY &  
REMONUMENTATION

OCT 29 1998

SECTION