

SUPPLEMENTAL
REMONUMENTATION

MECOSTA COUNTY REMONUMENTATION PROGRAM

CORNER APPROVED BY PEER GROUP ON SEPTEMBER 12, 1997

NOV 18 1997

LAND CORNER RECORDATION CERTIFICATE

Filing Requirement of Act 74, Mich. P.A. 1970

For corners in COMMUNITY

Mecosta
(County)

Located In:
Colfax Township

Corner Code #

STATE OF MICHIGAN
COUNTY OF MECOSTA
RECEIVED FOR RECORD

'97 NOV -7 P2:24

1. Public Land Survey	SEC 28 T 15N R 09W	F-11
	T R	
	T R	
	T R	
2. Property Controlling in Section	S T R	
	S T R	
3. Miscellaneous Property in Sec.	S T R	
	S T R	

James J. Keller
REGISTER OF DEEDS
Register of Deeds Stamp & File Number

4. Lot No. _____, Recorded Plat _____
5. Private Claims _____

I, James J. Keller, in a field survey on June 26, 1996, do hereby certify that under requirements of P.A. 74, Michigan P.A. of 1970, the corner points mentioned in lines 1 and 2 above were in conformance with regulations and rules therefore as required in the current manual of survey instructions of the United States Department of the Interior, Bureau of Land Management or by a decree of a Court of Law and/or that the corner points mentioned in lines 3, 4 and 5 above were in conformance with the rules of the Michigan Board of Land Surveyors or by a Decree of a Court of Law; established, re-established, monumented, re-monumented, recovered, found as expressed below:

NOTE: Not more than 4 corners, all in the same town and range, may be recorded on this certificate.

A. Description of original monument and accessories and/or subsequent restoration:

1st Quarter, 1839 Abner E. VanNess Deputy Surveyor GLO "Set 1/4 Sec. Post"
7" Ironwood S49°W 23 links = 15.18' 6" Ironwood N38°E 26 links = 17.16'

1895 Lyman W. June, County Surveyor
24" Pine stump N25°W 29 Links = 19.14' 24" pine stump N30°E 13 Links = 8.58'

November 25, 1908 George H. Willits, County Surveyor "Stake set 34.0' South of old Tile"

November 25, 1908 George H. Willits, Survey Bill "Stake set 34.0' South of old Tile"

January 6, 1989 John C. Bueche RLS #13027 (Survey L11 P284) "Iron"
Nail & tag East side 12" Maple N30°E 22.35' Nail & tag West side 6" Elm South 22.27'
Nail & tag South side twin 12" Oak N55°E 45.50' Iron set 0.8' South C/L Fence Post

March 24, 1989 John C. Bueche RLS #13027 (LCRC L2 P274) "Set Rerod by physical evidence 0.8' S of fence post on fences N - S & W & C/L 2 track East"
Nail & tag East side 12" Maple N30°E 22.35' Nail & tag West side 6" Elm South 22.27'
Nail & tag South side twin 12" Oak N55°E 45.50' 0.8' South of fence post on fence lines N - S & W

July 30, 1990 James J. Keller RLS #10693 "Found 1/2" Rebar and yellow cap 0.8' South C/L corner post"
Found nail & Alum tag SE side 12" Maple N33°E 22.33' Found nail & Alum tag E side 6" Locust S02°W 22.60'
Found nail & Alum tag SE side twin 12" White Oak N58°E 45.57' Set 30d in SE side 4" Locust S19°W 17.65'

B. Description of corner evidence found and/or method applied in restoring or reestablishing corner:

June 26, 1996 James J. Keller RLS #10693 "Found 1/2" Rebar and obliterated yellow cap"
Found nail & aluminum tag SE side 12" Maple N33°E 22.33'
Found nail & aluminum tag SE side twin 12" White Oak N58°E 45.57'
Found nail & aluminum tag East side 7" Locust S02°W 22.60'

APPROVED BY MECOSTA CO. PEER GROUP
IN ACCORDANCE WITH P.A. 345 of 1990

James J. Keller
CHAIRMAN
DATE SEPT. 12, 1997

C. Description of monument for corner and accessories established to perpetuate locating the position of the corner:

Accepted 1/2" rebar & set Remonumentation monument as a careful and faithful reestablishment of the position of the Original Corner.

Set PK nail & tag E side R.R. tie corner post N10°E 0.53'
Found Concrete nail & Kent Co. aluminum tag SE side 15" Maple stump N33°E 22.30'
Found Concrete nail & Kent Co. aluminum tag and set 60d & tag above SE side twin 12" Oak N60°E 45.48'
Set 60d & tag N side 12" Locust S70°W 32.58'
Set 60d & tag S side 4" Popple S82°E 55.62'

Signed by *James J. Keller* Date September 12, 1997

Surveyor's Michigan License No. 10693

FORM APPROVED BY MICHIGAN STATE BOARD OF LAND SURVEYORS, JAN 29, 1971
REVISED MAY 29, 1975

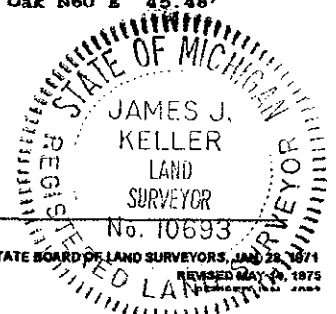

1150 file

JJK LJH

June 5, 1997

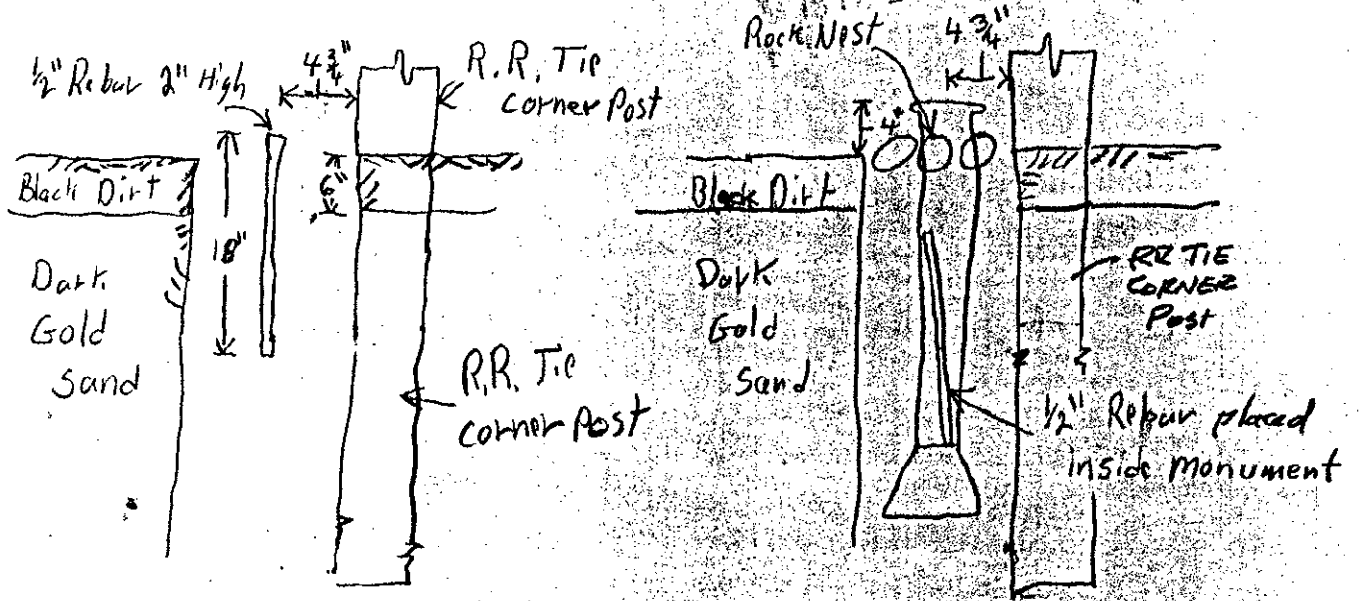

As Found

As Set

SURVEY &
REMONUMENTATION

NOV 18 1997

COMMISSION