

SURVEY & REMONUMENTATION MECOSTA COUNTY REMONUMENTATION PROGRAM

CORNER APPROVED BY PEER GROUP ON Nov 13, 1998

MAR 03 1999

LAND CORNER RECORDATION CERTIFICATE

Filing Requirement of Act 74, Mich. P.A. 1970

STATE OF MICHIGAN
COUNTY OF MECOSTA
RECEIVED FOR RECORD

For Corners in SECTION

Mecosta (County)	Located In:		Corner Code #
	T 15N	R 9W	I-06
	T	R	
	T	R	
1. Public Land Survey	T	R	
	S T	R	
	S T	R	
	S T	R	
	S T	R	

'98 DEC 28 A8:36

James Brown
REGISTER OF DEEDS

Register of Deeds Stamp & File Number

- 2. Property controlling in Section
- 3. Miscellaneous Property in Sec.

- 4. Lot No. _____, Recorded Plat _____
- 5. Private Claims _____

I, James H. Carter, in a field survey on Oct 26, 1998 do hereby certify that under requirements of P.A. 74, Michigan P.A. of 1970, the corner points mentioned in lines 1 and 2 above were in conformance with regulations and rules therefore as required in the current manual of survey instructions of the United States Department of the Interior, Bureau of Land Management or by a decree of court law and/or that the corner points mentioned in lines 3, 4 and 5 above were in conformance with the rules of Michigan Board of Land Surveyors or by a decree of a court of law, established, re-established, monumented, re-monumented, recovered, found as expressed below:

	A	B	C	D	E	F	G	H	I	J	K	L	M
1													
2	8		5		4		3		2		1		
3													
4	7		6		9		10		11		12		
5													
6	18		17		16		15		14		13		
7													
8	19		20		21		22		23		24		
9													
10	30		29		28		27		26		25		
11													
12	31		32		33		34		35		36		
13													

NOTE: Only one corner may be recorded on this certificate.

A. Description of original monument and accessories and for subsequent restoration:

- 1838 - JAN- FEB, DEPUTY SURVEYOR, A. E. VAN NESS, SET 1/4 POST. 10" HEMLOCK - N 33 1/2 W - 8 LINKS
18" HEMLOCK - S 50 W - 14 LINKS
- 1895 - L. W. JUNE - ORIGINAL B T STUMP
- 1905 L. W. JUNE - TILE CORNER.
- 1919 - J. C. HARRINGTON - STA 13 + 07.4 - S 8 3/4 E - 3" ELM - NO DISTANCE, N 85 E - 161.4' - 8" BIRCH

APPROVED BY MECOSTA CO. PEER GROUP
IN ACCORDANCE WITH P.A. 345 of 1990

James H. Kropp
CHAIRMAN
DATE Nov. 13, 1998

B. Description of corner evidence found and/or method applied in restoring or reestablishing corner:
JIM ZUERN, OPERATOR AND OWNER OF ZUERN'S CONSTRUCTION CO. USED A TRACTOR AND LOADER BUCKET AND DUG WITH GRADER BLADE TO A DEPTH THAT WENT INTO SUBSOIL BENEATH GRAVEL RD. COVERED ENTIRE INTERSECTION AND FOUND NO TRACE OF TILE SET BY JUNE. COMPUTED POSITION USING JUNE'S 1905 DEPENDENT RE-SURVEY FOR SECTION 15. IN PROCESS OF SETTING CORNER, FOUND TILE CHIPS AT A DEPTH OF ABOUT 2 FT., DUG DEEPER AND FOUND BOTTOM TILE SITTING VERTICAL AND FILLED WITH CINDERS. SET MECOSTA COUNTY REMONUMENTATION MONUMENT INSIDE OF TILE TO A DEPTH OF 1 FT BELOW SURFACE.

C. Description of monument for corner and accessories established to perpetuate locating the position of the corner:

- I-6 - CORNER COMMON TO SECTIONS 15 AND 14, T15N, R09W.
SET A STANDARD MECOSTA COUNTY REMONUMENTATION MONUMENT AND IS ACCEPTED AS A CAREFUL AND FAITHFUL RE-ESTABLISHMENT OF THE POSITION OF THE ORIGINAL CORNER.
- N 23 E - 70.20' - NAIL AND TAG IN POWER POLE.
- N 55 E - 37.79' - STEEL ROAD SIGN POST.
- S 71 E - 85.14' - NAIL AND TAG IN 18" POP.
- S 48 W - 18.10' - NAIL AND TAG IN 14" BIRCH.
- N 41 W - 48.24' - NAIL AND TAG IN CORNER FENCE POST.

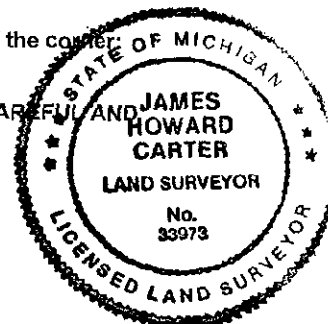

Signed by James H. Carter Date Nov 25, 1998
Surveyor's Michigan License No. 33973