

COMMISSION

LAND CORNER RECORDATION CERTIFICATE
Filing Requirement of Act 74, Mich. P.A. 1970

For corners in

REMONUMENTATION

Midland County Located In: Corner Code #

- 1. Public Land Survey T 14N R 1W G-6
2. Property Controlling in Section S T R
3. Miscellaneous Property in Sec. S T R

STATE OF MICHIGAN
MIDLAND COUNTY
REMONUMENTATION & FILED

30 NOV 93 3:07 P.M.

BEVERLY J THAYER
REGISTER OF DEEDS

Register of Deeds Stamp & File Number

- 4. Lot No. Recorded Plat
5. Private Claims

Grid with columns A-L and rows 2-13. A black dot is located at the intersection of column F and row 6.

I, Norman C. Caldwell, in a field survey on May 19 93, do hereby certify that under requirements of P.A. 74, Michigan P.A. of 1970, the corner points mentioned in lines 1 and 2 above were in conformance with regulations and rules therefore as required in the current manual of survey instructions of the United States Department of the Interior, Bureau of Land Management or by a decree of a Court of Law and/or that the corner points mentioned in lines 3, 4 and 5 above were in conformance with the rules of the Michigan Board of Land Surveyors or by a Decree of a Court of Law; established, re-established, monumented, re-monumented, recovered, found as expressed below:

NOTE: Not more than 4 corners, all in the same town and range, may be recorded on this certificate.

A. Description of original monument and accessories and/or subsequent restoration:

(G-6) 1/4 Cor, Sec. 15 & 16, T14N-R1W

Post Placed by Austin Burt in 1852 Subd Resurvey N54°E 21 L.(13.86') White Pine S39°W 5 L.(3.3') White Pine

Survey by Hunter, 1944, Found 1" Sq. Iron bar-8" Below Surface, in line w/Fnc to West: West 37.4' Face P. Pole; S45°E 63.5' cl 18" Poplar. (From Ayres Record M.U.H. Book 3 P.29)

Survey by D. Whittier, 1968, Set 1/2" Pipe (From Ayres Record)

Survey by Jerome Schafer, Book 2, pg. 305

B. Description of corner evidence found and/or method applied in restoring or reestablishing corner:

(G-6) 1/4 Cor, Sec. 15 & 16, T14N-R1W

Found 3/4" Pipe in Mon. Box per Ayres Record. (M.U.H. Box 3, pg. 29) and Jerome Schafer, Book 2, pg. 305

G-6 Approved by Midland County Peer Group October 27, 1993.

C. Description of monument for corner and accessories established to perpetuate locating the position of the corner:

(G-6) 1/4 Cor, Sec. 15 & 16, T14N-R1W

Found 3/4" Pipe in Mon. Box per Ayres Record (M.U.H. Book 3, pg. 29) (Whittier Survey) and is accepted as the best available evidence of the position of the original corner.

- S86°W 37.83' Power Pole(R)
S83°E 33.03' Rod w/cap
N48°E 64.31' 10" Ash
S52°E 58.21' 10" Twin Oak

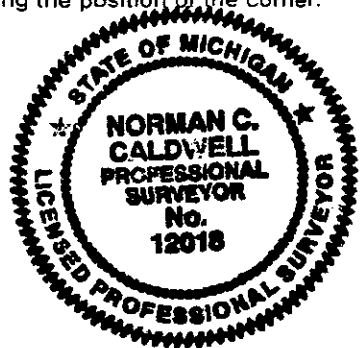

Signed by [Signature]

Date 29 NOV 93

Surveyor's Michigan License No. 12018