

REMONUMENTATION

MAY 20 1997

COMMISSION

RECORDED

96 DEC 13 PM 3: 14

LAND CORNER RECORDATION CERTIFICATE
Filing Requirement of Act 74, Mich. P.A., 1970

For corners in

Table with columns: Monroee (County), Located In: Dundee Twp., Corner Code # E-8. Rows include Public Land Survey, Property Controlling in Section, and Miscellaneous Property in Sec.

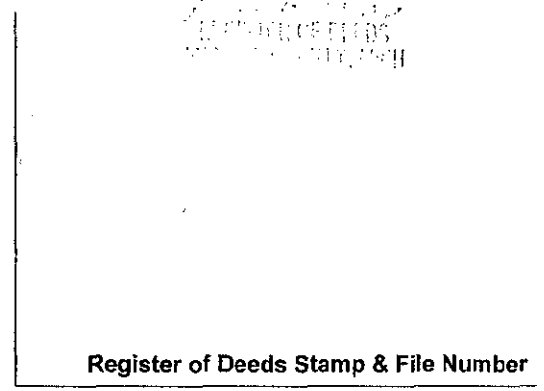

4. Lot No. , Recorded Plat

5. Private Claims

I, Bruce Antcliff, in a field survey on August, 1996 do hereby state that under requirements of P.A. 74, Michigan P.A. of 1970, the corner points mentioned in lines 1 and 2 above were in conformance with regulations and rules...

NOTE: Not more than 2 corners, all in the same town and range, may be recorded on this certificate.

Monroe County Road Commission Corner

Grid table with columns A-L and rows 1-13. A dot is marked at the intersection of column E and row 8.

A. Description of original monument and accessories and/or subsequent restoration:

Quarter corner common to Sections 20 & 21, T6S, R7E / Meanwell Road, Asphalt over stone. 1819, GLO Surveyor Fletcher set wood post; BO 12', S87E, 1.07; Do 10", N21W, 1.54. MCRC witness card indicates a 3/4" iron pipe set by MSHD. 1965, A.J. Marino, found iron; East, 24.4', P. nail in tel pole; NW, 94.2', P. nail in power pole; SW, 34.1', steel corner post. 1971, Norman Fahrner, found 3/4" iron pipe; LCRC L1, P5 1987, MCRC field notes, fnd, iron pipe; N37E, 65.92', PK/shiner SE root 56" oak; East, 38.41', PK/shiner S side 24" oak; S43E, 85.19', PK/shiner S side 24" oak; S15W, 90.12', PK/shiner E side 42" oak. 1990, J.C. Andrus survey, found iron rod; West 32.96', iron rod; East 38.96', Nail/shiner S face 32" oak; SW, 90.19', Nail/shiner E side 42" oak. 1992, G.B. Warnke, found 3/4" I.P., raised with 1/2" I.P.; LCRC L3, P285. 1994, J.C. Andrus, found pipe; same witnesses as LCRC L3, P285 1995, David Arthur Consultants, found 3/4" I.P.; East, 37.19', PK nail W face 30" oak; N35E, 64.46', PK nail W face 37" oak; N30E, 111.49', PK nail S' face power pole; N20W, 147.02', PK nail S face power pole.

B. Description of corner evidence found and/or method applied in restoring or re-establishing corner:

Found 1/2" x 13" pipe. At 24" depth, found 3/4" I.P., 0.09' east of 1/2" pipe. Also found boat spike 0.06' west and 0.10' south of 1/2" pipe. Excavated to depth of 36", found no other evidence.

C. Description of monument for corner and accessories established to perpetuate locating the position of the corner:

Set 1" x 36" iron pipe with brass remonumentation cap inside monument box in place of 1/2" pipe and is accepted as the best evidence of the position of the original corner.

Witnesses: N32E, 65.76', PK/shiner E root 48" oak S85E, 38.76', 60d nail S root 24" oak S37E, 122.19', NW corner of block foundation of house S50W, 51.24', duplex nail in E face of AT&T pole N78W, 117.08', SE corner of block foundation of garage

RATIFIED BY PEER GROUP PA 345 OF 1990 MONROE COUNTY, MICHIGAN

date: 8/27/1996 County Rep.: [Signature]

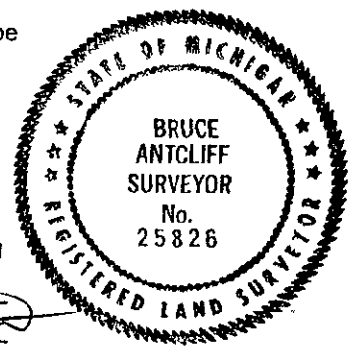

Signed by Bruce Antcliff

Date 11-13-96

Surveyor's Michigan License No. 25826