

SURVEY & REMONUMENTATION

FEB 13 1998

SECTION

LAND CORNER RECORDATION CERTIFICATE
Filing Requirement of Act 74, Mich. P.A. 1970

For corners in
MONROE (58)
(County)

Located in: _____ Corner Code # _____

1. Public Land Survey T ___ R ___
T ___ R ___
WHITEFORD TWP. T8S R 6E G-5
T ___ R ___

2. Property Controlling S ___ T ___ R ___
in Section S ___ T ___ R ___

3. Miscellaneous S ___ T ___ R ___
Property in Sec. S ___ T ___ R ___

RECEIVED FOR RECORD
97 DEC 30 PM 3:05
Howie Allen
REGISTER OF DEEDS
MONROE COUNTY, MICH

Register of Deeds Stamp & File Number

4. Lot No. _____, Recorded Plat _____
5. Private Claims _____

G.B. WARNKE, JR., in a field survey on May 1997, 19__ do hereby state that under requirements of P.A. 74, Michigan P.A. of 1970, the corner points mentioned in lines 1 and 2 above were in conformance with regulations and rules therefore as required in the current manual of survey instructions of the United States Department of the Interior, Bureau of Land Management or by a decree of a Court of Law and for that the corner points mentioned in lines 3, 4 and 5 above were in conformance with the rules of the Michigan Board of Land Surveyors or by a Decree of a Court of Law; established, re-established, monumented, recovered, found as expressed below:

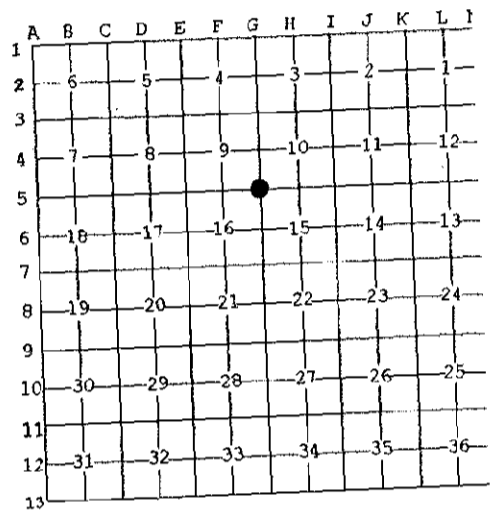

NOTE: Not more than 2 corners, all in the same town and range, may be recorded on this certificate.

1997 G.B. WARNKE PRIVATE CORNER
Section Corner to Sections 9, 10, 15 & 16
On Sylvania-Petersburg Road being hard surface

- A. Description of original monument and accessories and/or subsequent restoration:
- 1821 GLO Surveyor, Joseph Wampler, set post corner of Sec. 9, 10, 15 & 16 from which a W. Oak 12 in. dia. bears S70W 15 lks. dis. & a Hickory 10 in. dia. bears S81E 36 lks. dis.
 - 1965 Jesse M. Carlson, Gov't Monument Witnesses Record card, notes "3/4" pipe 2' long from original witnesses as of 30 Jan 1958 - witnesses: N89°W 27.67' fence post & N89°E 41.75' 28" Elm & S37°E 40.45' power pole
 - 1972 Kenneth Suydam recorded LCRC, Liber 1, Page 231, shows "found 3/4" iron pipe about 4" below surface of black top pavement. Raised to surface with 60 pen. spike - witnesses: Nail & shiner in Elec. Pole N85°W 61.60' & Nail & shiner in 20" W. Oak N65°E 25.85' & Iron Pipe East 32.80' & Nail & shiner in Elec. Pole S30°E 42.98'

Section A continued on reverse side

B. Description of corner evidence found and/or method applied in restoring or reestablishing corner:

5/1997 - Warnke crew replaced found nail over 3/4" x 14" pipe 6" deep with a 1" x 36" pipe in monument box and witnesses as shown below. Crew dug a 22" diameter x 24" depth hole and probed in all directions with nothing further found. Road is 1" tar chip over 9" large stone mix over clay.

RATIFIED BY PEER GROUP, P.A. 345 OF 1990, MONROE COUNTY, MICHIGAN, DATE 7/22/1997, COUNTY REP. *[Signature]*

10/9/1997, G.B. Warnke crew placed 3" riser on previously set monument box that had been paved over. Set brass remonumentation cap on previously set 1" x 36" pipe.

C. Description of monument for corner and accessories established to perpetuate locating the position of the corner:

Set 1" x 36" pipe with brass remonumentation cap in monument box with a 3 inch riser to replace found nail over 3/4" x 14" pipe and is accepted as the best available evidence of the position of the original corner.
Witnesses: North 87° West 61.56 feet to found 60p nail in east side of pole
South 40° West 49.45 feet to nail/shiner in north side of pole
South 40° East 46.48 feet to nail/shiner in northeast side of pole
East 33.00 feet to found pipe #19474
West 32.97 feet to found pipe #19474

Signed by *[Signature]*
Surveyor's Michigan License No. 19474

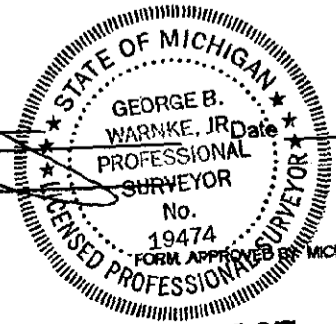

12/8/1997

Section A continued from reverse side

- 1972 Kenneth Suydam with Walter E. Frazier & Associates, survey, Job #7211260, recorded in Liber 636, Page 291, notes appears to be same information as used in LCRC.
- 1973 Kenneth Suydam with Walter E. Frazier & Associates, survey, Job #7307189, recorded in Liber 702, Page 478, notes "SW COR. SEC. 10, T8S, R6E, - witnesses:
25.85' N65°E shiner in 20" Oak
42.98 S30°E shiner in Elec. Pole
61.60' N85°W shiner in Elec. Pole
- 1974 Douglas W. Hooth recorded LCRC, Liber 1, Pages 500-501, which notes "found large spike in bit. surface of Syl-Petersburg Rd. from MDSH Plans 58021, Job #00783C, N-89-E 41.75' 28" Elm Good lines East & West - witnesses: N-89-E 41.75' 29" Elm & N-60E 26.44' 23" Oak & S-30-E 46.49' Power Pole
- 1976 Kenneth Suydam with Walter E. Frazier & Associates, surveys, Job #7602020, recorded in Liber 702, Pages 480 & 482, notes same information as used in 1973.
- 1991 George B. Warnke, Jr. surveys (#91-120), recorded in Liber 1343, Pages 477-478, & LCRC, Liber 3, Page 165, - 1992 shows "found nail over I. pipe" - witnesses:
North 87° West 61.56' fnd 60p nail E/S pole & South 40° West 49.45' shiner N/S pole &
South 40° East 46.48' shiner NE/S pole & East 40.68' form nail S/S 36" Oak
- 1993 James C. Andrus survey (#93s6901), recorded in Liber 1317, Page 0415 & Liber 1317, Page 0233, notes "NE COR. NE 1/4 SEC. 16, FOUND IRON PIN - Witnesses: N85°W 61.6' to nail in telephone pole & S35°E 46.45' to nail in power pole & N45°E 25.80' to nail in 36" Oak
- 1995 Monroe County Road Commission field notes show "fnd 60d nail - CL pavement on Sec. line".

**SURVEY &
REMONUMENTATION**

FEB 13 1998

SECTION