

MAY 20 1997

COMMISSION

RECEIVED FOR FILING

96 DEC 13 PM 3:20

LAND CORNER RECORDATION CERTIFICATE
Filing Requirement of Act 74, Mich. P.A., 1970

For corners in

Table with columns: Monroe (County), Located In: Whiteford Twp., Corner Code #. Rows include Public Land Survey, Property Controlling in Section, and Miscellaneous Property in Sec.

Handwritten signature and stamp: BRUCE ANTCLIFF, REGISTERED LAND SURVEYOR, No. 25826

Register of Deeds Stamp & File Number

4. Lot No. , Recorded Plat

5. Private Claims

I, Bruce Antcliff, in a field survey on August 19 96 do hereby state that under requirements of P.A. 74, Michigan P.A. of 1970, the corner points mentioned in lines 1 and 2 above were in conformance with regulations and rules therefore as required in the current manual of survey instructions of the United States Department of the Interior, Bureau of Land Management or by decree of a Court of Law and / or that the corner points mentioned in lines 3, 4 and 5 above were in conformance with the rules of the Michigan Board of Land Surveyors or by a Decree of a Court of Law; established, re-established, monumented, recovered, found as expressed below:

NOTE: Not more than 2 corners, all in the same town and range, may be recorded on this certificate.

Monroe County Road Commission Corner

A. Description of original monument and accessories and/or subsequent restoration:

Section corner common to sections 26, 27, 34 & 35 T8S,R6E, Whiteford township / Jeffs & Sterns Road, Asphalt over stone 1820, GLO Surveyor Wampler set wood post; Elm, 14", is the corner tree 1956, MDOT Project #58034, sheet 10, witnesses to NE corner (monument not described) : N41E, 45.22', tel. pole; S79E, 52.98', USGS BM; S15W, 10.85', end g.r. post; N10W, 20.33', end g.r. post 1972, M. Freels, L629, P905; Set RR spike per MSHD witnesses 1974, M. Freels, Section sheet, same witnesses as MSHD above. 1973, Associated Eng. & Surv., witness sheet; Set PK from previous witnesses; NE bridge rail support, N25W, 18.86'; Nail/disc in P. pole, N60W, 84.49' 1978, Marino Survey, Fnd. RR spike Date unknown, G.B. Warnke, found RR spike; fnd nail/shiner 0.32' North; S70E, nail/shiner NE face p. pole, 5.62'; S10W, 13.30', NE corner SE conc. bridge wingwall; N10W, 23.09', SE corner NE conc. bridge wingwall.

B. Description of corner evidence found and/or method applied in restoring or re-establishing corner:

Found RR spike 0.2' deep. Due to proximity with existing bridge, all evidence of original corner would have been lost during bridge construction. Therefore, no excavation was done.

C. Description of monument for corner and accessories established to perpetuate locating the position of the corner:

Set 1"x36" iron pipe with brass remonumentation cap inside monument box to replace R.R.Spike and is accepted as the best available evidence of the position of the original corner.

Witnesses: S37W, 13.32', Chiseled "+" in S wingwall on W side Jeffs Road S7E, 116.83', Mag nail/MCRC tag in E face power pole S55E, 55.66', Nail/Sunoco tag in NE face of guy pole N80E, 127.88', Mag nail/MCRC tag in S face guy pole N45E, 124.69', SW corner of porch, Hse. #5890

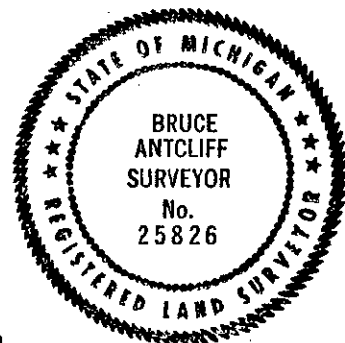

RATIFIED BY PEER GROUP PA 345 OF 1990 MONROE COUNTY, MICHIGAN date: 9/24/1996 County Rep.:

Signed by Bruce Antcliff

Date 11-13-96

Surveyor's Michigan License No. 25826