

MONTCALM COUNTY REMONUMENTATION PROGRAM

SECTION

LAND CORNER RECORDATION CERTIFICATE

Filing Requirement of Act 74, Mich. P.A. 1970

For corners in

Montcalm (County)	Located in: Bloomer Township	Corner Code # I-03
1. Public Land Survey	Sec 2, 3, T 9N R 5W 10, & 11 T R	
2. Property Controlling in Section	S T R S T R	
3. Miscellaneous Property in Sec.	S T R S T R	

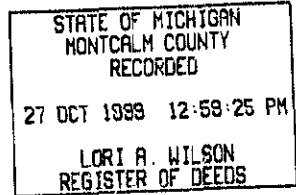

Register of Deeds Stamp & File Number

4. Lot No. \_\_\_\_\_, Recorded Plat \_\_\_\_\_  
5. Private Claims \_\_\_\_\_

A	B	C	D	E	F	G	H	I	J	K	L	M
2	6	5	4	3	2	1						
3												
4	7	8	9	10	11	12						
5												
6	18	17	16	15	14	13						
7												
8	19	20	21	22	23	24						
9												
10	30	29	28	27	26	25						
11												
12	31	32	33	34	35	36						
13												

I, William G. Tingley a field surveyor on June 18, 1999, do hereby certify that under requirements of P.A. 74, Michigan P.A. of 1970, the corner points mentioned in lines 1 and 2 above were in conformance with regulations and rules therefore as required in the current manual of survey instructions of the United States Department of the Interior, Bureau of Land Management or by a decree of a Court of Law and/or that the corner points mentioned in lines 3, 4 and 5 above were in conformance with the rules of the Michigan Board of Land Surveyors or by a Decree of a Court of Law; established, re-established, monumented, re-monumented, recovered, found as expressed below:

NOTE: Not more than 2 corners, all in the same town and range, may be recorded on this certificate.

A. Description of original monument and accessories and/or subsequent restoration:

September 1831, Orange Risdon, Deputy Surveyor, GLO Notes

Set Post Corner to Sections 2, 3, 10 and 11

Beech 24" S52°W 5 links

Beech 9" N52°E 54 links

1873, F.A. Palmer, Deputy Surveyor for Montcalm County, Liber 1, Page 13, Record of Minutes of Survey

Failed to find the Southeast Corner of Section 3. Ran South to the quarter post 40.00. Found a stone set in middle of the road.

Then ran from the 1/4 post on South side of Section 3 to the same on South side of Section 2. I established a new Section

Corner. Made New Bearing Tree.

Sugar 12" S59°E 31 links

R.D. McNutt, County Surveyor, Index card file

Have same bearing trees as 1831 and 1873

June 1968, William Downey, Surveyor, Michigan State Highway Department

Found stone and crockery

Replaced stone with 3/4" pipe in drain tile, placed broken crockery and stones around pipe

32" Elm Stump N50°W 48.14 feet

23" Elm Stump N23°E 76.75 feet

7" Oak N84°E 30.67 feet

Corner is 2643.49 feet from 1/4 Corner 10 and 11

1968, Salisbury & Saunders in Consumers Power Survey

Found 3/4" pipe

6" White Oak N85°E 30.7 feet

40" Stump N55°W 48.2 feet

36" Stump N30°E 76.7 feet

(Continued on Back. . .)

ACCEPTED BY THE MONTCALM COUNTY SURVEY PEER GROUP AS THE OFFICIAL CORNER UNDER MICHIGAN PUBLIC ACT 345 OF 1990 AT A MEETING HELD 7-28-99

WGT  
William Tingley, PS, Chairman

B. Description of corner evidence found and/or method applied in restoring or reestablishing corner:

Found 3/4" bent iron pipe with nail directly over the bend 1.18 feet below surface of pavement, at 1.5 feet below surface of pavement

found 6" clay tile surrounding 3/4" iron pipe filled with stones and crockery.

Found center of 30" Oak S84°E 46.76 feet

Found center of 12" Oak S88°E 44.90 feet

Found center of Power Pole S35°W 105.28 feet

C. Description of monument for corner and accessories established to perpetuate locating the position of the corner:

Set Remonumentation monument in place of 3/4" pipe inside 6" clay tile.

Set nail and tag NE side of Power Pole N05°W 193.32 feet

Set nail and tag South side 30" Oak S84°E 46.66 feet

Set nail and tag SW side of Power Pole S08°E 104.54 feet

Set nail and tag SE side of Power Pole S35°W 105.37 feet

This corner is accepted as a careful and faithful reestablishment of the position of the original corner.

Signed by William Tingley Date 7-28, 1999  
Surveyor's Michigan License No. 30104

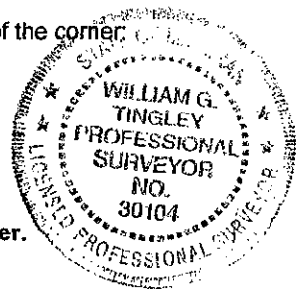

**SURVEY &  
REMONUMENTATION**

REC'D 1988

**SECTION**

Continued from Section A. (I-3, T09N – R05W)

Montcalm County Road Commission records

Same as Salisbury 1968

1977, D.B. Whittier #10070, Survey, Liber 505, page 154

Found 3/4" Pipe

1987, R.J. Crater #16924, file records

Found 3/4" pipe from Downey's witnesses

24" Oak            N85°E            47.00 feet

10" Oak            N85°E            45.00 feet

September 1989, Montcalm County Road Commission records

3/4" Pipe

Power Pole            S30°W            104.65 feet

12" Oak            N85°E            30.07 feet

36" Stump            N40°E            75.60 feet

1990, W.G. Tingley #30104, LCRC, Liber 2, Page 329

Found 3/4" Pipe bent over at top, straightened

Power Pole            S30°W            104.65 feet

12" Oak            N85°E            30.07 feet

36" Stump            N40°E            75.60 feet



FD 148 26