

**LAND CORNER RECORDATION CERTIFICATE**  
**Filing Requirement of Act 74, Mich. P.A. 1970**

For corners in  
  MONTCALM  

(County)

Located In:

Corner Code   E-12  

- |                                       |   |                 |
|---------------------------------------|---|-----------------|
| 1. Public Land Survey                 | T <u>  9N  </u> R <u>  8W  </u>                 | <u>  E-12  </u> |
|                                       | T <u>      </u> R <u>      </u>                 | <u>      </u>   |
|                                       | T <u>      </u> R <u>      </u>                 | <u>      </u>   |
|                                       | T <u>      </u> R <u>      </u>                 | <u>      </u>   |
| 2. Property Controlling<br>in Section | S <u>      </u> T <u>      </u> R <u>      </u> | <u>      </u>   |
|                                       | S <u>      </u> T <u>      </u> R <u>      </u> | <u>      </u>   |
| 3. Miscellaneous<br>Property in Sec.  | S <u>      </u> T <u>      </u> R <u>      </u> | <u>      </u>   |
|                                       | S <u>      </u> T <u>      </u> R <u>      </u> | <u>      </u>   |

Register of Deeds Stamp & File Number

4. Lot No. \_\_\_\_\_, Recorded Plat \_\_\_\_\_
5. Private Claims \_\_\_\_\_

	A	B	C	D	E	F	G	H	I	J	K	L	M
2	6		5		4		3		2		1		
3													
4	7		8		9		10		11		12		
5													
6	18		17		16		15		14		13		
7													
8	19		20		21		22		23		24		
9													
10	30		29		28		27		26		25		
11													
12	31		32		33		34		35		36		
13													

I,   GARY C. BILOW  , in a field survey on   AUGUST 3  , 19   90  , do hereby certify that under requirements of P.A. 74, Michigan P.A. of 1970, the corner points mentioned in lines 1 and 2 above were in conformance with regulations and rules therefore as required in the current manual of survey instructions of the United States Department of the Interior, Bureau of Land Management or by a decree of a Court of Law and/or that the corner points mentioned in lines 3, 4 and 5 above were in conformance with the rules of the Michigan Board of Land Surveyors or by a Decree of a Court of Law; established, re-established, monumented, re-monumented, recovered, found as expressed below:

**NOTE: Not more than 4 corners, all in the same town and range, may be recorded on this certificate.**

**A. Description of original monument and accessories and/or subsequent restoration:**

CORNER POST ESTABLISHED BY U.S. GOVERNMENT DEPUTY SURVEYOR N. BROOKFIELD, 1837. ACCESSORIES: Y. OAK 12 N02W J, DO 18 S61W 96. CORNER RECORDED UNDER ACT 74, P.A. 1970 BY RICHARD J. CRATER, R.L.S. #16924 AS "SET IRON ON FENCE LINES SOUTH IN LINE WITH FENCE LINE WEST...". SEE LCRC REC. LIBER 2, PAGE 177. CRATER'S ACCESSORIES ARE: 24° OAK, SOUTH, 13.45'; 30° OAK, S10E, 19.85'; 24° TWIN OAK, WEST, 19.25'.

**B. Description of corner evidence found and/or method applied in restoring or reestablishing corner:**

FOUND NO EVIDENCE OF ORIGINAL POST OR ACCESSORIES. FOUND AND ACCEPTED 1/2" DIAMETER REINFORCING ROD AT THE INTERSECTION OF EASTERLY PROLONGATION OF OLD FENCE LINE TO WEST AND NORTHERLY PROLONGATION OF OLD FENCE LINE TO SOUTH. CRATER'S RECORD ACCESSORIES CHECK. THIS CORNER IS BEING RE-RECORDED IN ORDER TO UPDATE THE ACCESSORIES.

**C. Description of monument for corner and accessories established to perpetuate locating the position of the corner:**

FOUND 1/2" DIAMETER RE-ROD

- S03W 13.27' SET SPIKE AND MICHIGAN DEPARTMENT OF NATURAL RESOURCES TAG IN 24° OAK
- S17E 19.91' SET SPIKE AND MDNR TAG IN 30° OAK
- S89W 19.11' SET SPIKE AND MDNR TAG IN 24° TWIN OAK
- S50E 59.90' SET SPIKE AND MDNR TAG IN 12° OAK

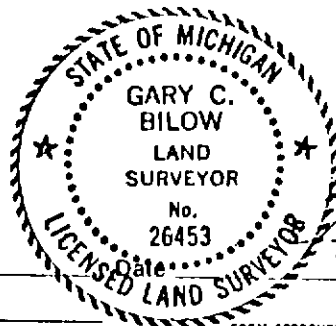

Signed by   Gary C. BiLow    
 Surveyor's Michigan License No.   26453